

THE BOARD OF SUPERVISORS OF THE COUNTY OF STANISLAUS
BOARD ACTION SUMMARY

DEPT: Chief Executive Office

BOARD AGENDA #: *B-8

AGENDA DATE: September 19, 2017

SUBJECT:

Approval to Proceed Within the Previously Approved Budget, the Completion of the Exterior Landscaping Improvements for the Public Safety Center Expansion Projects

BOARD ACTION AS FOLLOWS:

No. 2017-496

On motion of Supervisor Withrow, Seconded by Supervisor Monteith
and approved by the following vote,

Ayes: Supervisors: Olsen, Withrow, Monteith, DeMartini, and Chairman Chiesa

Noes: Supervisors: None

Excused or Absent: Supervisors: None

Abstaining: Supervisor: None

1) Approved as recommended

2) Denied

3) Approved as amended

4) Other:

MOTION:



ATTEST: PAM VILLARREAL, Assistant Clerk

File No.

**THE BOARD OF SUPERVISORS OF THE COUNTY OF STANISLAUS
AGENDA ITEM**

DEPT: Chief Executive Office BOARD AGENDA #: *B-8
Urgent Routine AGENDA DATE: September 19, 2017
CEO CONCURRENCE: *pht* 4/5 Vote Required: Yes No

SUBJECT:

Approval to Proceed Within the Previously Approved Budget, the Completion of the Exterior Landscaping Improvements for the Public Safety Center Expansion Projects

STAFF RECOMMENDATIONS:

1. Approval to proceed within the previously approved budget the completion of the exterior landscaping improvements for the Public Safety Center Expansion projects.
2. Authorize the Project Manager to issue a Notice Inviting Bids for informal construction for the Project and authorize the Project Manager to award the construction so long as it is within the approved budget.

DISCUSSION:

On June 17, 2014, the Board of Supervisors approved proceeding with the construction of the two major Public Safety Center Expansion projects which includes Project One: Maximum Security Housing and Medical Mental Health; and Project Three: Intake, Release and Transportation. Earlier the Board had authorized the construction of Project Two: The Day Reporting Center. Projects One and Two were funded primarily by the State of California (90% State, 10% County). Project Three was funded by County Public Facility Fees. While all three projects were completed successfully, on time and under budget, some final completion work was planned to complete this portion of the Public Safety Center campus improvements.

One of the final design elements for the overall project is to complete the Public Safety Center campus exterior landscape improvements. This is a county responsibility and was planned as part of the Project Three funding strategy, using public facility fee funds already authorized as a part of the approved project budget.

This work will complete the landscaping and site improvements in front of Project Three which is the new entrance for all of Sheriff's Custody operations. The area remained dirt while the priority of completing these complex and significant jail construction projects. In anticipation of a follow-up project, the flag poles planned as a part of Project Three were not installed at that time.

Approval to Proceed Within the Previously Approved Budget, the Completion of the Exterior Landscaping Improvements for the Public Safety Center Expansion Projects

Sheriff Christianson requested that the exterior landscaping and flag pole installation project center around the concept of a memorial garden that would include not only the United States and State of California Flags, but contain the five flags representing the United States Armed Forces (Army, Navy, Air Force, Coast Guard, Marines) as a fitting tribute to the men and women in Stanislaus County and in our nation who have served our Country with distinction and bravery.

A simplified landscaping plan is being recommended that is reflective of an appropriate front area landscaping effort which would include native grasses, trees, decomposed granite and this memorial/flag area. This landscaping plan is sensitive to water tolerant plantings and minimal ongoing maintenance to complete the front area of this project.

An additional project originally contemplated is being planned for parking lot and roadway improvements needed to complete this area of the Public Safety Center. This project will be presented in the future for Board of Supervisors consideration.

The Chief Operations Officer has hired KLA Landscape Architecture and Planning, Inc. (KLA) to develop site improvement plans and the project estimate. The proposed memorial garden will be built to the west of Project Three and will include a seating area for remembrance, seven lighted flag poles honoring the American Flag, State of California Flag and the five Military Branches. In addition to the memorial garden site improvements there will be landscaping and irrigation upgrades adjacent to Project Three. These site improvements will complete the immediate site improvements for the Center. One additional project is currently being planned to replace and update the parking lot and roadway improvements needed to complete the entire campus upgrade.

Completing this site and landscaping plan during the construction of the facilities was examined but resulted in a higher cost estimate to do the work with the General Contractor. It is recommended that the Informal Bid process (projects less than \$175,000) be used and the team will seek bids from local and interested landscaping contractors to minimize the cost of this completion effort.

POLICY ISSUE:

Board of Supervisors approval is required for all contracts in excess of \$100,000.

FISCAL IMPACT:

Funding for this project is included in the previously approved Public Safety Center Campus Project Three (Intake, Release and Transportation) budget. Construction of the facility was completed on time and under budget. As of September 12, 2017, the project had \$1,711,688 remaining in the approved budget. The estimated Project Cost for this work is estimated below \$250,000.

BOARD OF SUPERVISORS' PRIORITY:

Board of Supervisors approval is required on all contracts whose value exceeds \$100,000.

Approval to Proceed Within the Previously Approved Budget, the Completion of the Exterior Landscaping Improvements for the Public Safety Center Expansion Projects

STAFFING IMPACT:

There is no staffing impact associated with this action. Successful delivery of the project will be provided by the Chief Operations Officer and existing Capital Projects staff working with Sheriff Christianson and his team.

CONTACT PERSON:

Patricia Hill Thomas, Chief Operations Officer/Project Manager, Telephone (209) 525-6333.

ATTACHMENT(S):

1. Site Plan

ATTACHMENT 1

(Site Plan)

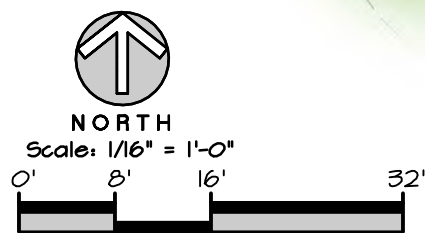
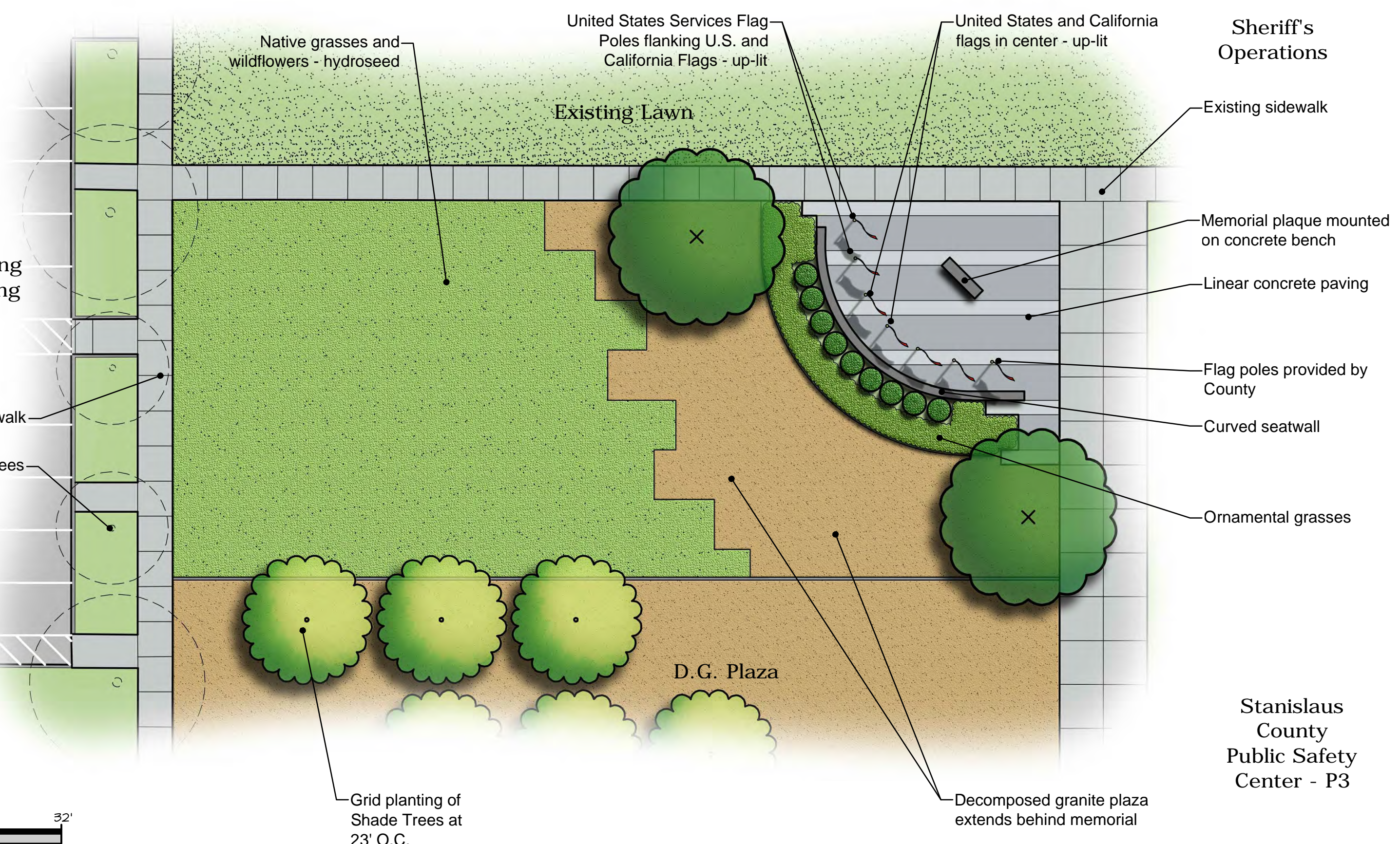

Sheet Size: 11x17
 September 8, 2017
 12-1490



Town Square Memorial Plaza
Stanislaus County Public Safety Center, Modesto CA

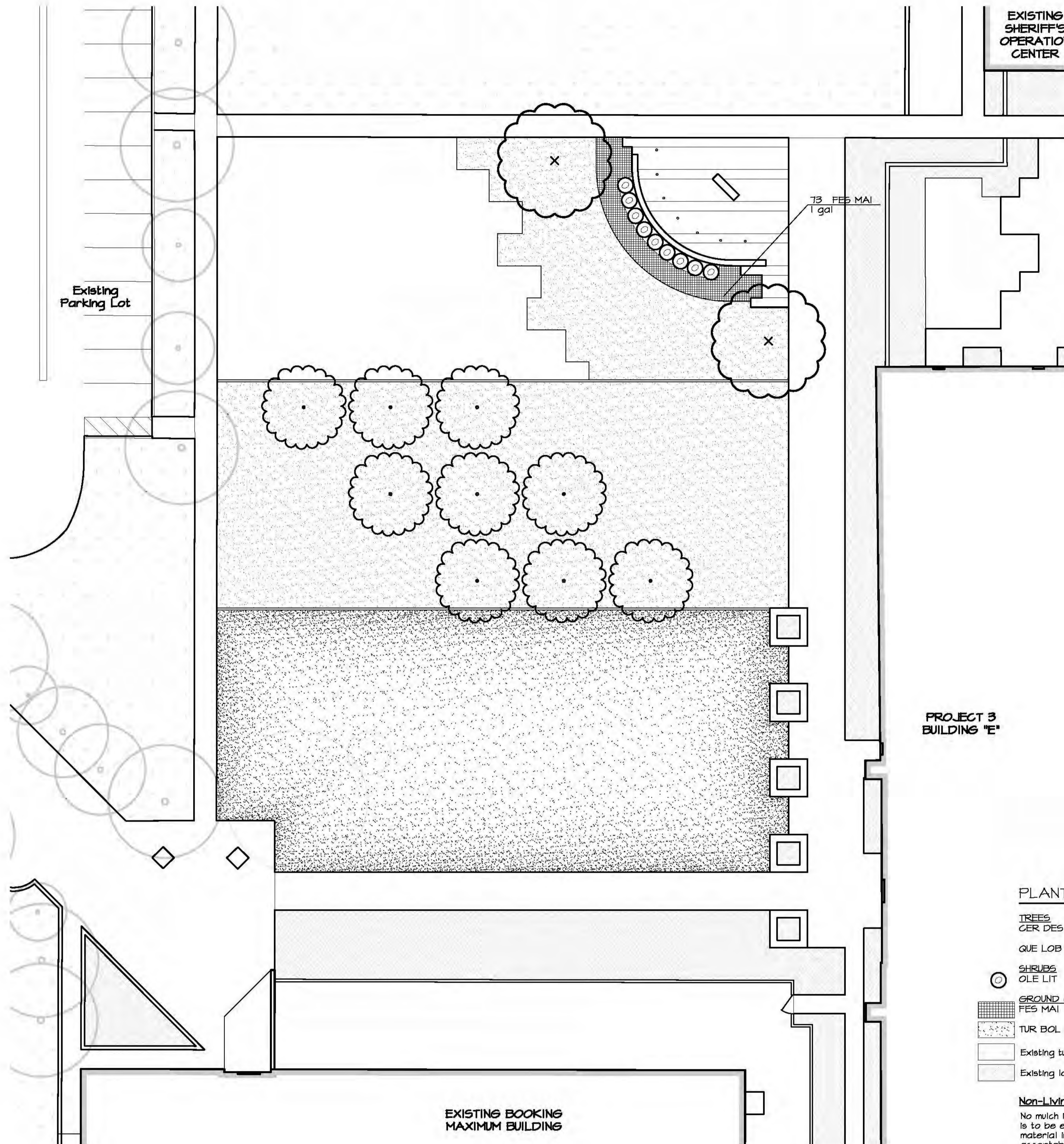

EXISTING
SHERIFF'S
OPERATIO
CENTER

Existing
Parking Lot

PROJECT 3
BUILDING "E"

EXISTING BOOKING
MAXIMUM BUILDING

GENERAL PLANTING NOTES

- The contractor shall examine the conditions of the site prior to commencement of work. Any conditions that differ from what is shown on the plans that will affect the installation process shall be brought to the attention of the County Inspector or Land Arch. prior to work. Commencement of work implies acceptance of the conditions of the site.
- The contractor shall verify all plant quantities prior to installation. Plant quantities are listed for the convenience of the contractor, number of symbols shall have priority over quantity given.
- The contractor shall be responsible for the purchasing of all material to meet the specifications of the plans including plants, soil, fertilizer, stakes, and hydroseed. The contractor shall also be responsible for the protection of these materials until the project has been completely turned over to the County.
- All plant material shall be subject to approval or rejection by the Landscape Architect or County's Inspector prior to installation. Installed and then rejected material shall be replaced by the contractor at his/her expense.
- The contractor shall include in the bid for a continued maintenance period of ninety (90) days after completion and acceptance of the project by the County. Maintenance for the hydroseeded areas does not commence until after hydroseeded has fully germinated and been accepted by the County.
- All trees in a formal group or in a row shall be matching in size and shape.
- All trees provided in the Planting Schedule/Legend are to be installed as single "Standard Form" trees unless specifically otherwise noted in the Planting Schedule/Legend. "Multi-trunk" and "Low-branching" trees delivered to the site will not be accepted unless specifically noted to be installed as such.
- The following soil amendments specified are for bidding purposes only. The Landscape Contractor shall provide for a Soil Agronomy Report from an approved soils laboratory and/or any additional specifications provided by the Land Arch. prior to installation of the plant material. The following amendments shall be incorporated into all planting pits and broadcast into soil to depth of 12" by means of a rototiller or equal per 1000 square feet.
4 cubic nitrogen stabilized organic amendment derived from redwood sawdust, fir sawdust or cedar sawdust.
15 lbs. soil sulfur
15 lbs. 15-15-15 Fertilizer
- All soil preparation shall be installed per the soil agronomy report to be provided and paid for by the Landscape Contractor. The report is to be immediately forwarded to the Land Arch. upon completion. The soil report for Project 3 will be acceptable for this project. Coordinate with Landscape Architect prior to purchasing a soil report.
- A nitrogen stabilized commercial-grade mulch with maximum 3/4" dia. chip size shall be uniformly broadcast over all shrub areas (not hydroseeded areas) to a depth as specified on the Planting Legend.
- The planting pits for trees shall be excavated per the detail on the Landscape Details sheet. The backfill mix for use in all tree and shrub pits shall consist of the following:
6 parts "on-site" soil
4 parts organic amendment (above)
1 lb./yd. of mix 12-12-12 commercial fertilizer
2 lbs./cu. yd. of mix Iron Sulfate
10 lbs./cu. yd. of mix Agricultural gypsum
- Fertilizer tablets shall be BEST, 21 gram fertilizer tablets (20-10-5) placed in all planting pits in quantities as follows:
1 gallon 1 tablet
5 gallon 3 tablets
15 gallon 4 tablets
24"-Box 4 tablets
- Thirty (30) days after installation all landscape shall be fertilized with 16-6-8 Fertilizer applied at the rate of 6 lbs./1000 sq. ft. Fertilizer application shall be continued thereafter at bi-monthly intervals.
- For weed control prior to planting, the Landscape Contractor shall thoroughly irrigate the site to promote germination of weed seeds that may be in the soil. After germination has taken place spray the site with Round-Up (or equal) in the amount, and let sit for the time specified by the manufacturer. Reapply Round-Up if needed. After all green weeds have been eradicated, apply Roynet-G (or equal) Pre-Emergent Weed control in the amounts specified by the manufacturer.
- All plant material to be nursery grown in similar climate. All plant material shall be vigorous and of normal habit of growth and shall be free of girdling roots, sun scald, abrasions, disease, insects, insect eggs and larvae. Plants shall equal or exceed the standards as outlined by the American Standards for Nursery Stock and to applicable California Agriculture Code.

HYDROSEED NOTES

- All rocks (greater than 2" dia.), debris, broken roots, and all other deleterious materials are to be raked and completely removed from the site. Soil to be rolled with a water-filled sod roller to lightly compact the soil prior to hydroseed.
- Irrigation coverage test shall be performed and any adjustments shall be made to account for wind, slope, etc. Hydroseed shall not be applied until irrigation coverage is complete and uniform and has been accepted by the landscape architect or County Inspector.
- After soil has been prepared and grade has been accepted by the County/Landscape Architect, the site is to be planted per the project specifications and industry standards for hydroseed installation. Hydroseed is to be installed by a licensed landscape contractor who has experience and the proper equipment to satisfactorily complete the job. Seed mix to be per the planting legend. Contractor to contact Landscape Architect prior to planting, seed mix may be revised depending upon weather.
- The contractor shall include in the bid for a continued maintenance period of ninety (90) days after completion and acceptance of the project by the County or Land Arch. The maintenance period will not begin until substantial germination of the seed, after weeds have been eradicated, and when the County Inspector or landscape architect accepts the area as being ready for commencement of the maintenance period.
- A protective fence is to be installed around all hydroseeded areas to keep people off until seed has established. Fence to be orange construction type or better and installed to the satisfaction of the County. Alternate protection methods may be approved by submittal process.
- Hydroseed to be completed between March 1 and October 31 unless otherwise specified or accepted.

PLANT SCHEDULE

TREES	BOTANICAL NAME	COMMON NAME	CONT.	QTY.	Water Use
CER DES	Cercidium x 'Desert Museum'	Thornless Palo Verde	24" box	4	Low
QUE LOB	Quercus lobata	Valley Oak	24" box	2	Low
SHRUBS	BOTANICAL NAME	COMMON NAME	SIZE	QTY.	Water Use
OLE LIT	Olea europaea 'Little Olive'	Little Olive Olive	5 gal	4	Low
GROUND COVERS	BOTANICAL NAME	COMMON NAME	CONT.	QTY.	Water Use
FES MAI	Festuca mairei	Atlas Fescue	1 gal	73	Low
TUR BOL	Turf Hydroseed Bolero Plus	Dwarf Fescue-Blue mix	Hydroseed	10,135 sf	High

- Existing turf area
- Existing landscape area

Non-Living Groundcover

No mulch is to be installed in hydroseeded planting areas. ADDITIVE ALTERNATE #8 - If container size planting is used, mulch is to be evenly distributed throughout the shrub and groundcover areas. Mulch to be nitrogen stabilized, max. 3/4", recycled material installed at min. 3" depth. Contractor to provide sample for approval prior to installation. "Gorilla-Hair" is not acceptable.

D.G. Decomposed granite - See Construction Plan Sheet L11

WATER EFFICIENT LANDSCAPE ORDINANCE

Planting and irrigation have been designed to be compliant with the Water Efficient Landscape Ordinance. The contractor shall not make substitutions of irrigation product or placement of product or plant species and cultivars without written consent of the Landscape Architect. The contractor shall be responsible for making all modifications to ensure the requirements of the Water Efficient Landscape Ordinance are met. If any changes are made, water use calculations as described on these plans must be met. The signature on this plan concurs that I have complied with the criteria of the water conservation in Landscaping Ordinance and applied them accordingly for the efficient use of water in the irrigation and planting design plan.

Planting Detail References

- For Trees, refer to Detail I, Sheet L4.1
- For Shrubs, refer to Detail K, Sheet L4.1
- For Groundcovers, refer to Detail J, Sheet L4.1

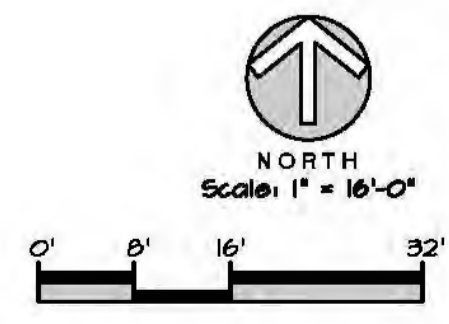

www.kla-ca.com
151 N. Norlin St., Sonoma, CA 95370
(209)532-2858 (209)532-9510 fax



Revisions

Date	By

These plans are the property of KLA, Inc. Their use shall be restricted to the site for which they were prepared. Publication or other use of these plans in whole or in part is not permitted without the express consent of KLA, Inc. Violation of these plans implies acceptance of the above restrictions.

© 2017

Stanislaus PSC
Town Square
Ceres, CA

Stanislaus County
Capital Projects
1010 10th Street, Suite 6800
Modesto, CA 95354

Planting Plan

Scale:
1" = 16'-0"

Date:
January 9, 2017

Drawn/Checked:
MEH / TWH

Project No.:
12-1440

Sheet Number:

L3.1