

THE BOARD OF SUPERVISORS OF THE COUNTY OF STANISLAUS
BOARD ACTION SUMMARY

DEPT: Workforce Development

BOARD AGENDA #: *B-10

AGENDA DATE: August 29, 2017

SUBJECT:

Approval of the Workforce Development Memorandum of Understanding - Phase II Cost Sharing Agreement with the Mandatory Partners of the America's Job Center of California (AJCC)

BOARD ACTION AS FOLLOWS:

No. 2017-477

On motion of Supervisor Olsen, Seconded by Supervisor Withrow
and approved by the following vote,

Ayes: Supervisors: Olsen, Withrow, Monteith, DeMartini, and Chairman Chiesa

Noes: Supervisors: None

Excused or Absent: Supervisors: None

Abstaining: Supervisor: None

1) Approved as recommended

2) Denied

3) Approved as amended

4) Other:

MOTION:

ATTEST: 
ELIZABETH A. KING, Clerk of the Board of Supervisors

File No.

**THE BOARD OF SUPERVISORS OF THE COUNTY OF STANISLAUS
AGENDA ITEM**

DEPT: Workforce Development
Urgent Routine

BOARD AGENDA #: *B-10

AGENDA DATE: August 29, 2017

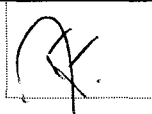

CEO CONCURRENCE: *ph*

4/5 Vote Required: Yes No

SUBJECT:

Approval of the Workforce Development Memorandum of Understanding - Phase II Cost Sharing Agreement with the Mandatory Partners of the America's Job Center of California (AJCC)

STAFF RECOMMENDATIONS:

1. Approve the Memorandum of Understanding – Phase II Cost Sharing Agreement with the mandatory partners of the America's Job Center of California Partners (AJCC).
2. Authorize the Chairman of the Board to sign the Memorandum of Understanding – Phase II Cost Sharing Agreement.

DISCUSSION:

The Workforce Innovation and Opportunity Act (WIOA) requires the Workforce Development Board, with the agreement of the Chief Elected Official (CEO), to develop Memorandum of Understanding (MOU) agreements with all required partners present in the Local Workforce Development Area (Local Area). The Workforce Innovation and Opportunity Act identifies the mandated required partners in the local area. The State of California added Stanislaus County Community Services Agency, a provider of Temporary Aid for Needy Families, as an additional mandated partner.

The MOU development process was split in two phases. Phase I was service coordination and collaboration amongst the partners and was submitted to the State by the June 30, 2016 deadline and subsequently approved. Phase II addresses resource sharing and joint infrastructure cost funding and must be approved at the local level by September 1, 2017.

Several meetings were held to engage partners in discussions regarding the MOU requirements. Partners shared their vision and ideas on how resources can be readily made available to the customers in the local area. In addition, meetings were conducted to discuss cost sharing amongst the partners that will be co-located with the Stanislaus County Department of Workforce Development and Employment Development Department (EDD) at 629 12th Street, which is the America's Job Center of California (AJCC) for Stanislaus County. Not all partners will be co-located. As such, customers will be referred to the non co-located partners as needed by the AJCC staff.

Approval of the Workforce Development Memorandum of Understanding - Phase II Cost Sharing Agreement with the Mandatory Partners of the America's Job Center of California (AJCC)

The fourteen required partners are listed in the table below:

Entity	Service Programs
Stanislaus County Department of Workforce Development	WIOA Title I Adult, Dislocated Worker, and Youth
Employment Development Department	WIOA Title III-Wagner-Peyser Veteran's Employment Services, Trade Adjustment Assistance Act, Unemployment Insurance, Migrant Seasonal Farmworkers
Ceres Unified School District	WIOA Title II-Adult Education and Literacy
Learning Quest-Stanislaus Literacy Centers	WIOA Title II-Adult Education and Literacy
Modesto City Schools	WIOA Title II-Adult Education and Literacy
Turlock Unified School District	WIOA Title II-Adult Education and Literacy
California State Department of Vocational Rehabilitation	WIOA Title IV-Rehabilitation Services
Housing Authority of the County of Stanislaus	Housing and Urban Development Employment and Training, Family Self-Sufficiency
Central Valley Opportunity Center	Community Services Block Grant, Migrant Seasonal Farmworkers
Stanislaus County Community Services Agency	Temporary Aid to Needy Families (CalWORKs)
Yosemite Community College District	Carl Perkins Career Technical Education
Job Corps	Educational and Vocational Training
Senior Community Service Employment Program	Title V Older Americans Act
California Indian Manpower Consortium, Inc.	Native American Programs

Approval of the Workforce Development Memorandum of Understanding - Phase II Cost Sharing Agreement with the Mandatory Partners of the America's Job Center of California (AJCC)

Workforce Innovation and Opportunity Act requires signatures on the MOU from both the Workforce Development Board Chair and the Chief Elected Official (Board of Supervisors). On July 10, 2017, the Workforce Development Board approved and authorized the Workforce Development Board Chair to sign the Memorandum of Understanding agreements for America's Job Center of California Phase II.

POLICY ISSUE:

The Workforce Innovation and Opportunity Act (WIOA) requires the Local Workforce Development Board to develop MOUs with all AJCC required partners present in the Local Workforce Development Area (Local Area). If not approved by the Board of Supervisors, WIOA funding could be impacted due to non-compliance.

As stated in the EDD Directive WSD 16-09, Local Boards may not be able to obtain signature(s) by the deadline of September 1, 2017. As such, Local Boards may submit an unsigned copy of the MOU with an explanation for the absent signature(s).

FISCAL IMPACT:

As a result of partner agencies sharing space effective January 1, 2018, it is anticipated that the cost to these partner agencies will be approximately \$6,000 for Fiscal Year 2017-2018. This will result in savings for the Department; however, the Department is not requesting a budget adjustment at this time.

BOARD OF SUPERVISORS' PRIORITY:

The recommended action supports the Board of Supervisors' priorities of Efficient Delivery of Public Services and A Strong Local Economy.

STAFFING IMPACT:

There is no staffing impact associated with this Agenda item.

CONTACT PERSON:

Doris Foster, Director (209) 558-2113

ATTACHMENT(S):

A – MOU Phase II Agreements

ATTACHMENT

A

Workforce Innovation and Opportunity Act

Phase II

Memorandum of Understanding for

Stanislaus County Workforce Development Area Service Delivery Partners

Table of Contents

1.	Required Phase II MOU Component: Process and Development	Page 3
2.	Required Phase II MOU Component: Sharing Infrastructure Costs	Page 5
	Chosen Options: Each Comprehensive AJCC / Network of Comprehensive AJCCs	Page 5
	Comprehensive AJCC(s) / Colocated Partners	Page 5
	Department of Workforce Development (formerly Alliance Worknet) Lease Area Calculations	Page 6
	AJCC Building Layout	Page 7
	AJCC Space Utilization Table	Page 8
	AJCC Infrastructure Budget	Page 9
	Initial Proportionate Share Allocated to Each Colocated Partner	Page 9
	Infrastructure Cost Allocation Methodology	Page 10
	Signature Page: Colocated Partners Sharing AJCC Infrastructure Costs	Page 12
	Signature Page: Non-Colocated Partners Sharing AJCC Infrastructure Costs When Benefit Data are Available	Page 13
3.	Required Phase II MOU Component: Sharing Other One-Stop System Costs	Page 14
	AJCC Partners Sharing Other One-Stop System Costs	Page 14
	Career Services Applicable to Each AJCC Partner	Page 14
	Required Consolidated Budget for the Delivery of Applicable Career Services	Page 17
	Options for Local Agreement for AJCC Partners to Share Other System Costs	Page 18
	Signature Page: AJCC Partners Sharing Other One-Stop System Costs	Page 19

Process and Development

Local Workforce Development Area: Stanislaus County Department of Workforce Development (formerly Alliance Worknet) on behalf of Stanislaus County Workforce Development Board

Date Submitted: September 1, 2017

Attachment: Signed Phase I MOU

1. The period of time this agreement is effective: January 1, 2017-June 30, 2019
2. Identification of all AJCC partners, Chief Elected Officials (CEO), and Local Boards participating in the infrastructure and other system costs funding agreements.

CEO: Vito Chiesa, Chairman

Local Board: Stanislaus County Workforce Development Board

AJCC Partners Participating in the Infrastructure Funding Agreement (IFA):

- Stanislaus County Department of Workforce Development (formerly Alliance Worknet) (DWD)
- Employment Development Department (EDD): *Job Services (Wagner-Peyser)*, *Veterans' Employment Services*, *Trade Adjustment Assistance Act*
- Ceres Unified School District (CUSD)
- Central Valley Opportunity Center (CVOC)
- California State Department of Vocational Rehabilitation (DOR)
- Job Corps
- SER-Jobs For Progress, Inc. Senior Community Service Employment Program (SCSEP)

AJCC Partners Participating in the Shared Other System Costs Agreement:

- Stanislaus County Department of Workforce Development (formerly Alliance Worknet) (DWD)
- Employment Development Department (EDD)
- Ceres Unified School District (CUSD)
- Learning Quest Stanislaus Literacy Centers (LQ-SLC)
- Modesto City Schools
- Turlock Unified School District (TUSD)
- California State Department of Vocational Rehabilitation (DOR)
- Housing Authority of the County of Stanislaus (HACS)
- Central Valley Opportunity Center (CVOC)
- Stanislaus County Community Services Agency (CSA)
- Yosemite Community College District (YCCD)
- Job Corps
- SER-Jobs For Progress, Inc. Senior Community Service Employment Program (SCSEP)
- CA Indian Manpower Consortium, Inc

3. Steps the Local Board, CEO, and AJCC partners took to reach consensus and/or an assurance that the Local Area followed guidance for the state infrastructure funding mechanism.
 - a. On behalf of Stanislaus County Workforce Development Board, Department of Workforce Development (formerly Alliance Worknet) convened a total of three meetings between October 2016 and May 2017 with AJCC partners to discuss MOU Phase II required content and timeline to complete Phase II. Of the three meetings, one meeting was held in January which included only colocated partners to discuss infrastructure costs. Frequent communication was had throughout this time period through email correspondence and telephone calls as well as individual partner meetings. Detailed emails were sent to partners outlining required documentation and/or input needed with deadlines. In addition, Department of Workforce Development (formerly Alliance Worknet) reached out to the Regional Advisor for support and maintained communication throughout the negotiation period.
4. A description of the process to be used among partners to resolve issues during the MOU duration period when consensus cannot be reached.
 - a. For purposes of this MOU, each party expressly agreed to participate in good faith negotiations to reach a consensus. All partners agreed to use the prescribed process in the Governor's Guidelines to achieve integration of program and service goals of WIOA. Active involvement and equal opportunity to provide input by required partners was demonstrated in the MOU negotiation process and is reflected in the MOU, with the exception of the CA Indian Manpower Consortium, Inc., who represent the Native American Programs (Section 166). CA Indian Manpower Consortium declined to respond to emails, phone calls and did not attend the final Phase II partner meeting. All partners and Regional Advisor have been made aware of this, therefore, Indian Manpower Consortium will not be signing Phase II of the MOU.
5. A description of the periodic modification and review process that will be used to ensure all AJCC partners continue to contribute their fair and equitable share of infrastructure and other system costs, including the identification of who will fulfill this responsibility.
(Who, What, When, How)
 - a. The specific contributions for Program Year 2017 are shown in table 3, and these contributions have been agreed to by the colocated partners. The colocated partners agree that these amounts are the contributions that the partners will make to the One-Stop costs for Program Year 2017-2018 only, and that this portion of the MOU covers the first year of the three-year MOU period. The colocated partners agree and recognize that the One-Stop costs and the partner contributions to these costs are to be renegotiated on an annual basis. Further, the colocated partners acknowledge that the ability of any partner to contribute its agreed contribution to the One-Stop costs is contingent on the availability of federal funding for its respective program(s).

On an annual basis, the colocated partners will collaborate to compile actual infrastructure and shared system costs for the prior year as was conducted between Department of Workforce Development (formerly Alliance Worknet) and the State EDD for the first year. Department of Workforce Development (formerly Alliance Worknet) will convene the annual meeting during the third quarter of the program year along with data on actual contributions to the operation of the One-Stop, and to prepare a report for use by all of the partners that compares the actual and budgeted values. This will be done to support the proper allocation of costs in a manner that fully complies with the applicable cost principles, and to assist in preparation of negotiations for the following year. Department of

Workforce Development (formerly Alliance Worknet) collaborated with the State EDD on infrastructure costs this year and this process is expected to continue annually.

Required Phase II MOU Component: Sharing Infrastructure Costs: Budget, Cost Allocation Methodology, Initial Proportionate Share

The Local Board and AJCC partners have chosen this option for developing the infrastructure cost budget:

- Option 1: A separate budget for each comprehensive AJCC.
- Option 2: A consolidated system-wide budget for the network of comprehensive AJCC

Modesto Comprehensive AJCC and Colocated Partners 629 12th Street; Modesto, CA	
<i>Colocated Partner definition: All AJCC partners who have a physical presence within the center, either full time, part time, or intermittent.</i>	
<ul style="list-style-type: none"> • Stanislaus County Department of Workforce Development (formerly Alliance Worknet) ((DWD)) 	<ul style="list-style-type: none"> • Ceres Unified School District (CUSD)
<ul style="list-style-type: none"> • California State Department of Vocational Rehabilitation (DOR) 	<ul style="list-style-type: none"> • Central Valley Opportunity Center (CVOC)
<ul style="list-style-type: none"> • Employment Development Department (EDD): <i>Job Services (Wagner-Peyser), Veterans' Employment Services, Trade Adjustment Assistance Act</i> 	<ul style="list-style-type: none"> • SER-Jobs For Progress, Inc. Senior Community Service Employment Program (SCSEP)
<ul style="list-style-type: none"> • Job Corps 	

The building layout and tables below reflect the infrastructure cost methodology found on pages 10-11.

ALLIANCE WORKNET OF STANISLAUS COUNTY LEASE AREA CALCULATIONS

DATE: 10/17/2013

GROSS BUILDING FLOOR AREA: 25067 SF

GROSS AREA MULTIPLIER: 1.06

ROOM #	ROOM NAME	AREA (S.F. - NET)	AREA (S.F. - GROSS)	COMMON	% ALLIANCE WORKNET OCCUPIED (common area excluded)	ALLIANCE WORKNET AREA (S.F.) (common area excluded)	ALLIANCE WORKNET AREA (S.F.)
ALLIANCE WORKNET EXCLUSIVE							
122	PARTNER OFFICE	160 S.F.	170 S.F.		100%	170 S.F.	170 S.F.
125	CONFERENCE ROOM	863 S.F.	918 S.F.		100%	918 S.F.	918 S.F.
127	TESTING	259 S.F.	275 S.F.		100%	275 S.F.	275 S.F.
E.D.D. & ALLIANCE WORKNET SHARED							
100	RESOURCE AREA	2166 S.F.	2304 S.F.		50%	1152 S.F.	1152 S.F.
101	RECEPTION LOBBY	804 S.F.	855 S.F.		50%	428 S.F.	428 S.F.
102	LOBBY	2070 S.F.	2201 S.F.		15%	330 S.F.	330 S.F.
106	OPEN WORK AREA	11111 S.F.	11817 S.F.		54%	6381 S.F.	6381 S.F.
COMMON AREA							
103	MEN (PUBLIC)	134 S.F.	143 S.F.	X	0%	0 S.F.	61 S.F.
104	WOMEN (PUBLIC)	137 S.F.	146 S.F.	X	0%	0 S.F.	62 S.F.
107	EMPLOYEE ROOM	707 S.F.	752 S.F.	X	0%	0 S.F.	320 S.F.
110	TELEPHONE ROOM	220 S.F.	234 S.F.	X	0%	0 S.F.	100 S.F.
114	TELEPHONE ROOM	261 S.F.	278 S.F.	X	0%	0 S.F.	118 S.F.
118	MEN (EMPLOYEE)	151 S.F.	161 S.F.	X	0%	0 S.F.	68 S.F.
119	WOMEN (EMPLOYEE)	204 S.F.	217 S.F.	X	0%	0 S.F.	92 S.F.
120	JANITOR	138 S.F.	147 S.F.	X	0%	0 S.F.	63 S.F.
121	HALLWAY	320 S.F.	340 S.F.	X	0%	0 S.F.	145 S.F.
E.D.D. EXCLUSIVE AREA							
105	TESTING / HEARING	494 S.F.	525 S.F.		0%	0 S.F.	0 S.F.
112	STORAGE	255 S.F.	271 S.F.		0%	0 S.F.	0 S.F.
113	OFFICE	138 S.F.	147 S.F.		0%	0 S.F.	0 S.F.
115	EDD MANAGER OFFICE	222 S.F.	236 S.F.		0%	0 S.F.	0 S.F.
116	STORAGE	105 S.F.	112 S.F.		0%	0 S.F.	0 S.F.
117	MAIL ROOM	128 S.F.	136 S.F.		0%	0 S.F.	0 S.F.
123	JANITOR	123 S.F.	131 S.F.		0%	0 S.F.	0 S.F.
126	WORKSHOP	590 S.F.	627 S.F.		0%	0 S.F.	0 S.F.
128	HEARING	315 S.F.	335 S.F.		0%	0 S.F.	0 S.F.
TARE							
108	MECHANICAL ROOM	659 S.F.	701 S.F.		0%	0 S.F.	0 S.F.
109	TRANSFORMER ROOM	133 S.F.	141 S.F.		0%	0 S.F.	0 S.F.
111	MECHANICAL ROOM	703 S.F.	748 S.F.		0%	0 S.F.	0 S.F.
SUBTOTAL		23570 S.F.	25067 S.F.	2416 S.F.		9654 S.F.	10684 S.F.

EXCLUSIVE EDD AREA:	1363 SF
SHARED EDD AREA:	8291 SF
EDD COMMON AREA SHARE:	1030 SF (43%)
TOTAL EDD LEASED AREA:	10684 SF
TARE:	0 S.F.

AJCC Building Layout - 629 12th ST., MODESTO

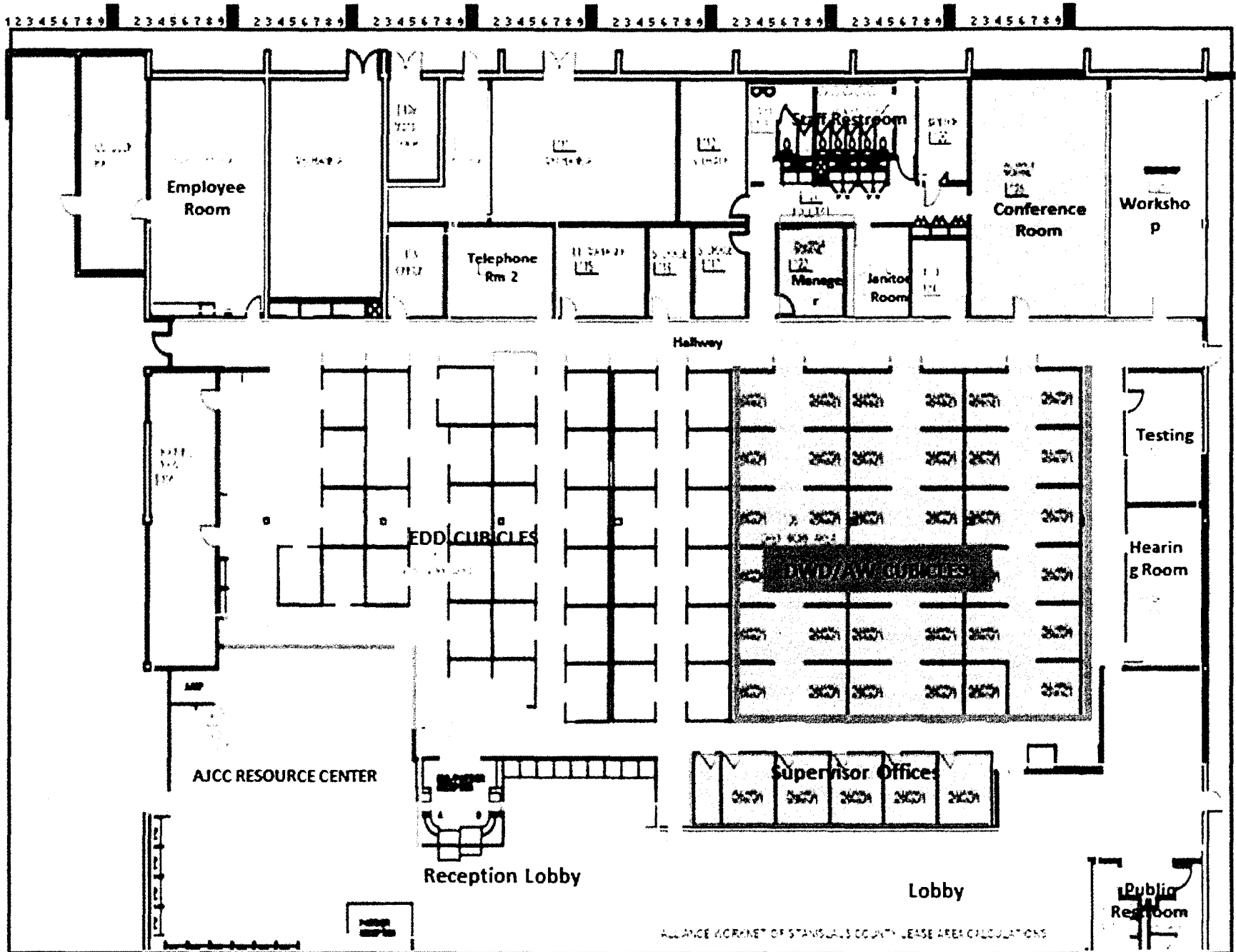

ALLANCE WORKNET OF STANISLAUS COUNTY LEASE AREA CALCULATIONS

Table I

Space Utilization Table - 629 12th Street. Modesto, CA				
Total Square Footage				25,067
Minus Common Square Footage				5,360
Total Dedicated Square Footage				19,707
Monthly Payment				\$ 20,749
Cost Per Square Footage				\$ 0.83
Occupancy	Quantity	Square Footage	Total Square Footage	Percent Occupied
ALLIANCE WORKNET WIOA				
CONFERENCE ROOM (125)	1	918		
CUBICLES/OPEN AREA (106)	33	6,035		
TESTING ROOM (127)	1	275		
OFFICE (122)	1	170		
ALLIANCE COMMON (103,104,107,110,114,118,119,120,121)	9	1,209	8,607	43.67%
SER-SCSP - CUBICLE	1	64	64	0.32%
CUSD - CUBICLE	1	64	64	0.32%
DOR - CUBICLE	1	90	90	0.46%
EDD AJCC				
EDD EXCLUSIVE (105,112,113,115,116,117,123,126,128)	9	2,520		
OPEN AREA (106)	1	5,436		
EDD TARE (108,109,111)	3	1,590		
EDD COMMON (103,104,107,110,114,118,119,120,121)	9	1,208	10,754	54.57%
JOB CORPS	1	64	64	0.32%
CVOC	1	64	64	0.32%
TOTAL:			19,707	100%
COMMON AREAS:			Percentage Occupied Space	78.6%
AJCC RESOURCE CENTER (100)		2,304		
RECEPTION LOBBY (101)		855.0		
LOBBY (102)		2,201.0	5,360	
			Percentage Common Space	21.4%

The numbers in parenthesis are from the County Lease Area document provided on page 7.

Table 2

AJCC Infrastructure Budget							
Percent Occupied		78.6%	Cost Applied to Percent Occupied			\$	16,312
Percent Common Space		21.4%	Cost Applied to Percent Common Space			\$	4,437
						Monthly Building Cost	\$ 20,749
Current Tenant Occupancy	Occupied Space	% of Occupied space	Occupied Area Cost	Common Area Cost	Agency MONTHLY Cost	Agency Annual Cost	
AW - WIOA	8,607	43.67%	\$ 7,124.40	\$ 1,937.73	\$ 9,062.13	\$ 108,746	
SER/SCSEP	64	0.32%	\$ 52.98	\$ 14.41	\$ 67.38	\$ 809	
CUSD	64	0.32%	\$ 52.98	\$ 14.41	\$ 67.38	\$ 809	
DOR	90	0.46%	\$ 74.50	\$ 20.26	\$ 94.76	\$ 1,137	
EDD	10,754	54.57%	\$ 8,901.57	\$ 2,421.09	\$ 11,322.66	\$ 135,872	
JOB CORPS	64	0.32%	\$ 52.98	\$ 14.41	\$ 67.38	\$ 809	
CVOC	64	0.32%	\$ 52.98	\$ 14.41	\$ 67.38	\$ 809	
Total	19,707	100.00%	\$ 16,312	\$ 4,437	\$ 20,749.08	\$ 248,989	

Table 3

Initial Proportionate Share Allocated to Each Colocated Partner									
Cost Component	FY Total	AW-WIOA	SER-SCSEP	CUSD	DOR	Job Corps	EDD	CVOC	
Occupancy Ratio	100%	43.67%	0.32%	0.32%	0.46%	0.32%	54.57%	0.32%	
Total Partner Occupancy Costs:	\$ 248,988.92	\$ 108,745.50	\$ 808.61	\$ 808.61	\$ 1,137.11	\$ 808.61	\$ 135,871.87	\$ 808.61	
Other Costs (if necessary):									
Access and Accomodation (A)	\$ 1,000	\$ 436.75	\$ 3.25	\$ 3.25	\$ 4.57	\$ 3.25	\$ 545.69	\$ 3.25	
Common Identifier (A)	\$ 1,500	\$ 655.12	\$ 4.87	\$ 4.87	\$ 6.85	\$ 4.87	\$ 818.54	\$ 4.87	
<i>Copier (TBD)</i>									
Total Partner Occupancy Costs:	\$ 251,488.92	\$ 109,837.37	\$ 816.73	\$ 816.73	\$ 1,148.53	\$ 816.73	\$ 137,236.10	\$ 816.73	

(A) These are budgeted costs and will only be charged to partners if incurred. Sufficient backup will be provided for the charges to all the partners.

Infrastructure Costs Methodology

Department of Workforce Development (formerly Alliance Worknet) coordinates the delivery of services at the Modesto AJCC Comprehensive Center (see AJCC Space Use Plan for building layout) with its colocated partners: Ceres Unified School District (CUSD), SER-Jobs For Progress, Inc. Senior Community Service Employment Program (SCSEP), California State Department of Vocational Rehabilitation (DOR), Job Corps, Employment Development Department (EDD), and Central Valley Opportunity Center (CVOC). The agreement is based on historical building costs from 2015-2016 year expenditures.

Space Utilization - *Table 1:*

The basis for calculating and distributing costs to partner agencies is as follows:

- A. Square footage of space used will be the basis to distribute infrastructure costs.
- B. The total space of Modesto Comprehensive Center is 25,067 square feet (sq. ft.)
 - I. Cubicle space was distributed to the co-located partners based on their need.
 - II. Total monthly payment was calculated by taking the yearly operating costs and dividing it by 12 months which calculated to \$20,749.
 - III. Total cost per sq. ft. was calculated by dividing \$20,749 by the total sq. ft. of 25,067, calculating to \$.83.
 - IV. Common area sq. ft. of 5,360 was subtracted from the total sq. ft. of 25,067 to determine the total dedicated partner sq. ft. of 19,707.
 - V. Percent occupied space was calculated by dividing the total partner sq. ft. of 19,707 by the total building space of 25,067 sq. ft.
 - VI. Percent common space was calculated by dividing the Common area sq. ft. 5,360 total by the total building space of 25,067 sq. ft.
 - VII. The ratio of occupied to common space is 78.6% to 21.4 %.

AJCC Infrastructure Budget - *Table 2*

The ratio of occupied space was applied to common space and used to calculate total monthly costs for each partner.

- A. Costs will be distributed to partners on a monthly basis.
- B. The cost allocation methodology selected adheres to the following:
 - i. Is consistent with the Federal laws authorizing each partner's program including any local administrative cost requirements.
 - ii. Complies with Federal cost principles in the Uniform Guidance.
 - iii. Includes only costs that are allowable, reasonable, necessary, and allocable to each program partner.
 - iv. Is based on the proportionate use and benefit received by each colocated partner in the AJCC.

Initial Proportionate Share Allocated - **Table 3** includes the budget outlining the infrastructure costs for the comprehensive AJCC. Included in the budget are the following cost items and detail for each line item:

- Building Costs:
 - Includes fully equipped usable cubicle space with computer
 - Utilities-electric, gas, sewer, water, internet access
 - Janitorial
 - Maintenance and building repair
 - Security
 - Alarm and telecom
- Access and Accommodation:
 - Technology or equipment needed for physical and programmatic access to the AJCC by individuals with disabilities.
- Common Identifier:
 - Creating new AJCC signage
 - Updating templates and materials
 - Updating Electronic Resources
- Copier:
 - Copier machine access – Copier costs will be billed to each partner based on their monthly usage.

Initial Proportionate Share of Infrastructure Costs

Table 2 shows the initial proportionate share of infrastructure costs allocated to each colocated partner based on the agreed upon cost allocation methodology. Table 3 identifies the cost estimates for the AJCC and total partners' costs share to be distributed among the colocated partners and will serve as the method for distributing costs for the duration of MOU. Table 3 also includes budgeted costs for access and accommodation and common identifier, if necessary. Some year-to-year adjustments are anticipated. Adjustments of greater than 5% by category will warrant a revision of the table, but will not require an amendment to the agreement. This initial determination must be periodically reconciled against actual costs incurred and adjusted accordingly. Non-cash or in-kind contributions will be fairly evaluated, in accordance with Uniform Guidance Section 200.306.

Phase II MOU Content Requirement:

The state is in the process of implementing the requisite statewide data tracking system, and once such data are available, all non-colocated partners who are receiving benefit from the AJCCs will also be required to contribute their proportionate share towards infrastructure costs. Consequently, the Phase II MOU must include an assurance from all non-colocated partners that they agree to pay their proportionate share of infrastructure costs as soon as sufficient data are available.

By signing below, all parties agree that when data is available to determine the AJCC benefit to non-colocated partners, the infrastructure cost sharing agreement will be renegotiated to include their proportionate share of contributions.

Signature Page: Colocated Partners Sharing AJCC Infrastructure Costs

The CEO, the Local Board Chairperson, and all colocated AJCC partners included in the sharing of infrastructure costs must sign. By signing below, all parties agree to the terms prescribed in the IFA.

CEO

Vito Chiesa, Board of Supervisor, Chairman

Printed Name and Title

 8/29/17

Signature and Date

Local Board Chairperson

WILLIAM O'BRIEN, CHAIRMAN

Printed Name and Title

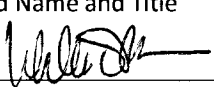
 8/21/17

Signature and Date

By signing below, all parties agree that when data is available to determine the AJCC benefit to non-colocated partners, the infrastructure cost sharing agreement will be renegotiated to include their proportionate share of contributions.

Signature Page: Colocated Partners Sharing AJCC Infrastructure Costs

The CEO, the Local Board Chairperson, and all colocated AJCC partners included in the sharing of infrastructure costs must sign. By signing below, all parties agree to the terms prescribed in the IFA.

CEO

Printed Name and Title

Signature and Date

Local Board Chairperson

Printed Name and Title

Signature and Date

Central Valley Opportunity Center

Jorge DeNava, Executive Director

Printed Name and Title

[Signature] *7-28-17*

Signature and Date

By signing below, all parties agree that when data is available to determine the AJCC benefit to non-located partners, the infrastructure cost sharing agreement will be renegotiated to include their proportionate share of contributions.

Signature Page: Colocated Partners Sharing AJCC Infrastructure Costs

The CEO, the Local Board Chairperson, and all colocated AJCC partners included in the sharing of infrastructure costs must sign. By signing below, all parties agree to the terms prescribed in the IFA.

CEO

Printed Name and Title

Signature and Date

Local Board Chairperson

Printed Name and Title

Signature and Date

Ceres Unified School District

Dallas Place / Coordinator of Ed Options

Printed Name and Title

[Signature] 7/26/17

Signature and Date

By signing below, all parties agree that when data is available to determine the AJCC benefit to non-colocated partners, the infrastructure cost sharing agreement will be renegotiated to include their proportionate share of contributions.

Signature Page: Colocated Partners Sharing AJCC Infrastructure Costs

The CEO, the Local Board Chairperson, and all colocated AJCC partners included in the sharing of infrastructure costs must sign. By signing below, all parties agree to the terms prescribed in the IFA.

CEO

Printed Name and Title

Signature and Date

Local Board Chairperson

Printed Name and Title

Signature and Date

Department of Workforce Development (formerly Alliance Worknet)

DORIS FOSTER, DIRECTOR
Printed Name and Title

 8-18-2017
Signature and Date

By signing below, all parties agree that when data is available to determine the AJCC benefit to non-colocated partners, the infrastructure cost sharing agreement will be renegotiated to include their proportionate share of contributions.

Signature Page: Colocated Partners Sharing AJCC Infrastructure Costs

The CEO, the Local Board Chairperson, and all colocated AJCC partners included in the sharing of infrastructure costs must sign. By signing below, all parties agree to the terms prescribed in the IFA.

CEO

Printed Name and Title

Signature and Date

Local Board Chairperson

Printed Name and Title

Signature and Date

Employment Development Department

JANET NEITZEL, Deputy Director Chief

Printed Name and Title

Janet Neitzel 8-2-2017

Signature and Date

By signing below, all parties agree that when data is available to determine the AJCC benefit to non-colocated partners, the infrastructure cost sharing agreement will be renegotiated to include their proportionate share of contributions.

Signature Page: Colocated Partners Sharing AJCC Infrastructure Costs

The CEO, the Local Board Chairperson, and all colocated AJCC partners included in the sharing of infrastructure costs must sign. By signing below, all parties agree to the terms prescribed in the IFA.

CEO

Printed Name and Title

Signature and Date

Local Board Chairperson

Printed Name and Title

Signature and Date

Employment Development Department – Unemployment Insurance

Sylvia Garibay, Employment Development Administrator

Printed Name and Title

Sylvia Garibay *8/1/17*

Signature and Date

By signing below, all parties agree that when data is available to determine the AJCC benefit to non-located partners, the infrastructure cost sharing agreement will be renegotiated to include their proportionate share of contributions.

Signature Page: Colocated Partners Sharing AJCC Infrastructure Costs

The CEO, the Local Board Chairperson, and all colocated AJCC partners included in the sharing of infrastructure costs must sign. By signing below, all parties agree to the terms prescribed in the IFA.

CEO

Printed Name and Title

Signature and Date

Local Board Chairperson

Printed Name and Title

Signature and Date

Job Corps

Printed Name and Title

Signature and Date

Explanation of Missing Signature

As stated in the EDD Directive WSD 16-09, Local Boards may not be able to obtain signature(s) by the deadline of September 1, 2017. As such, Local Boards may submit an unsigned copy of the MOU with an explanation for the absent signature(s).

The Department of Workforce Development is working with Job Corps and the State to determine the best mechanism to collect the cost of occupied space.

By signing below, all parties agree that when data is available to determine the AJCC benefit to non-colocated partners, the infrastructure cost sharing agreement will be renegotiated to include their proportionate share of contributions.

Signature Page: Colocated Partners Sharing AJCC Infrastructure Costs

The CEO, the Local Board Chairperson, and all colocated AJCC partners included in the sharing of infrastructure costs must sign. By signing below, all parties agree to the terms prescribed in the IFA.

CEO

Printed Name and Title

Signature and Date

Local Board Chairperson

Printed Name and Title

Signature and Date

SER-Jobs For Progress, Inc. Senior Community Service SCSEP

Esteban Gonzalez SCSEP Director

Printed Name and Title

Signature and Date

8/2/17

Signature Page: Partners Sharing Infrastructure Costs When Proportionate Share Data Are Available

Phase II MOU Content Requirement:

The state is in the process of implementing the requisite statewide data tracking system, and once such data are available, all non-colocated partners who are receiving benefit from the AJCCs will also be required to contribute their proportionate share towards infrastructure costs. Consequently, the Phase II MOU must include an assurance from all non-colocated partners that they agree to pay their proportionate share of infrastructure costs as soon as sufficient data are available.

By signing below, all parties agree that when data are available to determine the AJCC benefit to non-colocated partners, the infrastructure cost sharing agreement will be renegotiated to include their proportionate share of contributions.

CA Indian Manpower Consortium, Inc.

Lorenda T. Sanchez, Executive Director

Printed Name and Title



8/2/2017

Signature and Date

Signature Page: Partners Sharing Infrastructure Costs When Proportionate Share Data Are Available

Phase II MOU Content Requirement:

The state is in the process of implementing the requisite statewide data tracking system, and once such data are available, all non-colocated partners who are receiving benefit from the AJCCs will also be required to contribute their proportionate share towards infrastructure costs. Consequently, the Phase II MOU must include an assurance from all non-colocated partners that they agree to pay their proportionate share of infrastructure costs as soon as sufficient data are available.

By signing below, all parties agree that when data are available to determine the AJCC benefit to non-colocated partners, the infrastructure cost sharing agreement will be renegotiated to include their proportionate share of contributions.

California State Department of Vocational Rehabilitation

Araceli Holland
Printed Name and Title

Araceli Holland
Signature and Date

Signature Page: Partners Sharing Infrastructure Costs When Proportionate Share Data Are Available

Phase II MOU Content Requirement:

The state is in the process of implementing the requisite statewide data tracking system, and once such data are available, all non-colocated partners who are receiving benefit from the AJCCs will also be required to contribute their proportionate share towards infrastructure costs. Consequently, the Phase II MOU must include an assurance from all non-colocated partners that they agree to pay their proportionate share of infrastructure costs as soon as sufficient data are available.

By signing below, all parties agree that when data are available to determine the AJCC benefit to non-colocated partners, the infrastructure cost sharing agreement will be renegotiated to include their proportionate share of contributions.

Housing Authority of the County of Stanislaus

Jim Kruse Deputy Director
Printed Name and Title

Jim Kruse 8-18-17
Signature and Date

Signature Page: Partners Sharing Infrastructure Costs When Proportionate Share Data Are Available

Phase II MOU Content Requirement:

The state is in the process of implementing the requisite statewide data tracking system, and once such data are available, all non-located partners who are receiving benefit from the AJCCs will also be required to contribute their proportionate share towards infrastructure costs. Consequently, the Phase II MOU must include an assurance from all non-located partners that they agree to pay their proportionate share of infrastructure costs as soon as sufficient data are available.

By signing below, all parties agree that when data are available to determine the AJCC benefit to non-located partners, the infrastructure cost sharing agreement will be renegotiated to include their proportionate share of contributions.

Learning Quest Stanislaus Literacy Center

Karen Williams, Executive Director
Printed Name and Title

Karen Williams
Signature and Date

Signature Page: Partners Sharing Infrastructure Costs When Proportionate Share Data Are Available

Phase II MOU Content Requirement:

The state is in the process of implementing the requisite statewide data tracking system, and once such data are available, all non-colocated partners who are receiving benefit from the AJCCs will also be required to contribute their proportionate share towards infrastructure costs. Consequently, the Phase II MOU must include an assurance from all non-colocated partners that they agree to pay their proportionate share of infrastructure costs as soon as sufficient data are available.

By signing below, all parties agree that when data are available to determine the AJCC benefit to non-colocated partners, the infrastructure cost sharing agreement will be renegotiated to include their proportionate share of contributions.

Modesto City Schools

Tim Zearley, Assoc. Supt. Business Services / CBO
Printed Name and Title

Tim Zearley 7/27/17
Signature and Date

Signature Page: Partners Sharing Infrastructure Costs When Proportionate Share Data Are Available

Phase II MOU Content Requirement:

The state is in the process of implementing the requisite statewide data tracking system, and once such data are available, all non-colocated partners who are receiving benefit from the AJCCs will also be required to contribute their proportionate share towards infrastructure costs. Consequently, the Phase II MOU must include an assurance from all non-colocated partners that they agree to pay their proportionate share of infrastructure costs as soon as sufficient data are available.

By signing below, all parties agree that when data are available to determine the AJCC benefit to non-colocated partners, the infrastructure cost sharing agreement will be renegotiated to include their proportionate share of contributions.

Stanislaus County Community Services Agency

DAW WIRTZ ASSISTANT DIRECTOR

Printed Name and Title

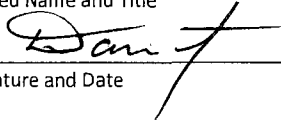
 8/10/2017

Signature and Date

Signature Page: Partners Sharing Infrastructure Costs When Proportionate Share Data Are Available

Phase II MOU Content Requirement:

The state is in the process of implementing the requisite statewide data tracking system, and once such data are available, all non-colocated partners who are receiving benefit from the AJCCs will also be required to contribute their proportionate share towards infrastructure costs. Consequently, the Phase II MOU must include an assurance from all non-colocated partners that they agree to pay their proportionate share of infrastructure costs as soon as sufficient data are available.

By signing below, all parties agree that when data are available to determine the AJCC benefit to non-colocated partners, the infrastructure cost sharing agreement will be renegotiated to include their proportionate share of contributions.

Turlock Unified School District

Dana Salles Trevethan, Superintendent
Printed Name and Title

Signature and Date

Signature Page: Partners Sharing Infrastructure Costs When Proportionate Share Data Are Available

Phase II MOU Content Requirement:

The state is in the process of implementing the requisite statewide data tracking system, and once such data are available, all non-colocated partners who are receiving benefit from the AJCCs will also be required to contribute their proportionate share towards infrastructure costs. Consequently, the Phase II MOU must include an assurance from all non-colocated partners that they agree to pay their proportionate share of infrastructure costs as soon as sufficient data are available.

By signing below, all parties agree that when data are available to determine the AJCC benefit to non-colocated partners, the infrastructure cost sharing agreement will be renegotiated to include their proportionate share of contributions.

Yosemite Community College District

Printed Name and Title

Signature and Date

Explanation of Missing Signature

As stated in the EDD Directive WSD 16-09, Local Boards may not be able to obtain signature(s) by the deadline of September 1, 2017. As such, Local Boards may submit an unsigned copy of the MOU with an explanation for the absent signature(s).

The Department of Workforce Development has made several attempts to contact the Yosemite Community College District, however, all attempts have been unsuccessful in receiving a signed MOU. The Department will continue to pursue obtaining signatures.

Required Phase II MOU Component: Sharing Other One-Stop System Costs

The other system costs budget consists of the consolidated budget that includes a line item for applicable career services. The signed Phase I MOU identified career services that were applicable to each partner program. Accordingly, this budget includes each of the partner's costs for the service delivery of each applicable career service and a consolidated system budget for career services applicable to more than one partner. Applicable Career Services are services authorized to be provide under each partner's program.

Summary of Career Services Applicable to Each One-Stop Delivery System Partner (Phase I MOU)											
Basic Career Services	T-I Adult/DW/Youth <i>Stanislaus DWD</i>		CUSD	T-II AEL <i>LQSLC TUSD MCS</i>		T-III WP <i>EDD</i>	T-IV VR <i>DOR</i>	T-V OAA <i>SER-SCSEP</i>	TANF <i>CSA</i>		
	T-I Program Eligibility	✓			✓	✓		✓	✓	✓	✓
Outreach, Intake, Orient	✓		✓	✓	✓		✓	✓	✓	✓	
Initial Assessment	✓		✓	✓	✓		✓	✓	✓	✓	
Labor Exch/Job Search	✓					✓		✓	✓	✓	
Referrals to Partners	✓		✓	✓	✓	✓		✓	✓	✓	
LMI	✓		✓			✓		✓			
Performance/Cost Info	✓									✓	
Support Service Info	✓		✓	✓				✓		✓	
UI Info/Assistance	✓					✓					
Financial Aid Info	✓					✓				✓	
Basic Career Services	Tech Ed <i>MJC YCCD</i>	Job Corps	Native American Program <i>CA Indian Manpower Consortium, Inc</i>			MSF <i>CVOC</i>	Veterans <i>EDD</i>	Trade Act <i>EDD</i>	Community Action/E/T <i>CVOC</i>	Housing <i>HACS</i>	UI <i>EDD</i>
T-I Program Eligibility		✓	✓			✓	✓	✓	✓	✓	✓
Outreach, Intake, Orient	✓	✓	✓			✓	✓	✓	✓	✓	N/A

Initial Assessment	✓	✓	✓	✓	✓	✓	✓	✓	✓		
Labor Exchange/Job Search						✓	✓				
Referrals to Partners	✓	✓	✓	✓	✓	✓	✓	✓	✓		
LMI			✓	✓	✓	✓	✓	✓			
Performance/Cost Info		✓		✓	✓	✓	✓				
Support Service Info	✓			✓	✓	✓	✓	✓	✓		
UI Info/Assistance						✓	✓			✓	
Financial Aid Info	✓		✓	✓			✓				
Individual Career Services	T-I Adult/DW/ Youth Stanislaus DWD		T-II AEL CUSD LQSLC TUSD MCS			T-III WP EDD	T-IV VR DOR	T-V OAA SER-SCSEP	TANF CSA		
Comp Assessment	✓						✓	✓	✓		
IEP	✓		✓				✓	✓	✓		
Career Plan/Counsel	✓		✓	✓	✓	✓	✓	✓	✓		
Short-Term Prevoc.	✓		✓				✓		✓		
Internships/Work Experience							✓	✓	✓		
Out-of-Area Job Search	✓		✓		✓	✓	✓		✓		
Financial Literacy			✓						✓		
IET/ELA			✓	✓							
Workforce Preparation			✓	✓							
Individual Career Services	Tech Ed MJC YCCD	Job Corps	Native American Program CA Indian Manpower Consortium, Inc			MSF CVOC	Veterans EDD	Trade Act EDD	Community Action/E/T CVOC	Housing HACS	UI EDD
Comp Assessment			✓			✓	✓	✓	✓		

IEP	✓	✓	✓	✓	✓	✓		✓	
Career Plan/Counsel	✓	✓	✓	✓	✓	✓	✓	✓	
Short-Term Prevoc.	✓	✓	✓	✓	✓	✓	✓		
Internships/Work Experience									
Out-of-Area Job Search	✓	✓	✓	✓	✓	✓	✓	✓	
Financial Literacy									
*Integrated Education Training (ETL), English Language Acquisition (ELA)				✓					
*Workforce Preparation	✓								

Required Consolidated Budget for the Delivery of Applicable Career Services

This budget includes each of the partner's costs for the service delivery of each applicable career service and a consolidated system budget for career services applicable to more than one partner. This budget includes all costs, including personnel, related to the administration and delivery of those services.

Applicable Career Services	T-I Adult/DW/Youth <i>Stanislaus DWD</i>	T-II AEL				T-III WP <i>EDD</i>	T-IV VR <i>DOR</i>	T-V OAA <i>SER-SCSEP</i>	TANF <i>CSA</i>
		<i>CUSD</i>	<i>LQSLC</i>	<i>TUSD</i>	<i>MCS</i>				
Basic Career Services: T-I Eligibility/Initial Assess Outreach, Intake, Orient Labor Exchange/Job Search Referrals/LMI Support Service Info UI Info/Fin Aid Info	\$4,981,694	\$0	\$27,500	\$0	\$0	\$766,860.74	\$1,466,463.91	\$11,041	\$14,209,576
Applicable Career Services	Tech Ed <i>MJC YCCD</i>	Job Corps	Native American Program <i>CA Indian Manpower Consortium, Inc</i>	MSF CVOC	Veterans EDD	Trade Act EDD	Community Action/E/T CVOC	Housing HACS	UI EDD
Basic Career Services: T-I Eligibility/Initial Assess Outreach, Intake, Orient Labor Exchange/Job Search Referrals/LMI Support Service Info UI Info/Fin Aid Info	\$0	\$	\$	\$26,845	\$273,858.30	\$14,156.65	\$31,155	\$0	\$33,125.00

Applicable Career Services	T-I Adult/DW/Youth <i>Stanislaus DWD</i>	T-II AEL				T-III WP <i>EDD</i>	T-IV VR <i>DOR</i>	T-V OAA <i>SER-SCSEP</i>	TANF <i>CSA</i>
		<i>CUSD</i>	<i>LQSLC</i>	<i>TUSD</i>	<i>MCS</i>				
Individual Career Services: Comp Assessment/IEP Career Plan/Counsel Short-Term Pre-vocational Internship/Work Experience Financial Literacy IET/ELA/WF Prep	\$3,741,015	\$22,810	\$27,500	\$0	\$0	\$135,328.37	\$ 5,865,855.65	\$115,515	\$5,040,468
Applicable Career Services	Tech Ed <i>YCCD</i>	Job Corps	Native American Program <i>CA Indian Manpower Consortium, Inc</i>	MSF CVOC	Veterans EDD	Trade Act EDD	Community Action/E/T CVOC	Housing HACS	UI EDD
Individual Career Services: Comp Assessment/IEP Career Plan/Counsel Short-Term Pre-vocational Internship/Work Experience Financial Literacy IET/ELA/WF Prep	\$ 620,000	\$	\$	\$26,845	\$48,279.76	\$2,498.23	\$31,155	\$0	\$0
Consolidated budget total of career services delivered through the One-Stop system: \$37,519,545.61									

Partner Agreement to Share Other One-Stop System Costs

The other system costs budget may include any other shared services that are authorized for and commonly provided through the AJCC partner programs to any individual, such as initial intake, assessment of needs, appraisal of basic skills, identification of appropriate services to meet such needs, or referrals to other One-Stop partners. As with infrastructure costs, other system costs must be allocable according to the proportion of benefit received by each of the AJCC partner programs, consistent with the partner’s authorizing federal statute and Uniform Guidance. At this time, the AJCC partnership has decided to not include other system cost budget since there isn’t a methodology to determine a benefit for each partner. Once the AJCC system has been implemented and the state data tracking system is in place or data is available, we will reconvene a meeting to agree and include other system costs.

Signature Page: AJCC Partners Sharing Other One-Stop System Costs.

All partners who signed the Phase I MOU must sign the Phase II MOU. By signing below, all parties agree to the terms prescribed in the sharing of other One-Stop system costs.

CEO

Vito Chiesa, Board of Supervisor, Chairman

Printed Name and Title

Vito Chiesa 8/29/17

Signature and Date

Local Board Chairperson

WILLIAM O'BRIEN, CHAIRMAN

Printed Name and Title

William O'Brien 8/21/17

Signature and Date

Signature Page: AJCC Partners Sharing Other One-Stop System Costs.

All partners who signed the Phase I MOU must sign the Phase II MOU. By signing below, all parties agree to the terms prescribed in the sharing of other One-Stop system costs.

CEO

Printed Name and Title

Signature and Date

Local Board Chairperson

Printed Name and Title

Signature and Date

CA Indian Manpower Consortium, Inc.

Lorenda T. Sanchez, Executive Director

Printed Name and Title

Lorenda Sanchez 8/2/2017

Signature and Date

Signature Page: AJCC Partners Sharing Other One-Stop System Costs.

All partners who signed the Phase I MOU must sign the Phase II MOU. By signing below, all parties agree to the terms prescribed in the sharing of other One-Stop system costs.

CEO

Printed Name and Title

Signature and Date

Local Board Chairperson

Printed Name and Title

Signature and Date

California State Department of Vocational Rehabilitation

Printed Name and Title

Signature and Date

Explanation of Missing Signature

As stated in the EDD Directive WSD 16-09, Local Boards may not be able to obtain signature(s) by the deadline of September 1, 2017. As such, Local Boards may submit an unsigned copy of the MOU with an explanation for the absent signature(s).

The California State Department of Vocational Rehabilitation has signed the infrastructure costs section, however, they unintentionally did not sign this page. They are aware and will be sending a signed copy.

Signature Page: AJCC Partners Sharing Other One-Stop System Costs.

All partners who signed the Phase I MOU must sign the Phase II MOU. By signing below, all parties agree to the terms prescribed in the sharing of other One-Stop system costs.

CEO

Printed Name and Title

Signature and Date

Local Board Chairperson

Printed Name and Title

Signature and Date

Ceres Unified School District

Dallas Area Coordinator of Ed Options

Printed Name and Title

Jellie *7/26/12*

Signature and Date

Signature Page: AJCC Partners Sharing Other One-Stop System Costs.

All partners who signed the Phase I MOU must sign the Phase II MOU. By signing below, all parties agree to the terms prescribed in the sharing of other One-Stop system costs.

CEO

Printed Name and Title

Signature and Date

Local Board Chairperson

Printed Name and Title

Signature and Date

Central Valley Opportunity Center

George DeWane, Executive Director

Printed Name and Title

[Signature] *7-18-17*

Signature and Date

Signature Page: AJCC Partners Sharing Other One-Stop System Costs.

All partners who signed the Phase I MOU must sign the Phase II MOU. By signing below, all parties agree to the terms prescribed in the sharing of other One-Stop system costs.

CEO

Printed Name and Title

Signature and Date

Local Board Chairperson

Printed Name and Title

Signature and Date

Department of Workforce Development (formerly Alliance Worknet)

DORIS FOSTER, DIRECTOR
Printed Name and Title

D Foster 8-18-2017
Signature and Date

Signature Page: AJCC Partners Sharing Other One-Stop System Costs.

All partners who signed the Phase I MOU must sign the Phase II MOU. By signing below, all parties agree to the terms prescribed in the sharing of other One-Stop system costs.

CEO

Printed Name and Title

Signature and Date

Local Board Chairperson

Printed Name and Title

Signature and Date

Employment Development Department

JANET NEITZEL, Deputy Division Chief

Printed Name and Title

Janet Neitzel 8-2-2017

Signature and Date

Signature Page: AJCC Partners Sharing Other One-Stop System Costs.

All partners who signed the Phase I MOU must sign the Phase II MOU. By signing below, all parties agree to the terms prescribed in the sharing of other One-Stop system costs.

CEO

Printed Name and Title

Signature and Date

Local Board Chairperson

Printed Name and Title

Signature and Date

Employment Development Department – Unemployment Insurance

Sylvia Garibay, Employment Development Administrator

Printed Name and Title

Sylvia Garibay 8/1/17

Signature and Date

Signature Page: AJCC Partners Sharing Other One-Stop System Costs.

All partners who signed the Phase I MOU must sign the Phase II MOU. By signing below, all parties agree to the terms prescribed in the sharing of other One-Stop system costs.

CEO

Printed Name and Title

Signature and Date

Local Board Chairperson

Printed Name and Title

Signature and Date

Housing Authority of the County of Stanislaus

Jim Kruse Deputy Director

Printed Name and Title

Jim Kruse *8-18-17*

Signature and Date

Signature Page: AJCC Partners Sharing Other One-Stop System Costs.

All partners who signed the Phase I MOU must sign the Phase II MOU. By signing below, all parties agree to the terms prescribed in the sharing of other One-Stop system costs.

CEO

Printed Name and Title

Signature and Date

Local Board Chairperson

Printed Name and Title

Signature and Date

Job Corps

Katie Stunkel, *Project Director*

Printed Name and Title

Katie Stunkel *8/17/17*

Signature and Date

Signature Page: AJCC Partners Sharing Other One-Stop System Costs.

All partners who signed the Phase I MOU must sign the Phase II MOU. By signing below, all parties agree to the terms prescribed in the sharing of other One-Stop system costs.

CEO

Printed Name and Title

Signature and Date

Local Board Chairperson

Printed Name and Title

Signature and Date

Learning Quest Stanislaus Literacy Centers

Karen Williams, Exec. Director
Printed Name and Title

[Signature] 7/26/17
Signature and Date

Signature Page: AJCC Partners Sharing Other One-Stop System Costs.

All partners who signed the Phase I MOU must sign the Phase II MOU. By signing below, all parties agree to the terms prescribed in the sharing of other One-Stop system costs.

CEO

Printed Name and Title

Signature and Date

Local Board Chairperson

Printed Name and Title

Signature and Date

Modesto City Schools

Tim Zearley, Assoc. Supt. Business Services / CEO
Printed Name and Title

T. Zearley 7/27/17
Signature and Date

Signature Page: AJCC Partners Sharing Other One-Stop System Costs.

All partners who signed the Phase I MOU must sign the Phase II MOU. By signing below, all parties agree to the terms prescribed in the sharing of other One-Stop system costs.

CEO

Printed Name and Title

Signature and Date

Local Board Chairperson

Printed Name and Title

Signature and Date

SER-Jobs For Progress, Inc. Senior Community Service SCSEP

Esteban Gonzalez
Printed Name and Title

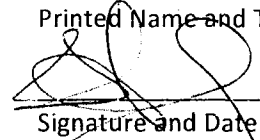
Signature and Date

8/2/17

Signature Page: AJCC Partners Sharing Other One-Stop System Costs.

All partners who signed the Phase I MOU must sign the Phase II MOU. By signing below, all parties agree to the terms prescribed in the sharing of other One-Stop system costs.

CEO

Printed Name and Title

Signature and Date

Local Board Chairperson

Printed Name and Title

Signature and Date

Stanislaus County Community Services Agency

DAN WIRTZ ASSISTANT DIRECTOR

Printed Name and Title

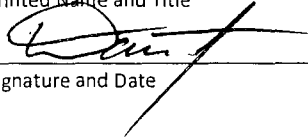

Signature and Date

8/10/2017

Signature Page: AJCC Partners Sharing Other One-Stop System Costs.

All partners who signed the Phase I MOU must sign the Phase II MOU. By signing below, all parties agree to the terms prescribed in the sharing of other One-Stop system costs.

CEO

Printed Name and Title

Signature and Date

Local Board Chairperson

Printed Name and Title

Signature and Date

Turlock Unified School District

Dana Salles Trevethan, Superintendent

Printed Name and Title



Signature and Date

Signature Page: AJCC Partners Sharing Other One-Stop System Costs.

All partners who signed the Phase I MOU must sign the Phase II MOU. By signing below, all parties agree to the terms prescribed in the sharing of other One-Stop system costs.

CEO

Printed Name and Title

Signature and Date

Local Board Chairperson

Printed Name and Title

Signature and Date

Yosemite Community College District

Printed Name and Title

Signature and Date

Explanation of Missing Signature

As stated in the EDD Directive WSD 16-09, Local Boards may not be able to obtain signature(s) by the deadline of September 1, 2017. As such, Local Boards may submit an unsigned copy of the MOU with an explanation for the absent signature(s).

The Department of Workforce Development has made several attempts to contact the Yosemite Community College District, however, all attempts have been unsuccessful in receiving a signed MOU. The Department will continue to pursue obtaining signatures.