

THE BOARD OF SUPERVISORS OF THE COUNTY OF STANISLAUS

ACTION AGENDA SUMMARY

DEPT: Public Works *Haugh*

BOARD AGENDA #            \*C-2

Urgent  Routine

AGENDA DATE February 15, 2011

CEO Concurs with Recommendation YES  NO   
(Information Attached)

4/5 Vote Required YES  NO

SUBJECT:

Approval to Adopt Plans and Specifications for the Hatch Road PFF Channelization Project, Phase 1-B

STAFF RECOMMENDATIONS:

1. Adopt the Plans and Specifications for the Hatch Road PFF Channelization Project, Phase 1-B and authorize a bid opening.
2. Direct the Department of Public Works to set the bid opening date and time.
3. Direct the Public Works Department staff to mail the notice inviting bids to trade journals as required by law.

FISCAL IMPACT:

The total anticipated cost for this project is \$3,000,000. The costs include the following:

Continued on Page 2

BOARD ACTION AS FOLLOWS:

No. 2011-109

On motion of Supervisor Withrow Seconded by Supervisor Chiesa  
and approved by the following vote,

Ayes: Supervisors: O'Brien, Chiesa, Withrow, DeMartini, and Chairman Monteith

Noes: Supervisors: None

Excused or Absent: Supervisors: None

Abstaining: Supervisor: None

1) X Approved as recommended

2)        Denied

3)        Approved as amended

4)        Other:

MOTION:

*Christine Ferraro*

ATTEST: CHRISTINE FERRARO TALLMAN, Clerk

File No.

Approval to Adopt Plans and Specifications for the Hatch Road PFF Channelization Project, Phase 1-B

The total anticipated cost for this project is \$3,000,000. The costs include the following:

<u>DESCRIPTION</u>	<u>ESTIMATED COMPLETION DATE</u>	<u>ESTIMATED COSTS</u>
Right-of-Way Acquisitions	Fall 2010	\$350,000
Design Engineering	Fall 2010	\$350,000
Construction	Spring 2011	\$2,300,000
	Total:	\$3,000,000

Hatch Road Channelization Project will be funded 100% by City/County Public Facility Fee (PFF) funds. At this time, \$5,000 is required for reproduction costs, advertisement costs and other agency costs associated with the bid process.

**DISCUSSION:**

In January 2004, the Board of Supervisors approved the Department of Public Works Road Congestion Relief Program. The Road Congestion Relief Program provides for the installation of traffic signals, left turn lanes and related improvements on selected roadways throughout the County. This program is funded by Public Facility Fees.

As approved by the Board of Supervisors, the program included the installation of left turn lanes and through lanes on Hatch Road at the intersections of Faith Home Road, Gilbert Road, Parks Road, Washington Road and Clinton Road.

Hatch Road is one of the County's most congested roadways and carries significant volumes of traffic. The Road Congestion Relief Program identified that Hatch Road should have left turn lanes installed to relieve congestion and increase capacity to ensure a minimum level of service in the future.

The consideration of "level of service", or LOS, is very important in traffic planning. The most common scale for measuring service describes traffic conditions in a range from A to F. Level "F", for example, describes delays in excess of 60 seconds per vehicle and arrival flow rates exceeding the capacity of the intersection. The minimum standard LOS the County seeks to maintain is "C" per the County General Plan.

Currently, the intersection of Hatch Road and Faith Home Road is operating at unacceptable LOS "D" during the AM and PM peak periods. To meet the minimum standard LOS, Public Works designers took into account the required design speed, the type of intersection, the configuration of the existing intersection and the alignment of the existing roads. The result of their analysis is the addition of left turn lanes on Hatch Road, and the addition of a through lane on the north side of Hatch Road. The north side of Hatch Road was selected as the existing Ceres Main Canal and lies immediately

Approval to Adopt Plans and Specifications for the Hatch Road PFF Channelization Project, Phase 1-B

south of Hatch Road. There is insufficient room to add a through lane between the existing roadway and the canal

A Negative Declaration for this project was approved and adopted by the Board of Supervisors on December 12, 2006.

Right-of-Way and utility relocations were completed in the Fall of 2010. Final Engineering Design was completed in the Fall of 2010 and the project is ready for advertisement.

**POLICY ISSUES:**

The Hatch Road Channelization Project will meet the Board's Priorities of providing A Safe Community and A Well Planned Infrastructure System by improving traffic safety on the County road system.

**STAFFING IMPACT:**

There is no staffing impact associated with this item.

**CONTACT PERSON:**

Matt Machado, Public Works Director. Telephone: (209) 525-4130.

DH: jg

L: \ROADS\9423-Hatch Rd (PFF Left Turn Channelization)\Adopt & Bid\_2.15.11

ATTACHMENTS AVAILABLE  
FROM YOUR CLERK

INDEX OF SHEETS

1. TITLE SHEET
2. GENERAL NOTES AND TRAFFIC CONTROL
3. IMPROVEMENT PLAN 1 - HATCH ROAD AT FAITH HOME ROAD & GILBERT ROAD
4. IMPROVEMENT PLAN 2 - HATCH ROAD AT PARKS ROAD
5. IMPROVEMENT PLAN 3 - HATCH ROAD AT WASHINGTON ROAD & CLINTON ROAD
6. IMPROVEMENT PLAN 4 - HATCH ROAD
7. TRAFFIC STRIPING 1 - HATCH ROAD AT FAITH HOME ROAD & GILBERT ROAD
8. TRAFFIC STRIPING 2 - HATCH ROAD AT PARKS ROAD & WASHINGTON ROAD
9. TRAFFIC STRIPING 3 - HATCH ROAD AT CLINTON ROAD
10. ROAD CROSS SECTION AND MISCELLANEOUS DETAILS

# STANISLAUS COUNTY DEPARTMENT OF PUBLIC WORKS

PLANS FOR THE CONSTRUCTION OF  
**HATCH ROAD PFF CHANNELIZATION PROJECT**  
(FAITH HOME ROAD TO CLINTON ROAD)  
PHASE 1-B  
W.D.I.D. NO. 5S50C340304

TO BE SUPPLEMENTED BY STATE OF CALIFORNIA  
DEPARTMENT OF TRANSPORTATION STANDARD PLANS  
DATED MAY 2006 AND ALL ADDENDA THERETO

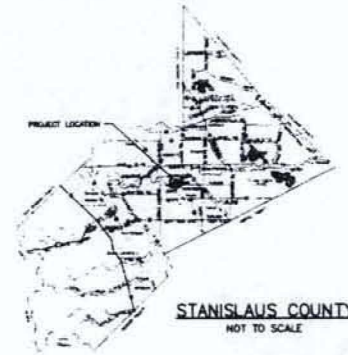

STATE OF CALIFORNIA  
DEPARTMENT OF TRANSPORTATION  
STANDARD PLANS

A20A	A24D	A73B	D84
A20B	A62A	A87B	D88
A20D	A62E	D81	T3
A24B	A62F	D82	T11-17

GENERAL NOTES

1. THE CONTRACTOR SHALL POSSESS THE LICENSE(S) REQUIRED IN THE INVITATION TO BID & SPECIAL PROVISIONS.
2. ALL MATERIAL AND WORK SHALL CONFORM TO STANISLAUS COUNTY SPECIFICATIONS AND IMPROVEMENT STANDARDS. ALL IMPROVEMENTS ARE SUBJECT TO THE INSPECTION AND APPROVAL OF THE PUBLIC WORKS DEPARTMENT.
3. THE CONTRACTOR SHALL TAKE PRECAUTIONARY MEASURES TO PROTECT ALL UTILITIES. THE CONTRACTOR SHALL DO NO EXCAVATION UNTIL ALL UTILITY AGENCIES AND THE STANISLAUS COUNTY DEPARTMENT OF PUBLIC WORKS HAVE BEEN NOTIFIED AND HAVE BEEN GIVEN THE OPPORTUNITY TO MARK THEIR FACILITIES IN THE FIELD. THE CONTRACTOR SHALL CALL U.S.A. AT LEAST FORTY-EIGHT (48) HOURS PRIOR TO DOING ANY EXCAVATING.
4. THESE PLANS HAVE BEEN CHECKED BY THE STANISLAUS COUNTY DEPARTMENT OF PUBLIC WORKS AND/OR AUTHORIZED REPRESENTATIVE, BUT SUCH CHECKING AND/OR APPROVAL DOES NOT RELIEVE THE CONTRACTOR FROM HIS/HER RESPONSIBILITY TO CORRECT ERRORS, OMISSIONS, OR MAKE CHANGES REQUIRED BY CONDITIONS DISCOVERED IN THE FIELD DURING COURSE OF CONSTRUCTION.
5. ALL CONSTRUCTION SITE ACTIVITIES SHALL CONFORM TO THE STATE WATER RESOURCES CONTROL BOARD, NATIONAL POLLUTION DISCHARGE ELIMINATION SYSTEM (NPDES), WASTE DISCHARGE REQUIREMENTS FOR DISCHARGES OF STORM WATER RUNOFF ASSOCIATED WITH CONSTRUCTION ACTIVITY.
6. PRIOR TO INITIATING ANY CONSTRUCTION, THE CONTRACTOR SHALL VERIFY THAT ALL NECESSARY FEDERAL, STATE, AND LOCAL PERMITS HAVE BEEN OBTAINED.
7. CLIENT CONTACT

STANISLAUS COUNTY, DEPARTMENT OF PUBLIC WORKS  
DAVID LLAMON, (209) 525-4184

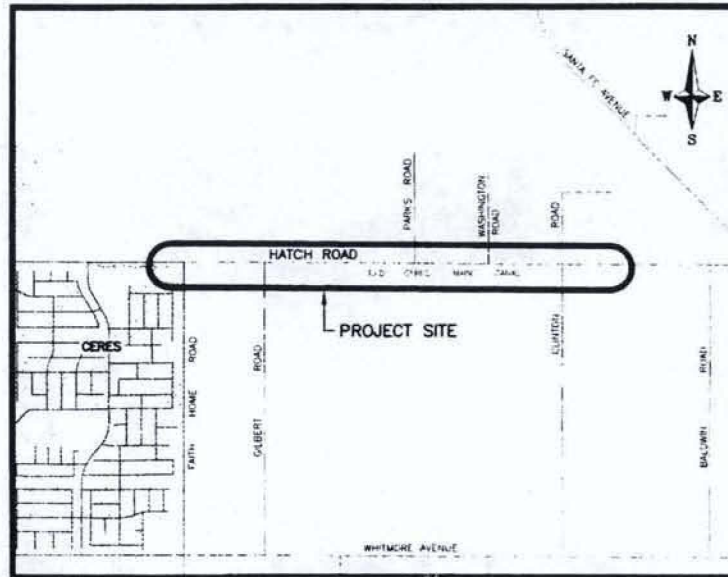

*Matt Machado* 2/4/11  
MATT MACHADO, P.E.  
DIRECTOR OF PUBLIC WORKS  
STANISLAUS COUNTY

*Glenn Gebhardt* 2/4/11  
GLENN GEBHARDT, P.E.  
CITY ENGINEER  
CITY OF CERES



NO.	REVISIONS	DATE	BY	NO.	REVISIONS	DATE	BY

APPROVED BY: *[Signature]*  
DAVID A. LLAMON, P.E. 00434  
DATE: 2/4/11

DRAWN	PS/DH
DESIGN	DH
CHECKED	DM
PROJECT	9423
SCALE	NOTED
DATE	2/4/11

**TITLE SHEET**  
HATCH ROAD PFF CHANNELIZATION PROJECT  
(FROM FAITH HOME ROAD TO CLINTON ROAD)  
PHASE 1-B



COUNTY OF STANISLAUS  
DEPARTMENT OF PUBLIC WORKS  
ENGINEERING DIVISION  
1716 MORGAN ROAD  
MODOESTO, CALIFORNIA 95358

SHEET OF  
1 10

**GENERAL NOTES:**

- 1. ALL CONSTRUCTION SHALL CONFORM TO THE STANISLAUS COUNTY STANDARD SPECIFICATIONS 2007 EDITION AND STATE OF CALIFORNIA DEPARTMENT OF TRANSPORTATION MAY 2002 STANDARD SPECIFICATIONS AND ALL AGENCIES THEREOF.
- 2. THE CONTRACTOR SHALL BE RESPONSIBLE FOR PROVIDING ALL REQUIRED CONSTRUCTION SIGNAGE.
- 3. ALL CONSTRUCTION FOR ALL STATES SHALL CONFORM TO THE STATE WATER RESOURCES CONTROL BOARD, NATIONAL POLLUTION DISCHARGE PERMITS, FEDERAL WASTE WATER DISCHARGE PERMITS AND THE REQUIREMENTS OF STATE WATER RIGHTS ASSOCIATED WITH CONSTRUCTION ACTIVITIES.
- 4. THE CONTRACTOR SHALL BE COMPLETE AND COMPLETELY RESPONSIBLE FOR OBTAINING, INSTALLING AND MAINTAINING ALL SIGNAGE, SIGNALS AND FLAGS NECESSARY TO SUPPORTING THE GENERAL PUBLIC AND TRAFFIC DURING THE PERFORMANCE OF THE WORK. THE RESPONSIBILITY SHALL EXTEND TO STRUCTURING AND ALL BE LIMITED TO NORMAL WORKING HOURS. THE USE OF FLAG MEN IS PROHIBITED AND CONSTRUCTION SIGNAGE SHALL COMPLY WITH THE CURRENT EDITION OF CALIFORNIA MUTCD, PART 4 AND THE PROJECT SPECIFICATIONS.
- 5. THE CONTRACTOR IS RESPONSIBLE FOR DETERMINING THE EXISTING LOCATION OF ALL EXISTING UTILITIES AND FOR THE PROTECTION OF ANY DEGRADATION OF ALL SERVICES DUE TO THE CONSTRUCTION OPERATIONS. THE CONTRACTOR SHALL CONTACT UNDERGROUND SERVICE UTILITIES BY CONTACTING THE MESSAGES BOARD BEFORE WORK IS TO BEGIN. THESE UTILITIES ARE BURIED APPROXIMATELY 18" BELOW SURFACE AND SHALL BE LOCATED BY FOLLOWING STATE LAWS TO USE AN ELECTRODE LOCATOR.
- 6. IT IS THE RESPONSIBILITY OF THE CONTRACTOR TO FAMILIARIZE THEMSELVES WITH ALL CONSTRUCTION DOCUMENTS, RELEVANT STATUTES, ACTS, RULES AND REGULATIONS RELATING TO THIS PROJECT.
- 7. WHERE IT IS BELIEVED THAT MUCH OF THE INFORMATION PERTAINING TO CONDITIONS WHICH MAY AFFECT THE COST OF INSTALLATION OF THE WORK MAY BE FOUND IN THE CONSTRUCTION DOCUMENTS, STANDARD CONTRACT (NOT BEING), THE COMPLETENESS OR ACCURACY OF SUCH INFORMATION. THE CONTRACTOR SHALL ASCERTAIN THE EXTENT OF ANY CONDITIONS AFFECTING THE COST OF INSTALLATION. WHERE NECESSARY, THESE SHALL BE INDICATED BY AN APPROPRIATE EXPLANATION OF THE WORK.
- 8. CONSTRUCTION SHALL THROUGH ALL WORK NECESSARY TO COMPLETE THE CONTRACT IN A SATISFACTORY MANNER. CRASHES, COLLISIONS, DAMAGE TO PROPERTY OR PERSONS SHALL BE REPORTED IMMEDIATELY TO THE PUBLIC WORKS DEPARTMENT.
- 9. EXISTING IMPROVEMENTS SHALL BE AT THE JOB SITE, FOR WORK AND OPERATING OPERATIONS IN ACCORD WITH THE CONTRACT DOCUMENTS. THE CONTRACTOR SHALL BE RESPONSIBLE FOR THE MAINTENANCE AND PROTECTION OF ALL EXISTING UTILITIES.
- 10. CONSTRUCTION SHALL BE SUBJECT TO CHANGE AND DELAY OR DELAYS IN THE CONSTRUCTION DOCUMENTS NOTED BY THE DESIGN ENGINEER AT WORKING.
- 11. THE CONTRACTOR SHALL MAINTAIN THE LEAST OF WORK AND EXISTING TRAFFIC THAT MAY BE IN THE PATH.
- 12. ALL EXISTING CHANNEL COURSES ON THE PROJECT SITE MUST REMAIN AS EXISTING, EXCEPT FOR NECESSARY STORM CONDITIONS. APPROVED FLOOD CONTROL MEASURES AND TEMPORARY DRAINAGE MEASURES MUST BE USED TO PREVENT ADVERSE IMPACTS TO EXISTING WORK.
- 13. THE CONTRACTOR IS RESPONSIBLE FOR OBTAINING ALL NECESSARY PERMITS AND ALL ASSOCIATED SIGNAGE, SIGNALS AND FLAGS FROM ALL AGENCIES AND DEPARTMENTS. THE CONTRACTOR SHALL ALSO MAINTAIN ALL NECESSARY SIGNAGE, SIGNALS AND FLAGS AND TO MAINTAIN THE SYSTEM DURING ALL NECESSARY OPERATIONS. THE USE OF FLAG MEN SHALL BE LIMITED TO NORMAL WORKING HOURS. THE USE OF FLAG MEN SHALL BE LIMITED TO NORMAL WORKING HOURS. THE USE OF FLAG MEN SHALL BE LIMITED TO NORMAL WORKING HOURS.
- 14. CONSTRUCTION SHALL MAINTAIN A SAFE AND UNINTERRUPTED FLOW OF TRAFFIC THROUGHOUT THE WORK SITE AT ALL TIMES.
- 15. EXISTING TRAFFIC SIGNALS SHALL BE MAINTAINED BY THE CONTRACTOR AS DIRECTED BY THE RESIDENT ENGINEER.

**TRAFFIC CONTROL NOTES:**

- 1. IF NECESSARY, EXISTING TRAFFIC SIGNALS SHALL BE REMOVED AND TEMPORARY TRAFFIC SIGNALS SHALL BE INSTALLED WHEN LANE CLOSURE IS REQUIRED IN ORDER TO MAINTAIN 12-FOOT TRAFFIC LANE EDGEWIDE STRIPPING SHALL BE MAINTAINED AT ALL TIMES.
- 2. THE WORKZONE SHALL BE PROTECTED WITH TEMPORARY BARRIERS AND SHALL BE TO BE MAINTAINED THROUGHOUT THE WORKING HOURS.
- 3. ACCESS TO DRIVEWAYS MUST BE PROTECTED AND MAINTAINED AT ALL TIMES UNTIL PRIOR APPROVAL BY THE INCIDENT ENGINEER, PUBLIC WORKS ENGINEER.
- 4. ALL MAINTENANCE AND WORK IN TRAFFIC CONTROL SHALL BE THE CONTRACTOR'S RESPONSIBILITY.
- 5. TRAFFIC CONTROL SIGNAGE SHALL BE PLACED APPROPRIATELY EACH END OF THE CONSTRUCTION ZONE AS INDICATED.
- 6. ALL SIGNALS AND ROAD SIGN TRAFFIC CONTROL SHALL BE THE CONTRACTOR'S RESPONSIBILITY.
- 7. TRAFFIC CONTROL SHALL CONFORM TO CALIFORNIA STANDARDS. PREPARATION OF A TRAFFIC CONTROL PLAN SHALL BE THE RESPONSIBILITY OF THE CONTRACTOR AND SHALL BE SUBMITTED FOR APPROVAL TO THE PUBLIC WORKS DEPARTMENT PRIOR TO THE START OF CONSTRUCTION.

**CONSTRUCTION SIGN LEGEND**

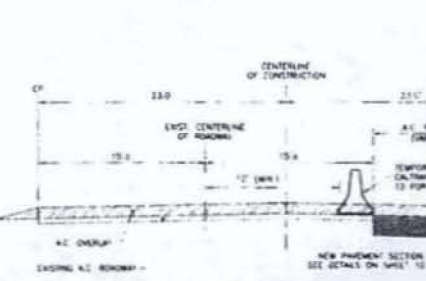
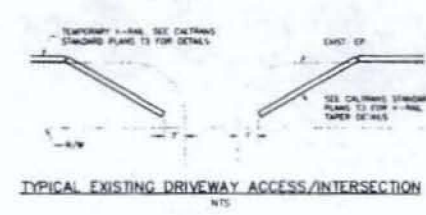
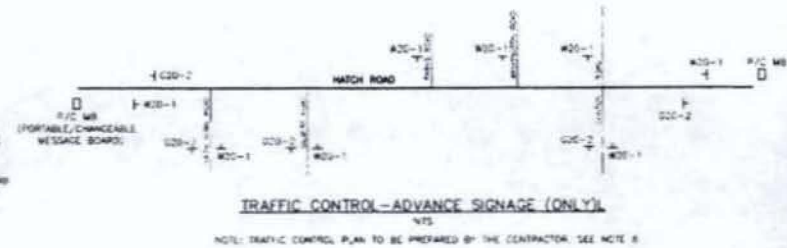
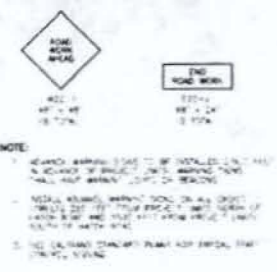

**BENCH MARK:**

LOCATED ON THE NORTH SIDE OF HATCH ROAD ON INTERSECTION WITH OLD HATCH ROAD, 100' NORTH OF HATCH ROAD, 100' NORTH OF HATCH ROAD, 100' NORTH OF HATCH ROAD, 100' NORTH OF HATCH ROAD.

	APPROVED BY  DATE 3/1/11	DESIGN PS/SH CHECKED SH PROJECT 0423 SCALE NOTES DATE 2/4/11	<b>GENERAL NOTES AND TRAFFIC CONTROL</b> <b>HATCH ROAD PFF CHANNELIZATION PROJECT</b> (FROM FAITH HOME ROAD TO CLINTON ROAD) PHASE 1-B	 COUNTY OF STANISLAUS DEPARTMENT OF PUBLIC WORKS ENGINEERING DIVISION 1716 MORGAN ROAD MODOCITO, CALIFORNIA 95358
NO REVISIONS DATE BY NO. REVISIONS DATE BY			SHEET 2 OF 10	



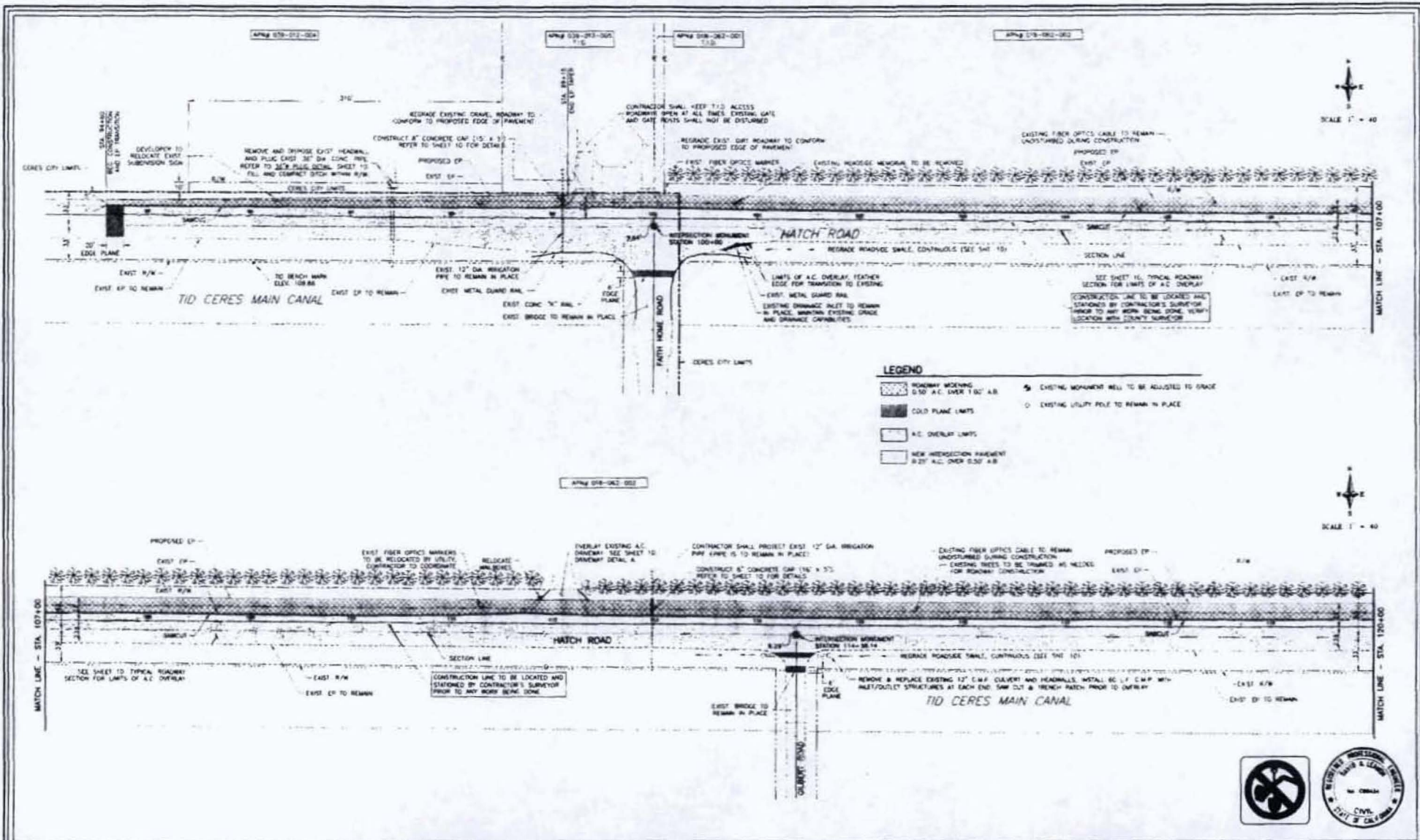

- LEGEND**
- ROADWAY WIDENING 0.50' A.C. OVER 120' A.B.
  - COLD PLANE LIMITS
  - A.C. OVERLAY LIMITS
  - NEW INTERSECTION PAVEMENT 0.25' A.C. OVER 0.50' A.B.
  - EXISTING MONUMENT WELL TO BE ADJUSTED TO GRADE
  - EXISTING UTILITY POLE TO REMAIN IN PLACE

APR 07-01-04		APR 07-01-05		APR 08-02-01		APR 07-02-02	
CERES CITY LIMITS		CERES CITY LIMITS		CERES CITY LIMITS		CERES CITY LIMITS	
MATCH LINE - STA. 107+00		MATCH LINE - STA. 107+400		MATCH LINE - STA. 107+00		MATCH LINE - STA. 107+400	
SECTION LINE		SECTION LINE		SECTION LINE		SECTION LINE	
TID CERES MAIN CANAL		HATCH ROAD		TID CERES MAIN CANAL		HATCH ROAD	
FAITH HOME ROAD		CLINTON ROAD		FAITH HOME ROAD		CLINTON ROAD	
MATCH LINE - STA. 107+00		MATCH LINE - STA. 107+400		MATCH LINE - STA. 107+00		MATCH LINE - STA. 107+400	

APPROVED BY: DAVID A. JENSEN PE 60434 DATE: 2/14/11	DRAWN: PS/DH DESIGN: GH CHECKED: GH PROJECT: 0423 SCALE: NOTES DATE: 2/14/11	<b>IMPROVEMENT PLAN 1 - FAITH HOME ROAD AND GILBERT ROAD HATCH ROAD PFF CHANNELIZATION PROJECT (FROM FAITH HOME ROAD TO CLINTON ROAD) PHASE 1-B</b>	 <b>COUNTY OF STANISLAUS</b> DEPARTMENT OF PUBLIC WORKS ENGINEERING DIVISION 1716 MORGAN ROAD MODESTO, CALIFORNIA 95358															
<table border="1" style="width: 100%; border-collapse: collapse;"> <tr> <th>NO.</th> <th>REVISIONS</th> <th>DATE</th> <th>BY</th> <th>NO.</th> <th>REVISIONS</th> <th>DATE</th> <th>BY</th> </tr> <tr> <td> </td> <td> </td> <td> </td> <td> </td> <td> </td> <td> </td> <td> </td> <td> </td> </tr> </table>		NO.	REVISIONS	DATE	BY	NO.	REVISIONS	DATE	BY									SHEET OF <b>3</b> OF <b>10</b>
NO.	REVISIONS	DATE	BY	NO.	REVISIONS	DATE	BY											

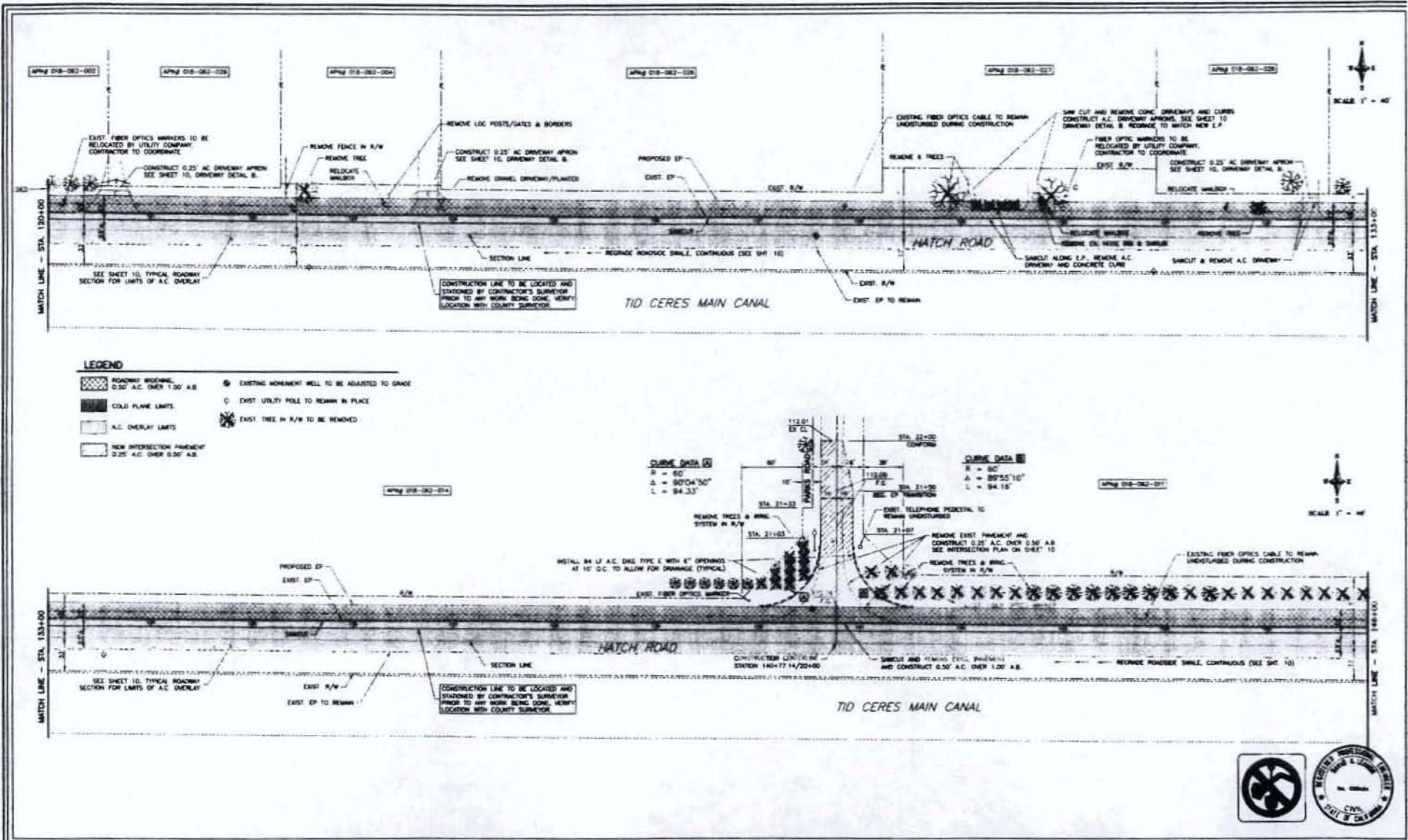

NO.	REVISIONS	DATE	BY	NO.	REVISIONS	DATE	BY

APPROVED BY: *[Signature]*  
 GREG A. LARSEN PC 00434  
 DATE: 2/14/11

DRAWN	PL/DH
DESIGN	DH
CHECKED	DH
PROJECT	9423
SCALE	NOTED
DATE	2/14/11

**IMPROVEMENT PLAN 2 - PARKS ROAD**  
 HATCH ROAD PFF CHANNELIZATION PROJECT  
 (FROM FAITH HOME ROAD TO CLINTON ROAD)  
 PHASE 1-B



COUNTY OF STANISLAUS  
 DEPARTMENT OF PUBLIC WORKS  
 ENGINEERING DIVISION  
 1718 MORGAN ROAD  
 MODESTO, CALIFORNIA 95336



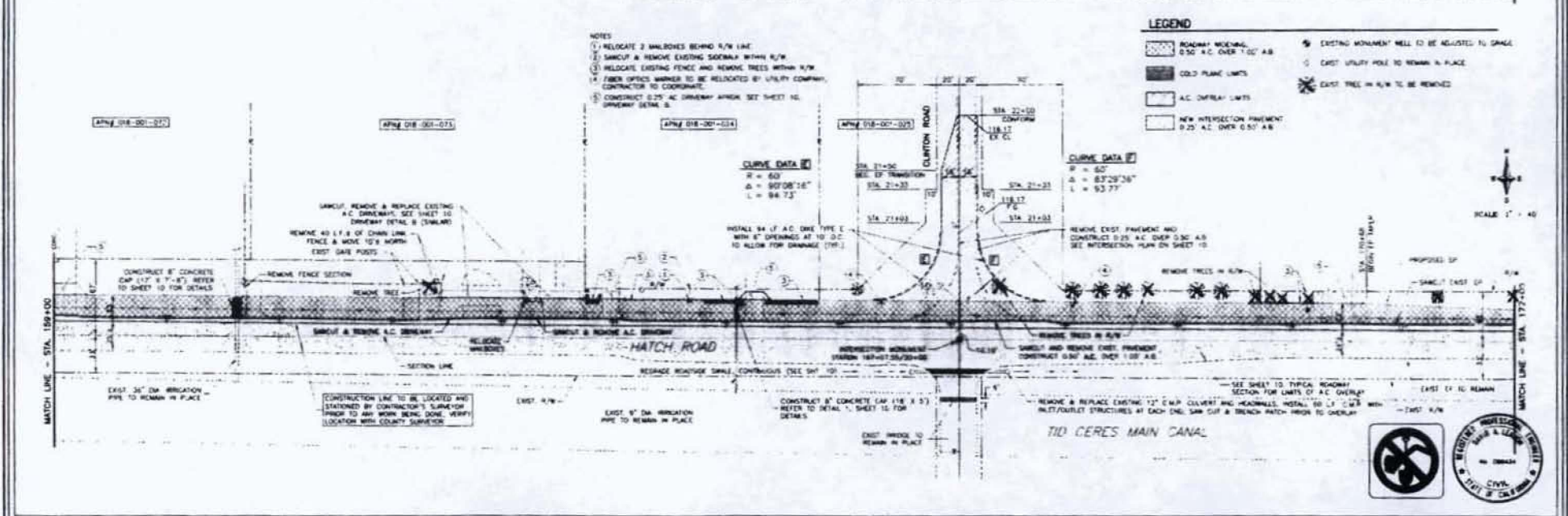
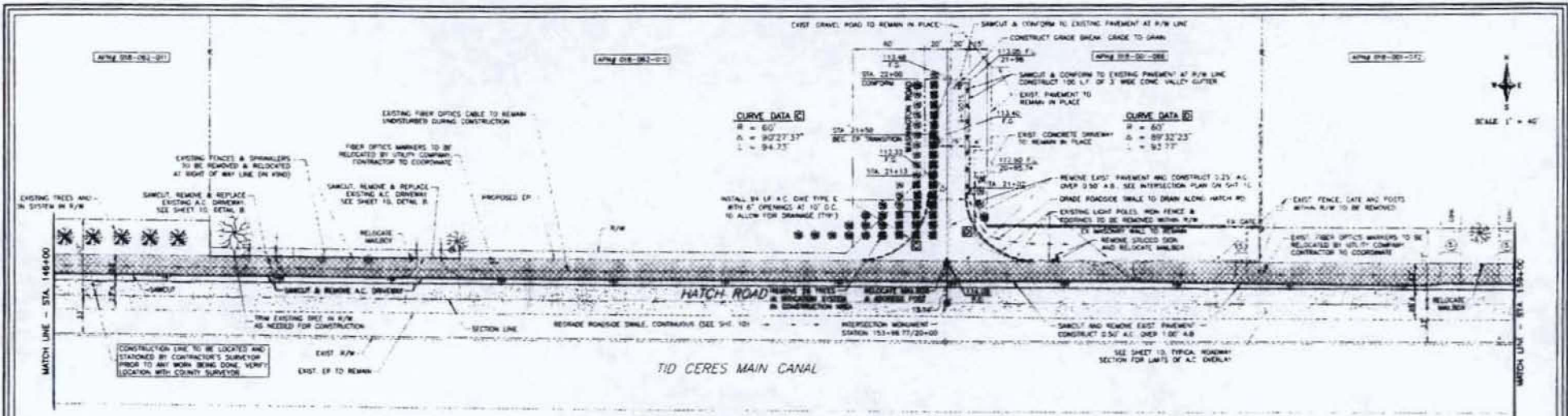

- NOTES
1. RELOCATE 2 MANHOLES BEHIND R/W LINE.
  2. SAWCUT & REMOVE EXISTING SIDEWALK WITHIN R/W.
  3. RELOCATE EXISTING FENCE AND REMOVE TREES WITHIN R/W.
  4. FIBER OPTICS WANNERS TO BE RELOCATED BY UTILITY COMPANY, CONTRACTOR TO COORDINATE.
  5. CONSTRUCT 0.25' AC DRIVEWAY APRON, SEE SHEET NO. DRIVEWAY DETAIL B.

- LEGEND
- ROADWAY WIDENING, 0.50' A.C. OVER 1.00' A.B.
  - COLD PLANE LIMITS
  - A.C. OVERLAY LIMITS
  - NEW INTERSECTION PAVEMENT 0.25' A.C. OVER 0.50' A.B.
  - EXISTING MONUMENT WELL TO BE ADJUSTED TO GRADE
  - EXIST UTILITY POLE TO REMAIN IN PLACE
  - EXIST TREE IN R/W TO BE REMOVED

NO.	REVISIONS	DATE	BY	NO.	REVISIONS

APPROVED BY:

DAVID A. FLEMONS PE 80434

DATE: 7/4/11

DRAWN	PS/DP
DESIGN	DH
CHECKED	DH
PROJECT	8423
SCALE	NOTED
DATE	7/4/11

**IMPROVEMENT PLAN 3 - WASHINGTON ROAD AND CLINTON ROAD HATCH ROAD PFF CHANNELIZATION PROJECT (FROM FAITH HOME ROAD TO CLINTON ROAD)**

PHASE 1-B

COUNTY OF STANISLAUS  
DEPARTMENT OF PUBLIC WORKS  
ENGINEERING DIVISION  
1718 MORGAN ROAD  
MODESTO, CALIFORNIA 95358

SHEET 04  
5 10



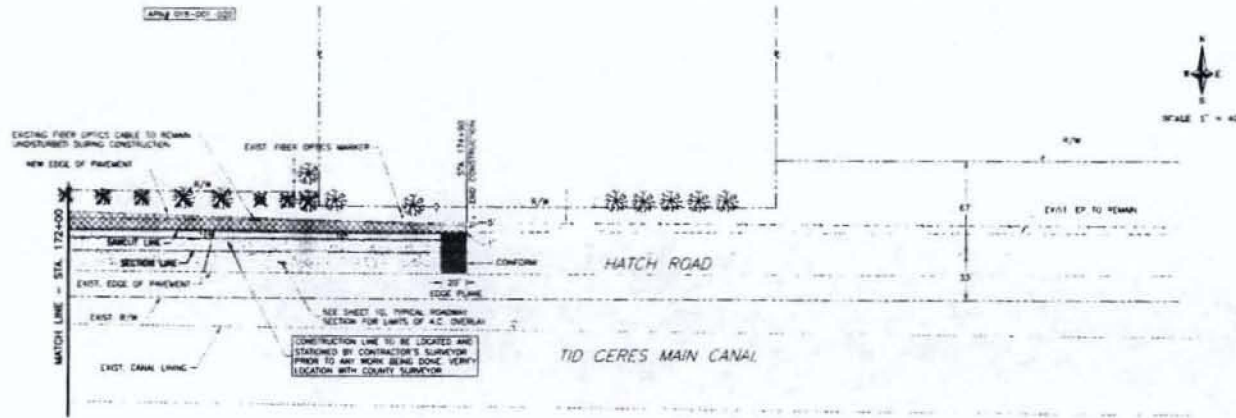

**LEGEND**

- ROADWAY WIDTHING, 0.50 AC OVER 150' A.W.
- COLD PLANE LIMITS
- A.C. OVERLAY LIMITS
- EXIST. UTILITY POLE TO REMAIN IN PLACE
- EXIST. TREE IN R/W TO BE REMOVED



NO.	REVISIONS	DATE	BY	NO.	REVISIONS	DATE	BY

APPROVED BY  
  
 DAVID A. JENSEN PE 02844  
 DATE 2/4/11

DRAWN	PL/DH
DESIGN	DH
CHECKED	DH
PROJECT	9423
SCALE	NOTED
DATE	2/4/11

**IMPROVEMENT PLAN 4**  
 HATCH ROAD PFF CHANNELIZATION PROJECT  
 (FROM FAITH HOME ROAD TO CLINTON ROAD)  
 PHASE 1-B



COUNTY OF STANISLAUS  
 DEPARTMENT OF PUBLIC WORKS  
 ENGINEERING DIVISION  
 1718 MORGAN ROAD  
 MODESTO, CALIFORNIA 95336

SHEET OF  
 6 10

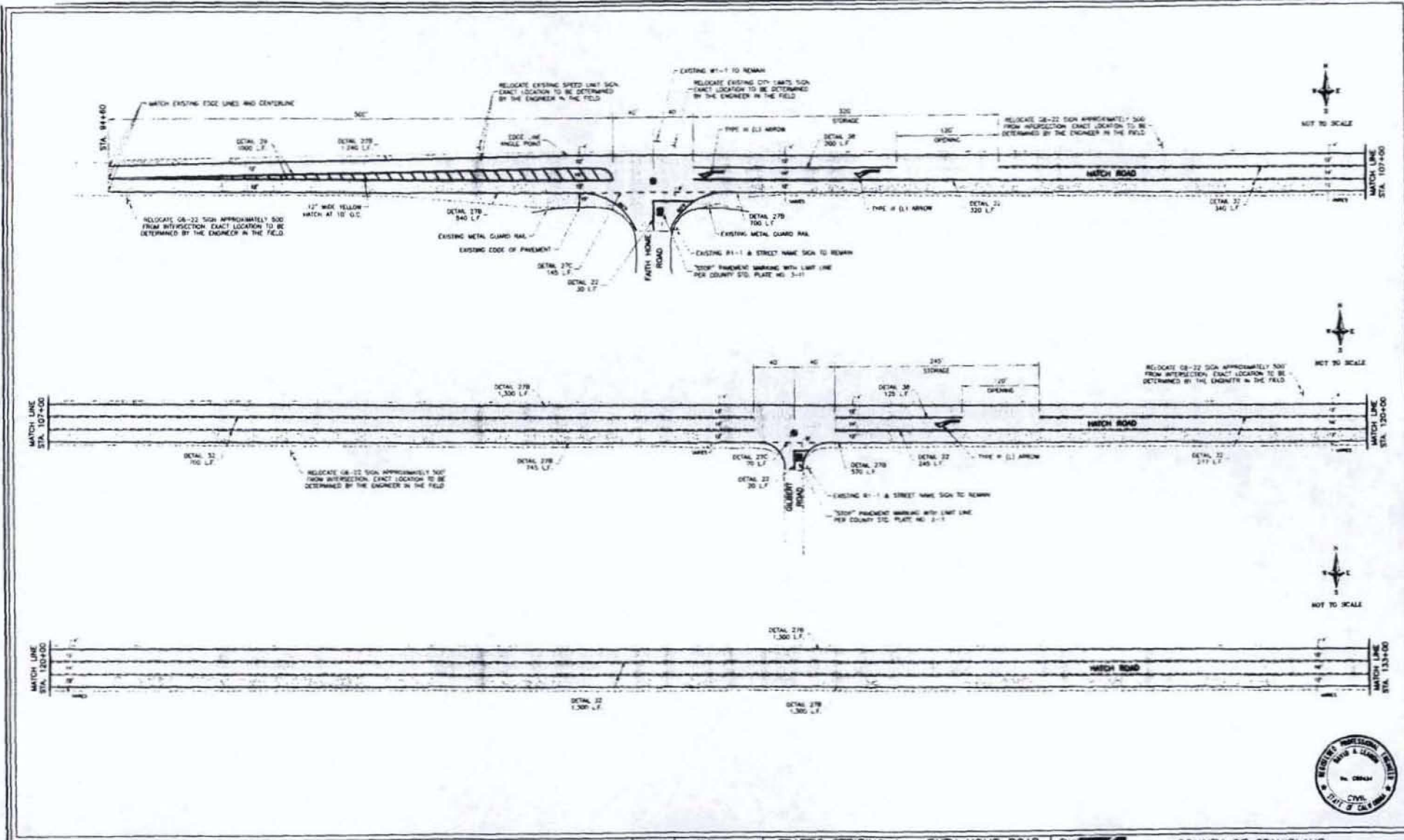

NO.	REVISIONS	DATE	BY	NO.	REVISIONS	DATE	BY

APPROVED BY: *[Signature]*  
 DAVID A. JENSEN PE 28424  
 DATE: 1/4/11

DRAWN	PS/DP
DESIGN	DP
CHECKED	DP
PROJECT	8423
SCALE	NOTED
DATE	1/4/11

**TRAFFIC STRIPING 1 - FAITH HOME ROAD AND GILBERT ROAD**  
 HATCH ROAD PFF CHANNELIZATION PROJECT  
 (FROM FAITH HOME ROAD TO CLINTON ROAD)  
 PHASE 1-B



COUNTY OF STANISLAUS  
 DEPARTMENT OF PUBLIC WORKS  
 ENGINEERING DIVISION  
 1716 MORGAN ROAD  
 MOKESTO, CALIFORNIA 95338

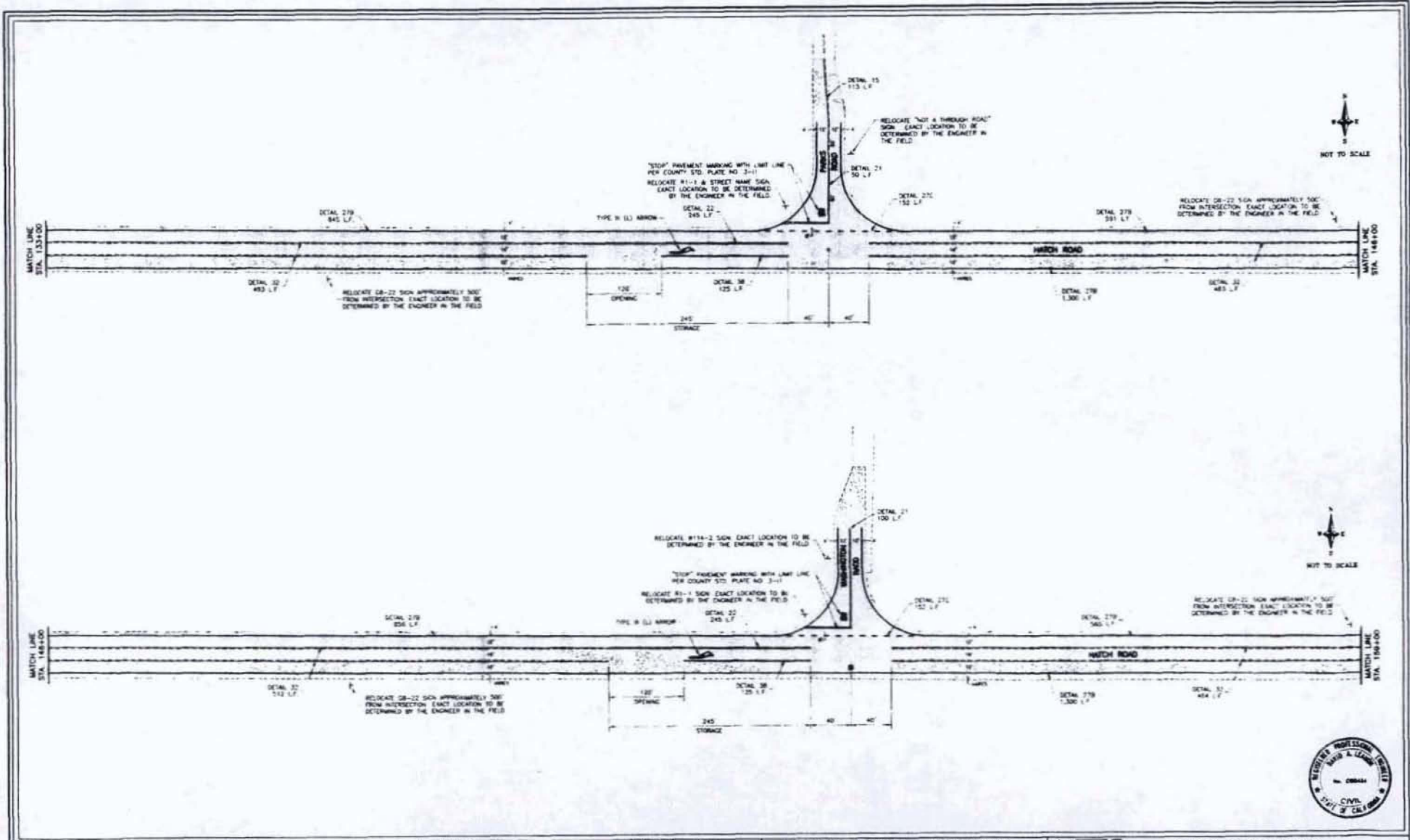

NO.	REVISION	DATE	BY	NO.	REVISIONS	DATE	BY

APPROVED BY  
  
 DAVID A. LEASON P.E. CIVIL  
 DATE: 1/14/71

DRAWN: PLS/DH  
 DESIGN: DM  
 CHECKED: DM  
 PROJECT: 8423  
 SCALE: NOTED  
 DATE: 1/14/71

TRAFFIC STRIPING 2 - PARKS ROAD  
 AND WASHINGTON ROAD  
 MATCH ROAD PFF CHANNELIZATION PROJECT  
 (FROM FAITH HOME ROAD TO CLINTON ROAD)  
 PHASE 1-B



COUNTY OF STANISLAUS  
 DEPARTMENT OF PUBLIC WORKS  
 ENGINEERING DIVISION  
 1716 MORGAN ROAD  
 MODESTO, CALIFORNIA 95358





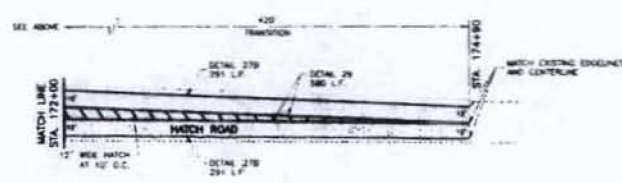
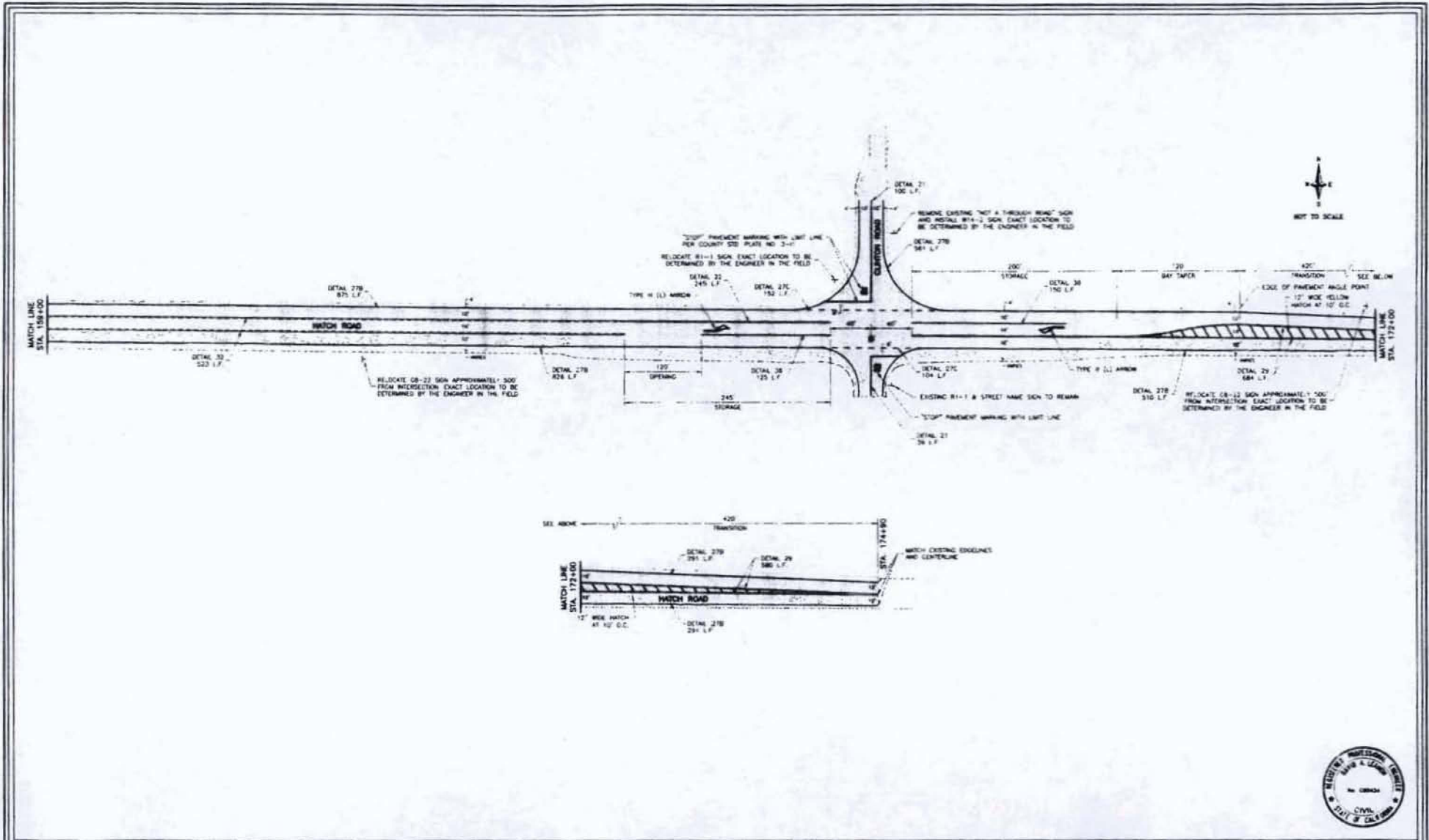

NO.	REVISIONS	DATE	BY	NO.	REVISIONS	DATE	BY

APPROVED BY:  
  
 DAVID A. LEMON PE 62843  
 DATE: 1/4/11

DRAWN	PL/CH
DESIGN	DM
CHECKED	DM
PROJECT	8423
SCALE	NOTED
DATE	1/4/11

**TRAFFIC STRIPING 3 - CLINTON ROAD**  
 HATCH ROAD PFF CHANNELIZATION PROJECT  
 (FROM FAITH HOME ROAD TO CLINTON ROAD)  
 PHASE 1-5



COUNTY OF STANISLAUS  
 DEPARTMENT OF PUBLIC WORKS  
 ENGINEERING DIVISION  
 1718 MORGAN ROAD  
 MODESTO, CALIFORNIA 95358

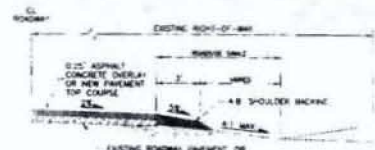

TYPICAL SHOULDER DETAIL

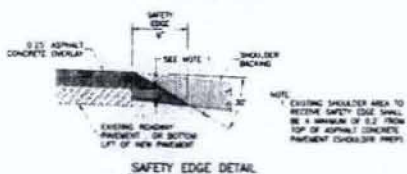

SAFETY EDGE DETAIL

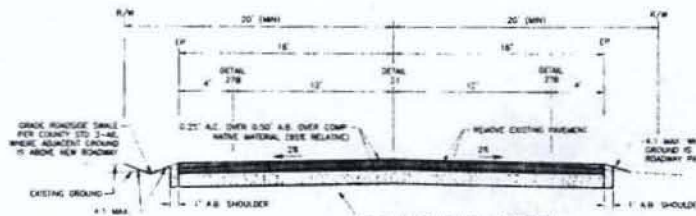

SECTION A-A  
TYPICAL INTERSECTION CROSS-SECTION

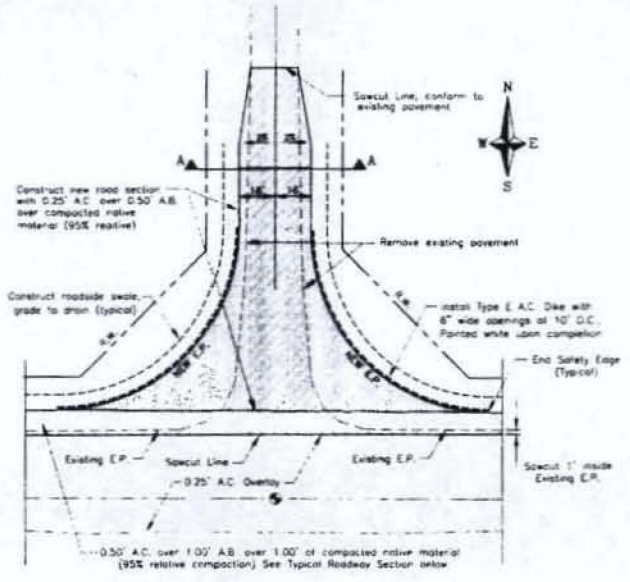

TYPICAL INTERSECTION IMPROVEMENT PLAN

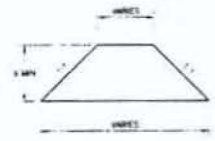

DRIVEWAY DETAIL A

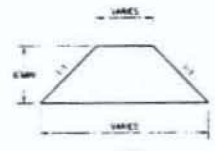

DRIVEWAY DETAIL B

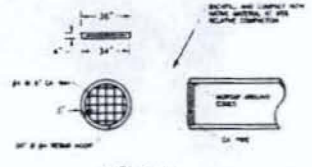
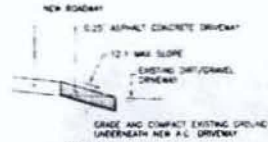

36\"/>

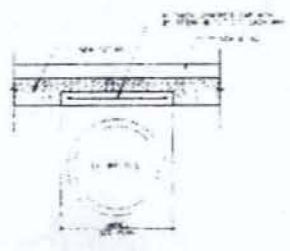

TYPICAL CONCRETE GAP

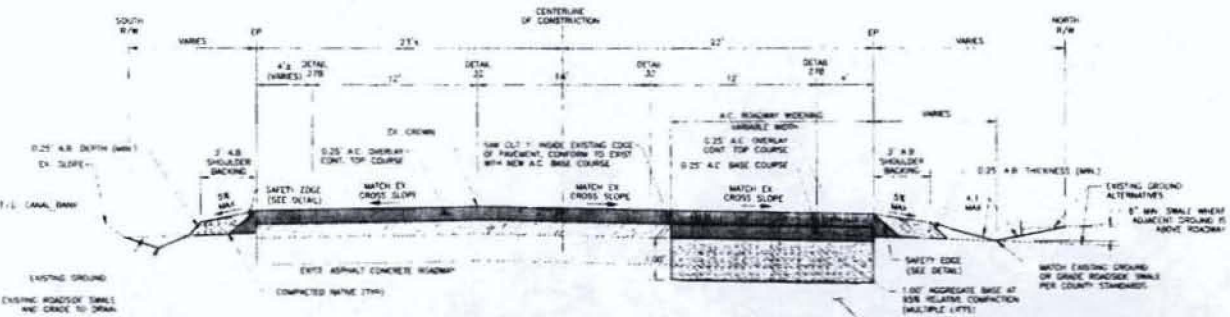

TYPICAL ROADWAY SECTION

NO.	REVISIONS	DATE	BY	NO.	REVISIONS	DATE	BY

APPROVED BY: *[Signature]*  
 CIVIL ENGINEER - P.E. 60548  
 DATE: 2/4/11

DRAWN	PL/SH
DESIGN	SH
CHECKED	SH
PROJECT	8423
SCALE	NOTED
DATE	2/4/11

ROAD CROSS SECTION  
 AND MISCELLANEOUS DETAILS  
 HATCH ROAD PFF CHANNELIZATION PROJECT  
 (FROM FAITH HOME ROAD TO CLINTON ROAD)  
 PHASE 1-B



COUNTY OF STANISLAUS  
 DEPARTMENT OF PUBLIC WORKS  
 ENGINEERING DIVISION  
 1716 MORGAN ROAD  
 MODESTO, CALIFORNIA 95358

2-15-11  
\*C-2

**DECLARATION OF PUBLICATION  
(C.C.P. S2015.5)**

**COUNTY OF STANISLAUS  
STATE OF CALIFORNIA**

I am a citizen of the United States and a resident Of the County aforesaid; I am over the age of Eighteen years, and not a party to or interested In the above entitle matter. I am a printer and Principal clerk of the publisher of **THE MODESTO BEE**, printed in the City of **MODESTO**, County of **STANISLAUS**, State of California, daily, for which said newspaper has been adjudged a newspaper of general circulation by the Superior Court of the County of **STANISLAUS**, State of California, Under the date of **February 25, 1951, Action No. 46453**; that the notice of which the annexed is a printed copy, has been published in each issue there of on the following dates, to wit:

Mar 02, 2011, Mar 09, 2011, Mar 16, 2011

INVITATION TO CONTRACTORS  
"Hatch Road PFF Channelization Project - Phase 1-B"

Owner is Stanislaus County, Modesto CA; Estimated construction cost for this project is \$2,300,000; Sealed bids are due before 2:00 P.M., March 23, 2011, to the Clerk of the Board of Supervisors, 1010 10th Street, Ste. 6500, Modesto, CA 95354; Project contact is Don Hicks at hicksd@stancounty.com or Fax No. (209) 541-2509. Work to be accomplished includes roadway widening, asphalt concrete overlay of existing roadway, placement of thermoplastic striping and pavement markings as directed by the Engineer and other such items not mentioned herein that are required by the plans and specifications. Plans and specifications are available for purchase from Modesto Reprographics, Modesto, CA, (209)544-2400 and can be viewed at www.modestoplanroom.com under "Public Jobs".

Pub Dates Mar. 2, 9, 16, 2011

BOARD OF SUPERVISORS  
2011 OCT 12 A 8:12

I certify (or declare) under penalty of perjury That the foregoing is true and correct and that This declaration was executed at

**MODESTO, California** on  
October 5th, 2011  
(By Electronic Facsimile Signature)

Marie Hickman