

1010 TENTH STREET, 3RD FLOOR
MODESTO, CA 95354



PHONE: (209) 525-7660
FAX: (209) 525-7643
www.stanislauslafco.org

Christine Ferraro Tallman
Clerk of the Board of Supervisors
Stanislaus County
1010 10th Street, Suite 6700
Modesto, CA 95354

DATE: May 28, 2010

TO: All Interested Parties

FROM: Sara Lytle-Pinhey, ^{SYP} Assistant Executive Officer

RE: **FINAL MUNICIPAL SERVICE REVIEW (MSR) AND SPHERE OF INFLUENCE (SOI) UPDATE FOR THE COUNTY SERVICE AREAS WITHIN STANISLAUS COUNTY**

Enclosed for your records is a copy of the Final Municipal Service Review (MSR) and Sphere of Influence (SOI) Update for the County Service Areas within Stanislaus County, which was approved by the Local Agency Formation Commission (LAFCO) on May 26, 2010.

Only minor changes were made since the previous update. The CSA boundaries and spheres of influence were affirmed as they currently exist and remain unchanged.

Should you have any questions, please contact our office at (209) 525-7660.

Enclosure: Final Municipal Service Review and Sphere of Influence Update (County Service Areas)
LAFCO Resolution 2010-07

2010 JUN - 1 A 11:54
BOARD OF SUPERVISORS

STANISLAUS COUNTY LOCAL AGENCY
FORMATION COMMISSION

RESOLUTION

DATE: May 26, 2010

NO. 2010-07

SUBJECT: MSR No. 10-01 and SOI Update No. 2010-02 – Making Written Determinations and Approving the Municipal Service Review and Sphere of Influence Updates for the County Service Areas

On the motion of Commissioner O'Brien, seconded by Commissioner Saletta, and approved by the following vote:

Ayes: Commissioners: Bublak, DeMartini, O'Brien, Saletta
Noes: Commissioners: None
Absent: Commissioners: Goeken, Lane
Ineligible: Commissioners: Chiesa, Freitas

THE FOLLOWING RESOLUTION WAS ADOPTED:

WHEREAS, a Municipal Service Review mandated by California Government Code Section 56430 and Sphere of Influence Updates mandated by California Government Code Section 56425, has been conducted for the County Service Areas, in accordance with the Cortese-Knox-Hertzberg Reorganization Act of 2000;

WHEREAS, at the time and in the form and manner provided by law, the Executive Officer has given notice of the May 26, 2010 public hearing by this Commission on this matter;

WHEREAS, the subject document is exempt from the provisions of the California Environmental Quality Act (CEQA) pursuant to Section 15061(b)(3) of the State CEQA Guidelines;

WHEREAS, Staff has reviewed all existing and available information for the County Service Areas and has prepared a report including recommendations therein, and related information as presented to and considered by this Commission;

WHEREAS, at the hearing, all persons present were given an opportunity to hear and be heard in respect to any matter in relation to the review, in evidence presented at the hearing;

WHEREAS, the following determinations are made in conformance with Government Code Section 56430 and local Commission policy:

1. Growth and Population Projections for the Affected Area: No specific issues relevant to this factor were identified.
2. Present and Planned Capacity of Public Facilities and Adequacy of Public Services, Including Infrastructure Needs or Deficiencies: At the present time, each of the CSAs has

Resolution 2010-07
MSR/SOI - County Service Areas
Page 2

the ability and the capacity to serve the existing service areas and currently have no unmet infrastructure needs or deficiencies.

3. Financial Ability of Agencies to Provide Services: The CSAs receive funding from special benefit assessments and/or a share of the ad valorem property tax. The rates established are based upon the costs to provide the extended services.
4. Status of, and Opportunities for, Shared Facilities: No opportunities for shared facilities have been identified. There is no overlapping or duplication of services within the Districts' boundaries, except for CSA No. 3 (Riverdale Park Tract), which is inactive, and is within the boundaries of the Riverdale Park Tract Community Services District.
5. Accountability for Community Service Needs, Including Governmental Structure and Operational Efficiencies: The County Service Areas are governed by the Board of Supervisors, with the exception of the CSA No. 15, which is under the jurisdiction of the City of Patterson. The Riverdale Park Tract Community Services District (CSD) was formed to replace CSA No. 3. The County intended to dissolve the CSA upon successful formation of the CSD. As this CSA has been inactive since its formation on May 18, 1982, the County should initiate its dissolution as intended in Board of Supervisors Resolution No. 84-1893, dated December 18, 1984.
6. Any Other Matter Related to Effective or Efficient Service Delivery, as Required by Commission Policy: It is reasonable to conclude that the Districts can adequately serve the areas under their jurisdiction.

WHEREAS, the following determinations are made in conformance with Government Code Section 56425 and local Commission policy in determining a Spheres of Influence for the County Service Areas:

1. Present and Planned Land Uses: The County retains the responsibilities for land use decisions within each of the CSA boundaries, with the exception of the Villa del Lago Commercial Center area, which was annexed to the City of Patterson (CSA No. 15). When development is approved in an unincorporated area within the County, the County requires the formation of a CSA to provide extended services necessary to serve the land uses within the development boundaries. Only those residents who benefit from services provided by the CSA pay for them, which are funded through an assessment levied on all parcels within the CSA boundaries.
2. Present and Probable Need for Public Facilities and Services in the Area: The CSAs are formed to provide specified services needed within their boundary. The present and probable need for services within the current County Service Areas is not expected to change.
3. Present Capacity of Public Facilities and Adequacy of Public Services Provided: The CSAs were formed to provide a specific level of service within their boundaries. There is also no expected change to the present capacity or adequacy of the public services currently provided by the CSAs. However, CSA No. 3 (Riverdale Park Tract) is recommended for

Resolution 2010-07
MSR/SOI - County Service Areas
Page 3

dissolution because it is inactive and the authorized (domestic water) services are being provided by another service provider (Riverdale Park Tract Community Services District).

4. Communities of Interest in the Area: There are no communities of interest within the CSAs boundaries.

WHEREAS, the County Services Areas provide extended services such as: storm drainage control, maintenance of parks and landscaping, and sheriff protection;

WHEREAS, pursuant to Government Code Section 56425(h), the range of services provided by the County Service Areas shall not be changed unless approved by this Commission; and

WHEREAS, no changes to the County Service Areas Spheres of Influence are proposed or contemplated through this review.

NOW, THEREFORE, BE IT RESOLVED by the Commission:

1. Certifies that the project is statutorily exempt under the California Environmental Quality Act (CEQA) pursuant to Section 15061(b)(3) of the State CEQA Guidelines.
2. Approves the Municipal Service Review prepared in compliance with State law for the review and update of the County Service Areas' Spheres of Influence, and written determinations prepared by the Staff and contained herein.
3. Determines that except as otherwise stated, no new or different function or class of services shall be provided by the County Service Areas, unless approved by the Commission.
4. Determines, based on presently existing evidence, facts, and circumstances filed and considered by the Commission, that the Spheres of Influence for the County Service Areas should be affirmed as they currently exist, as more specifically described on the maps contained within the Municipal Service Review document.
5. Directs the Executive Officer to circulate this resolution depicting the adopted Spheres of Influence Update to all affected agencies, including the Stanislaus County Planning and Community Development and Public Works Departments

ATTEST:

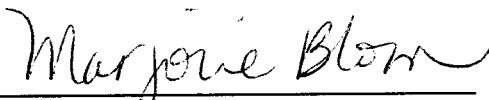

Marjorie Blom
Executive Officer

County Service Area (CSA) No. 1 "Fairview Park"

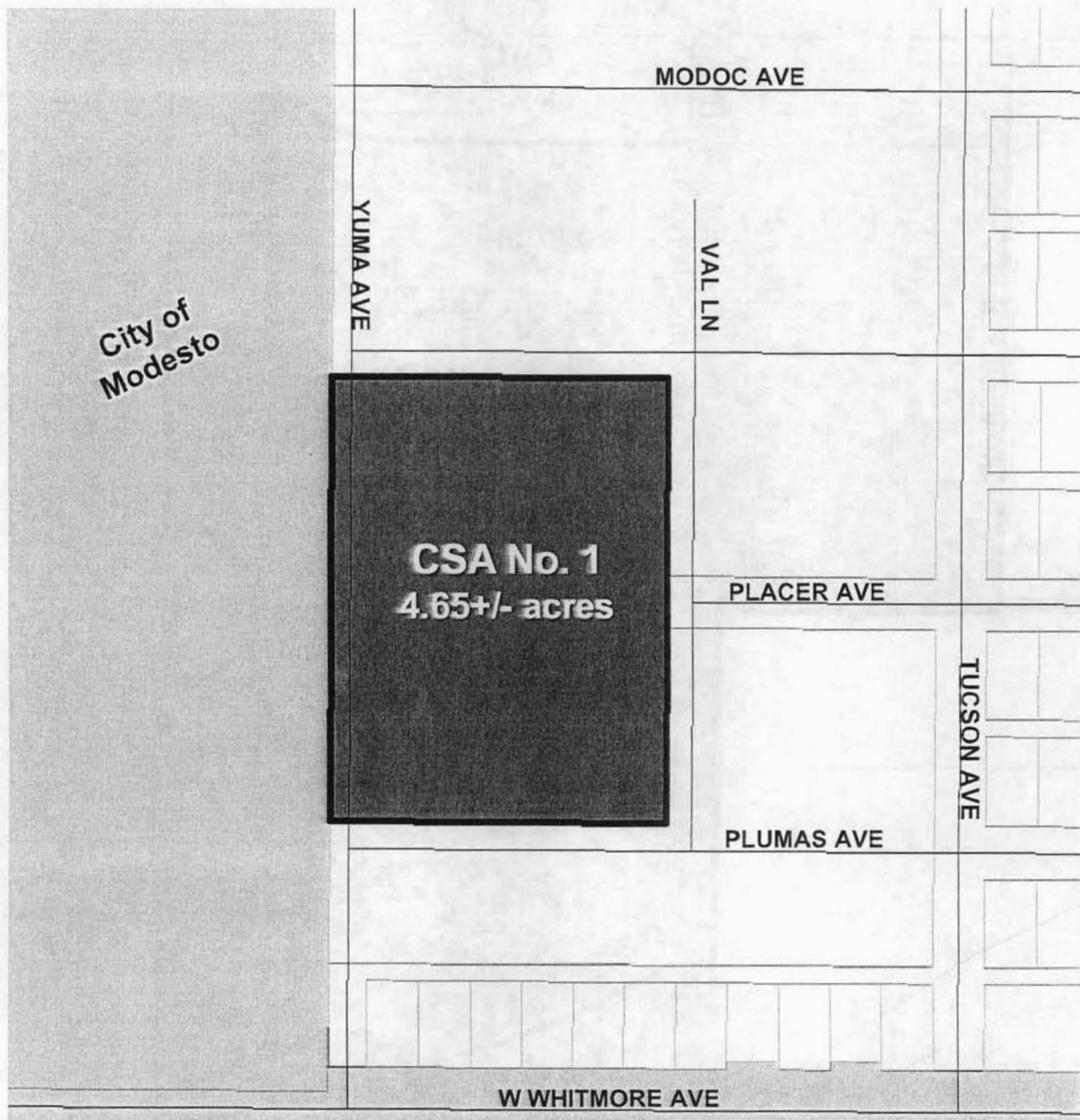

■ = CSA No. 1 Boundary (4.65+/- acres) ↗ = Sphere of Influence (coterminous)

Formation: 1970

Services Provided: Local park, recreation, or parkway facilities and services



Source: LAFCO Files, County GIS, April 30, 2010

County Service Area (CSA) No. 2 "Airport District Park"

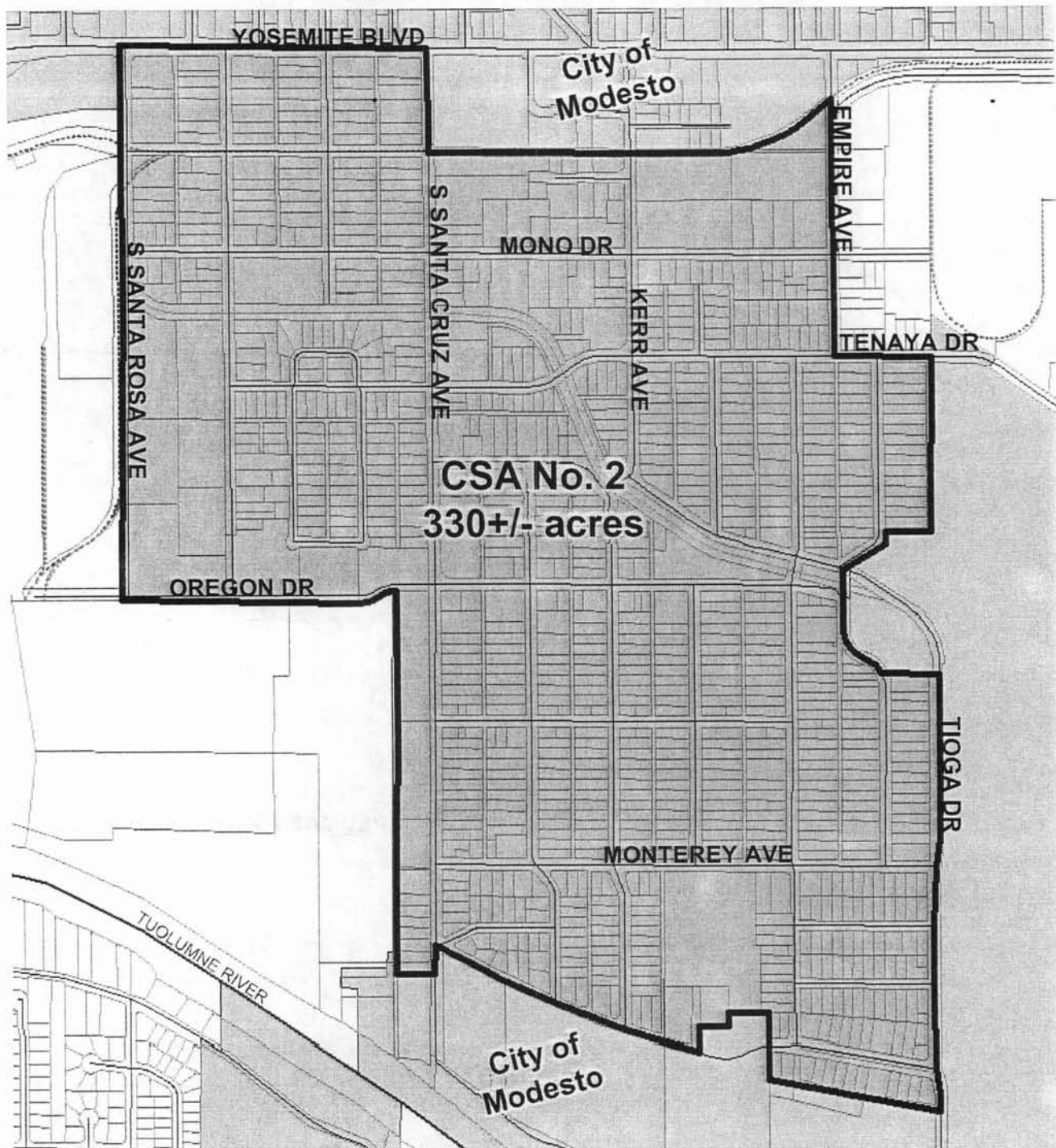

■ = CSA No. 2 Boundary (330+/-ac) - - - = Sphere of Influence (coterminous)

Formation: 1974 (Currently inactive)

Services Provided: Local park, recreation, or parkway facilities and services

Note: Existing CSA boundaries partially overlap the City Limits of Modesto.



County Service Area (CSA) No. 3 "Riverdale Park Tract"

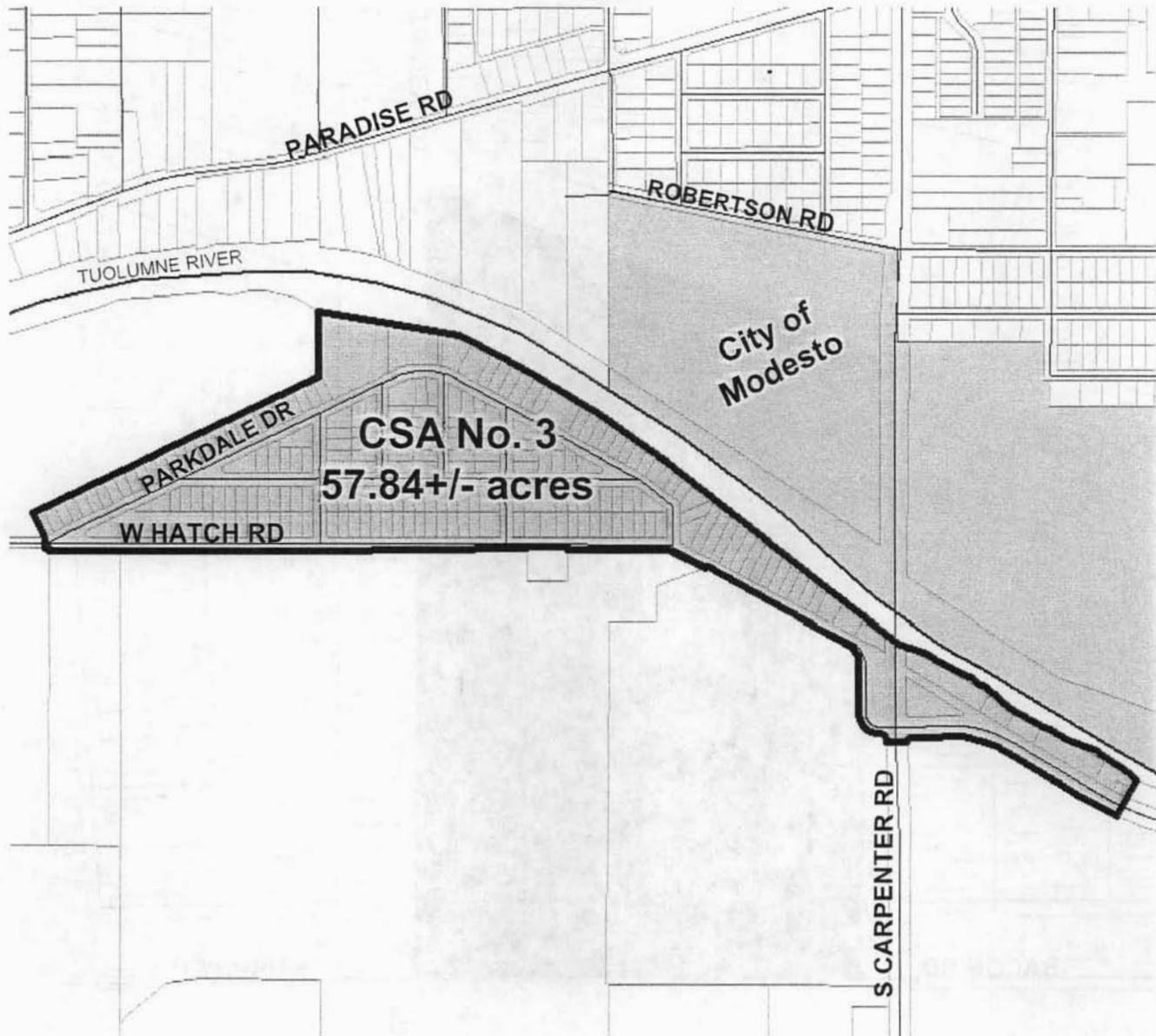

■ = CSA No. 3 Boundary (57.84 +/- ac) - - - = Sphere of Influence (coterminous)

Formation: 1982 (Currently inactive—See note below.)

Services Provided: Domestic Water



Note: Riverdale Park Tract Community Services District was formed in December 1984 to replace CSA No. 3. Dissolution of CSA No. 3 has been recommended.

Source: LAFCO Files, County GIS, April 30, 2010

County Service Area (CSA) No. 4 "Bristol Glen"

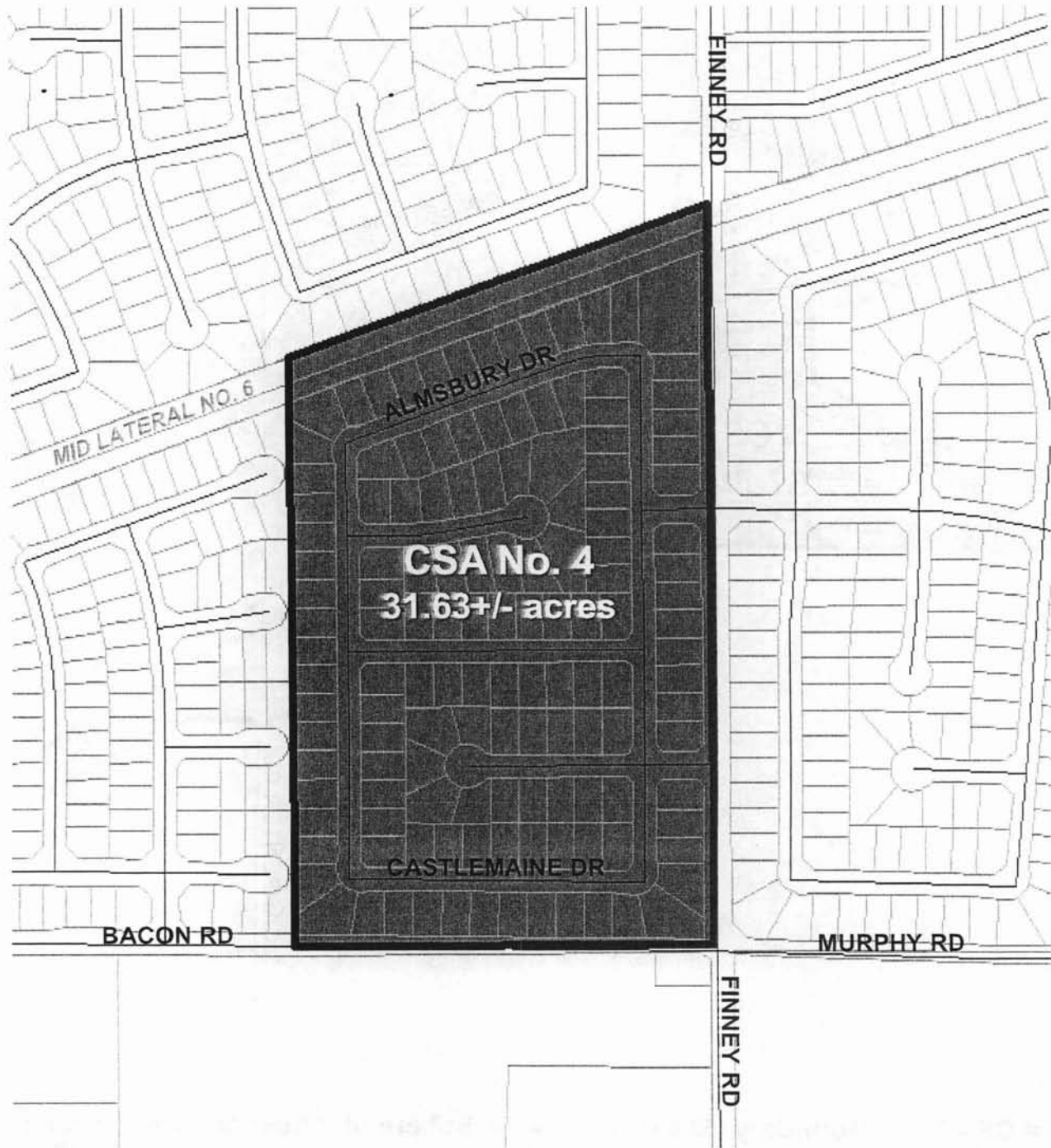

■ = CSA No. 4 Boundary (31.63+/-ac) — = Sphere of Influence (coterminous)

Formation: October 23, 1989
Services Provided: Storm drainage



Source: LAFCO Files, County GIS, April 30, 2010

County Service Area (CSA) No. 5 "Starlite Place"



■ = CSA No. 5 Boundary (39.08+/- acres) — = Sphere of Influence (coterminous)

Formation: March 14, 1990
Services Provided: Storm drainage



Source: LAFCO Files, County GIS, April 30, 2010

County Service Area (CSA) No. 7 "Modesto Auto Center"





■ = CSA No. 7 Boundary (11.40+/-ac) - - - = Sphere of Influence (coterminous)

Formation: July 12, 1990
Services Provided: Storm drainage

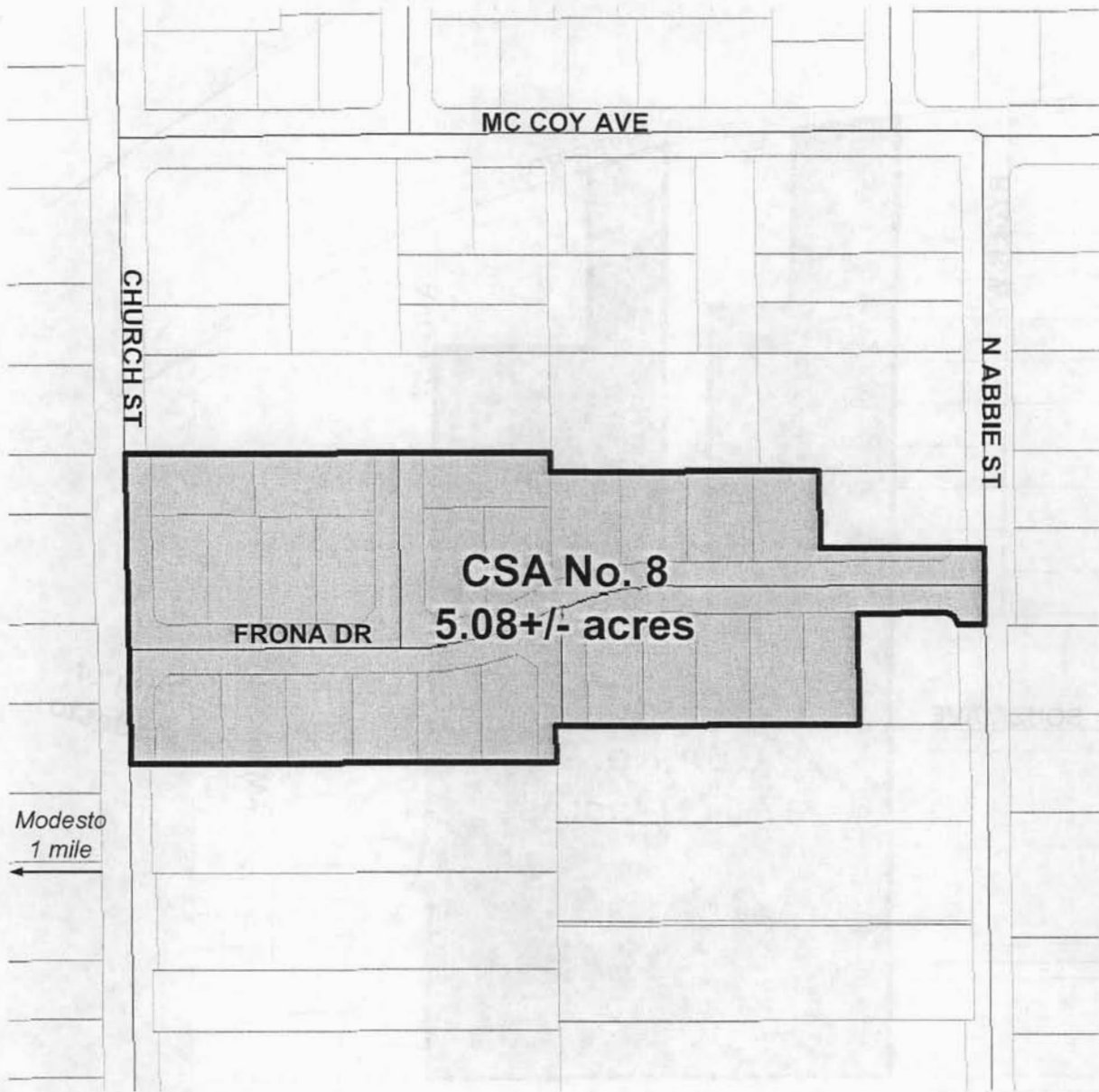

County Service Area (CSA) No. 8 "Honey Bee Estates"



 = CSA No. 8 Boundary (5.08+/-ac)

 = Sphere of Influence (coterminous)

Formation: October 12, 1990
Services Provided: Storm drainage



Source: LAFCO Files, County GIS, April 30, 2010

County Service Area (CSA) No. 9 "River Road / Souza"



■ = CSA No. 9 Boundary (17.17+/-ac) **—** = Sphere of Influence (coterminous)

Formation: December 17, 1990
Services Provided: Storm drainage



County Service Area (CSA) No. 10 "Salida"

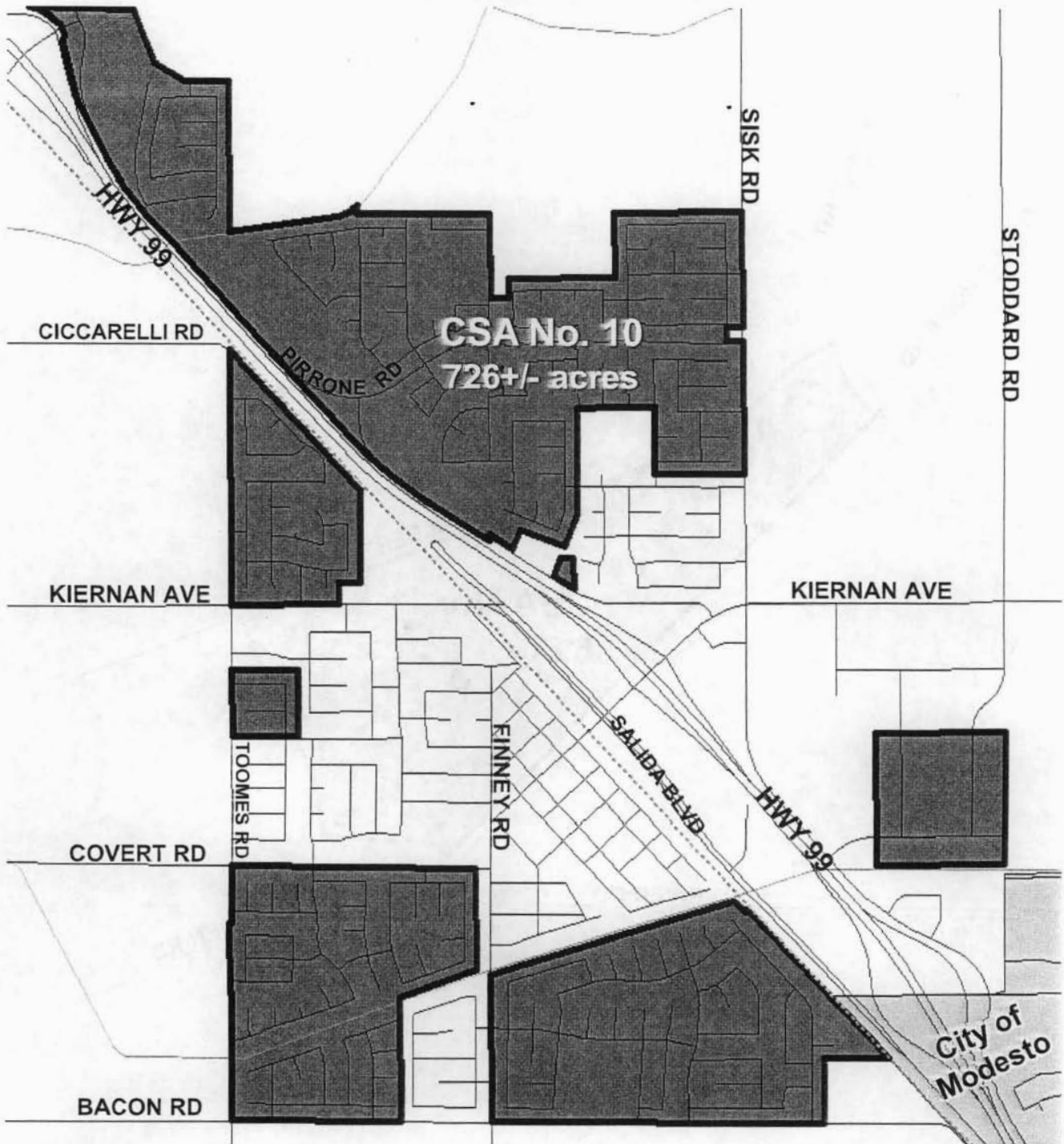

■ = CSA No. 10 Boundary (726+/-ac) ↗ = Sphere of Influence (coterminous)

Formation: November 8, 1990

Services Provided: Park services, streetscape / landscaping, library services,
police (sheriff) protection, and storm drainage



Source: LAFCO Files, County GIS, April 30, 2010

County Service Area (CSA) No. 11 "Gilbert Road"

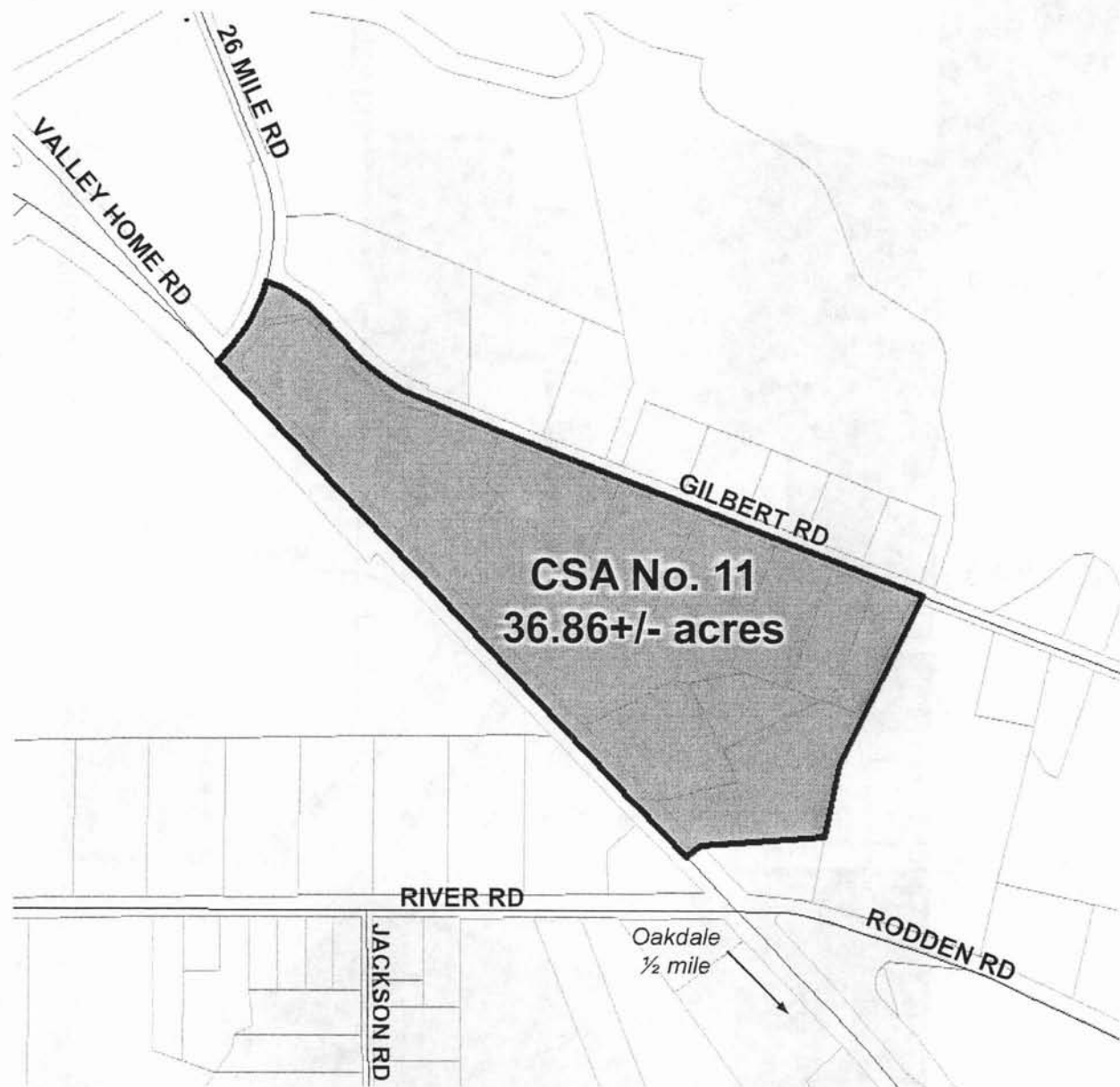

■ = CSA No. 11 Boundary (36.86 +/- ac) — = Sphere of Influence (coterminous)

Formation: April 3, 1991

Services Provided: Storm drainage



County Service Area (CSA) No. 12 "Peach Blossom Estates"

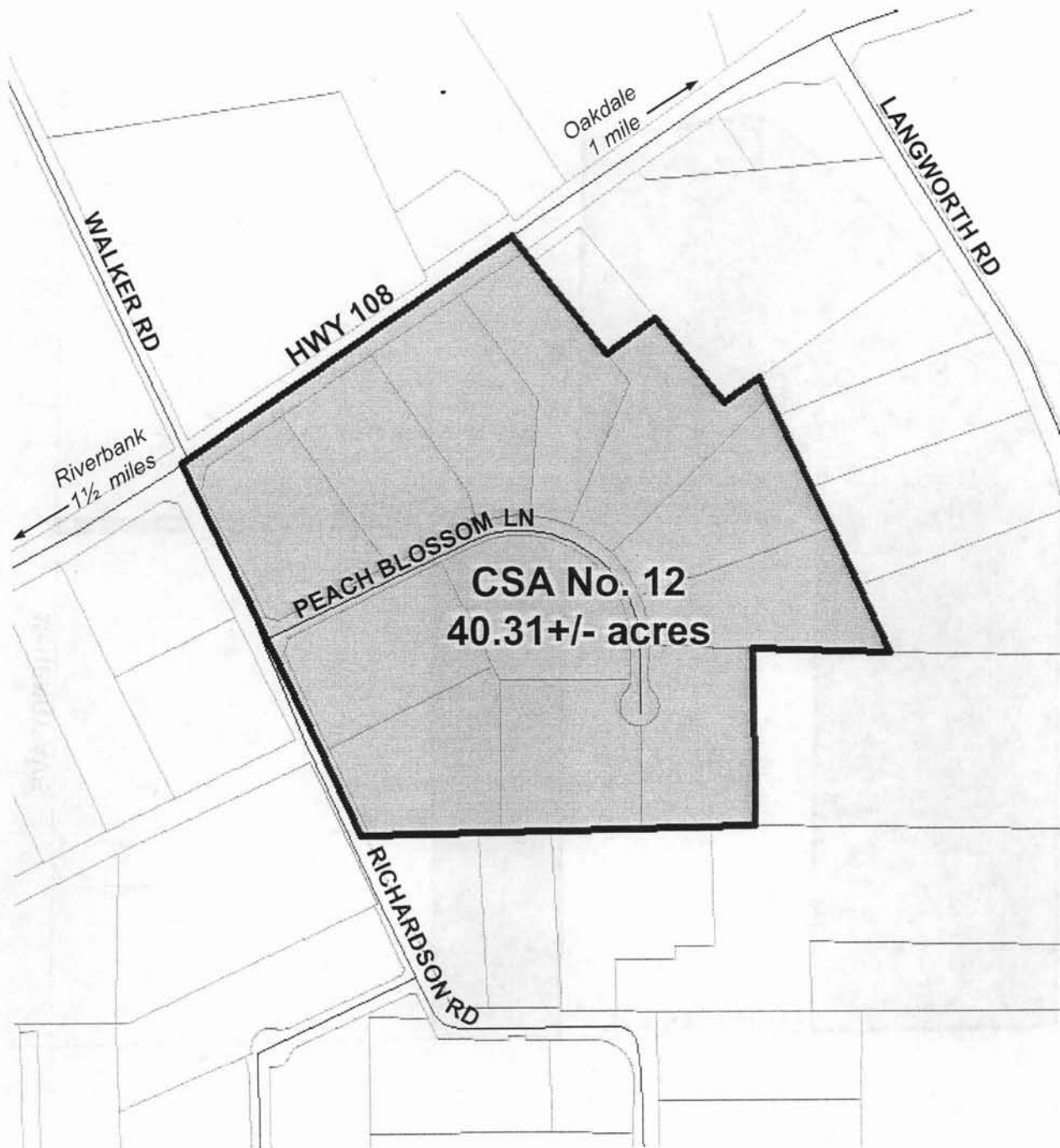

■ = CSA No. 12 Boundary (40.31+/-ac) ↗ = Sphere of Influence (coterminous)

Formation: November 8, 1991
Services Provided: Storm drainage



Source: LAFCO Files, County GIS, April 30, 2010

County Service Area (CSA) No. 14 "United Pallet"



■ = CSA No. 14 Boundary (53.25+/-ac)  = Sphere of Influence (coterminous)

Formation: January 12, 1993 (Currently inactive)

Services Provided: Storm drainage



County Service Area (CSA) No. 15 "Patterson Gateway"

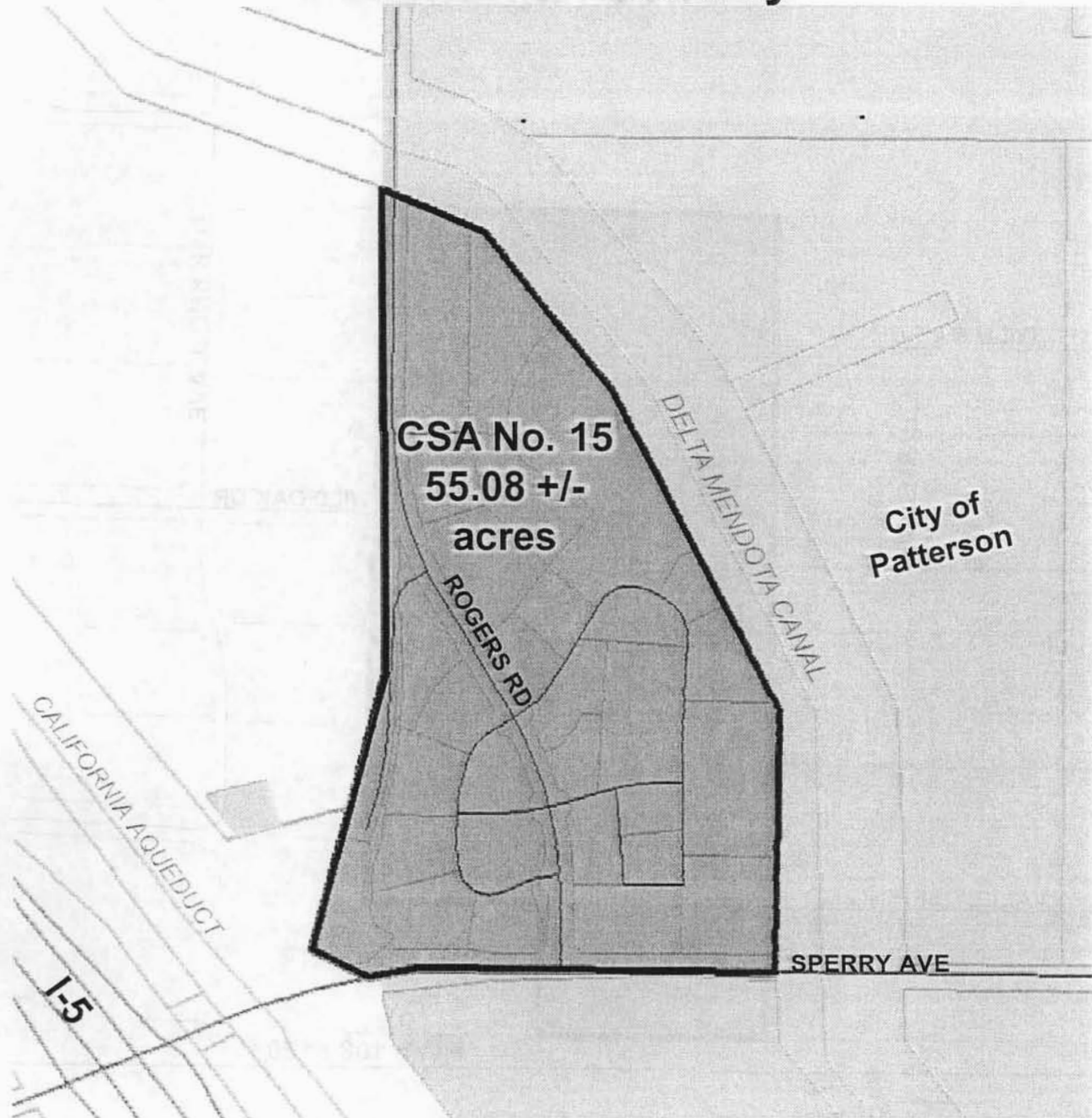

■ = CSA No. 15 Boundary (55.08+/-ac) — = Sphere of Influence (coterminous)

Formation: September 9, 1996

Services Provided: Storm drainage, and traffic signal at Sperry/Rogers intersection

Note: Portion of Original Territory Detached as Part of the "West Patterson Business Park Reorganization" on February 8, 2005. Existing CSA boundaries are completely within the City Limits of Patterson.



Source: LAFCO Files, County GIS, April 30, 2010

County Service Area (CSA) No. 16 "Olive Ranch"



■ = CSA No. 16 Boundary (17.07+/-ac)  = Sphere of Influence (coterminous)

Formation: October 30, 2000
Services Provided: Storm drainage



County Service Area (CSA) No. 18 "Atlas Park"



■ = CSA No. 18 Boundary (9.29+/-ac)  = Sphere of Influence (coterminous)

Formation: December 10, 2002

Services Provided: Storm drainage and park maintenance



County Service Area (CSA) No. 19 "Tuolumne-Gratton"



■ = CSA No. 19 Boundary (89.42 +/- ac) - - - = Sphere of Influence (coterminous)

Formation: January 6, 2003

Services Provided: Storm drainage and park maintenance



Source: LAFCO Files, County GIS, April 30, 2010

County Service Area (CSA) No. 20 "Summit Corporate Center"



 = CSA No. 20 Boundary (44.50+/-ac)  = Sphere of Influence (coterminous)

Formation: January 29, 2003
Services Provided: Storm drainage



County Service Area (CSA) No. 21 "Riopel"

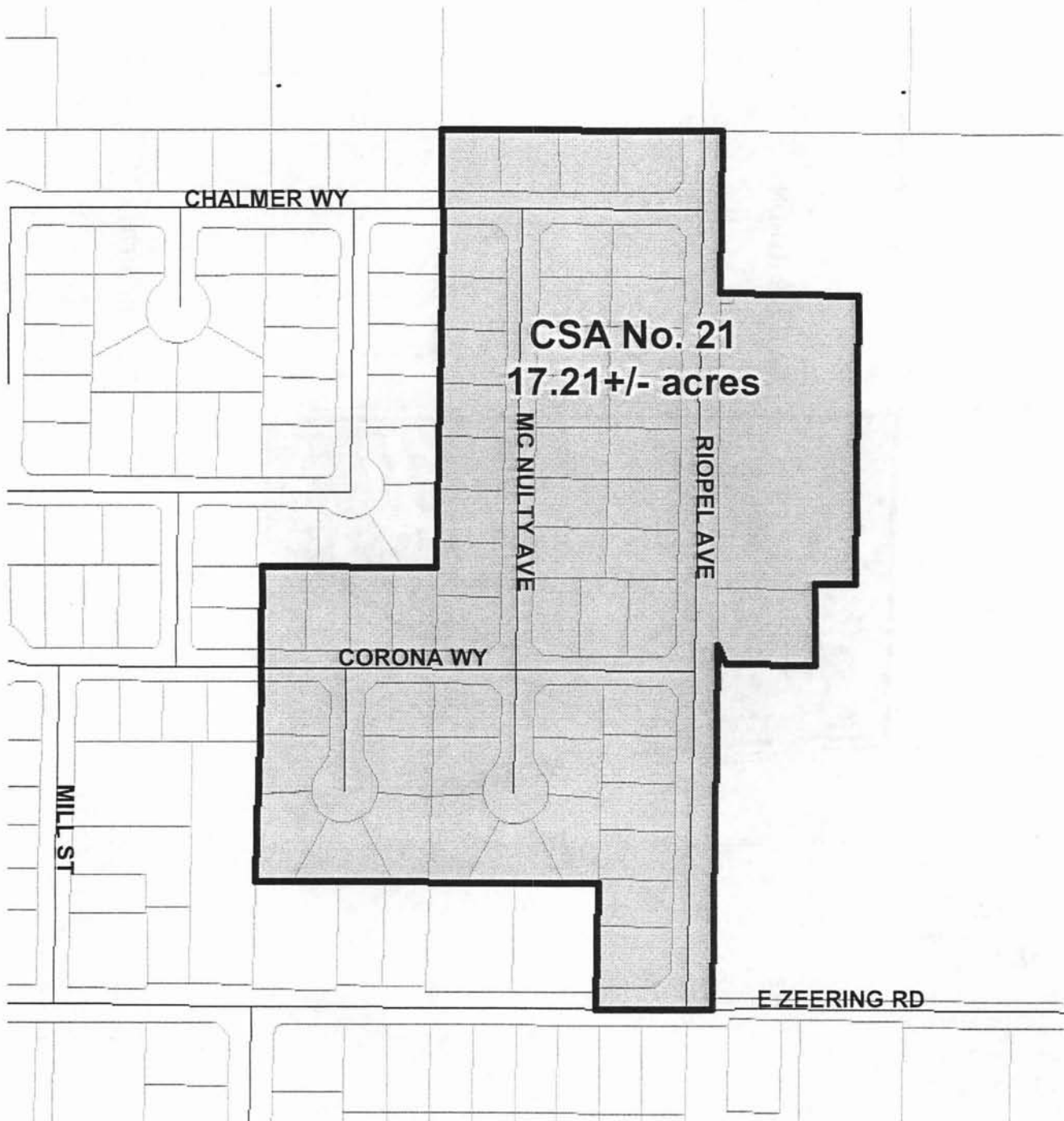

■ = CSA No. 21 Boundary (17.21+/-ac) — = Sphere of Influence (coterminous)

Formation: December 23, 2005

Services Provided: Storm drainage and landscape maintenance



County Service Area (CSA) No. 22 "Old School North"



■ = CSA No. 22 Boundary (3.18+/-ac) — = Sphere of Influence (coterminous)

Formation: January 11, 2005

Services Provided: Storm drainage and park maintenance



Source: LAFCO Files, County GIS, April 30, 2010

County Service Area (CSA) No. 23 "Hillsborough / Schutz"

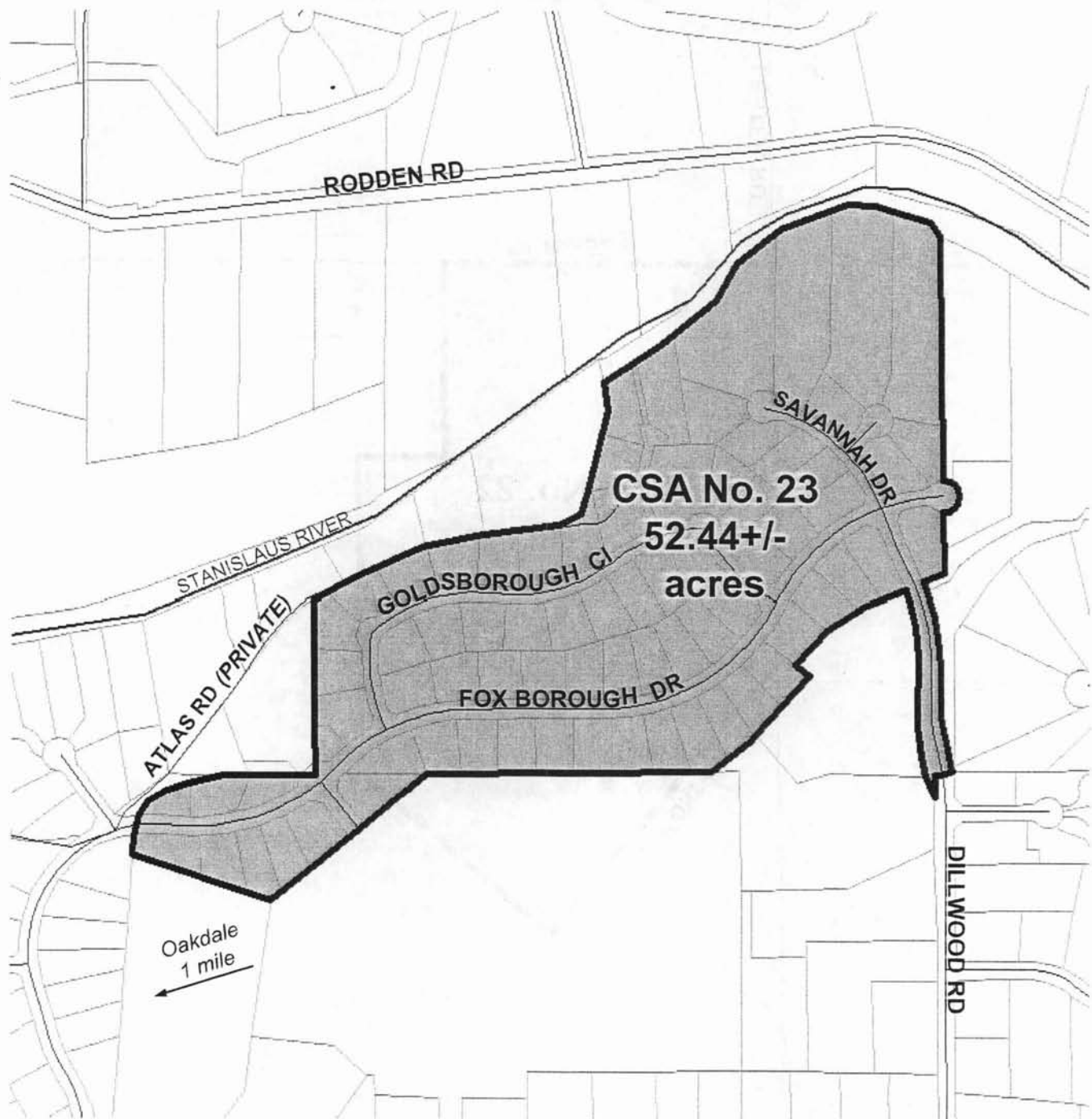

■ = CSA No. 23 Boundary (52.44+/-ac) — = Sphere of Influence (coterminous)

Formation: November 30, 2006

Services Provided: Storm drain system maintenance, including maintenance of river outfall facility



Source: LAFCO Files, County GIS, April 30, 2010

County Service Area (CSA) No. 24 "Hideaway Terrace"



 = CSA No. 24 Boundary (5.12+/-ac)  = Sphere of Influence (coterminous)

Formation: September 26, 2006

Services Provided: Storm drainage and landscape maintenance



County Service Area (CSA) No. 25 "Suncrest II"



= CSA No. 25 Boundary (4.37+/-ac)  = Sphere of Influence (coterminous)

Formation: November 30, 2006

Services Provided: Storm drainage and landscape maintenance



County Service Area (CSA) No. 26 "Keyes"



■ = CSA No. 26 Boundary (332.3+/-ac) **—** = Sphere of Influence (coterminous)

Formation: October 24, 2008

Services Provided: Storm drainage, park and landscape maintenance for areas within the Keyes Storm Drain Project



Note: The formation of CSA No. 26 in 2008 included the dissolution of CSAs No. 6 (Raymond Tract), CSA No. 13 (La Jolla), and CSA No. 17 (Sunray Estates).

Source: LAFCO Files, County GIS, April 30, 2010

County Service Area (CSA) No. 27 "Empire"



■ = CSA No. 27 Boundary (44.52+/-ac) - - - = Sphere of Influence (coterminous)

Formation: April 27, 2010

Services Provided: Storm drainage maintenance, street sweeping

