

THE BOARD OF SUPERVISORS OF THE COUNTY OF STANISLAUS
ACTION AGENDA SUMMARY

DEPT: Public Works *abnl*

BOARD AGENDA # *C-4

Urgent Routine

AGENDA DATE May 25, 2010

CEO Concurs with Recommendation YES NO
(Information Attached)

4/5 Vote Required YES NO

SUBJECT:

Approval to Adopt Plans and Specifications for the 2009 Slurry Seal Project and Set the Bid Opening Date

STAFF RECOMMENDATIONS:

1. Adopt plans and specifications for the 2009 Slurry Seal Project.
2. Direct the Department of Public Works to set the bid opening date and time.
3. Direct the Public Works Department to publish and mail a notice inviting bids to trade journals as required by law.

FISCAL IMPACT:

The total estimated cost for this project is \$870,000 that includes \$700,000 for construction, \$40,000 for construction engineering, \$60,000 materials testing and \$70,000 for contingency. The project will be 100% funded by Proposition 1B road funds.

BOARD ACTION AS FOLLOWS:

No. 2010-330

On motion of Supervisor O'Brien, Seconded by Supervisor Chiesa

and approved by the following vote,

Ayes: Supervisors: O'Brien, Chiesa, Monteith, DeMartini, and Chairman Grover

Noes: Supervisors: None

Excused or Absent: Supervisors: None

Abstaining: Supervisor: None

1) Approved as recommended

2) Denied

3) Approved as amended

4) Other:

MOTION:

Christine Ferraro

ATTEST: CHRISTINE FERRARO TALLMAN, Clerk

File No.

Approval to Adopt Plans and Specifications for the 2009 Slurry Seal Project and Set the Bid Opening Date

DISCUSSION:

The 2009 Slurry Seal Project is to slurry seal approximately 44 miles of various County roads. These roads are generally in County islands and this treatment is appropriate for urban neighborhoods. It will extend the service life of the roads by about five years.

Slurry seal treatment is intended to treat the surface of asphalt pavement by placing a layer of oil and rock on top of the existing pavement. This protects and rejuvenates the road. In addition, it creates a smoother riding surface for automobile traffic.

All encroachment permits necessary to commence the project have been obtained. This project is exempt from the California Environmental Quality Act, Class 1, California Code of Regulations, Title 14, #15301 (Existing Facilities). A Notice of Exemption was filed with the County Clerk-Recorder on May 4, 2010.

The following tentative schedule is provided:

Adopt Plans & Specifications	May 25, 2010
Advertise	May 31, 2010, June 7, June 14
Bid Opening	June 30, 2010

POLICY ISSUES:

The Board should consider if the recommended actions are consistent with its priorities of providing a safe community, a healthy community and a well-planned infrastructure system.

STAFFING IMPACT:

There is no staffing impact associated with this item.

CONTACT PERSON:

Matt Machado, Public Works Director. Phone: (209) 525-6550.

DB:jg
L:\ROADS\8029 - 2009 Slurry Seal\Adopt Plans and Specs_FINAL

**ATTACHMENTS AVAILABLE
FROM YOUR CLERK**

STANISLAUS COUNTY PUBLIC WORKS 2009 SLURRY SEAL AREAS

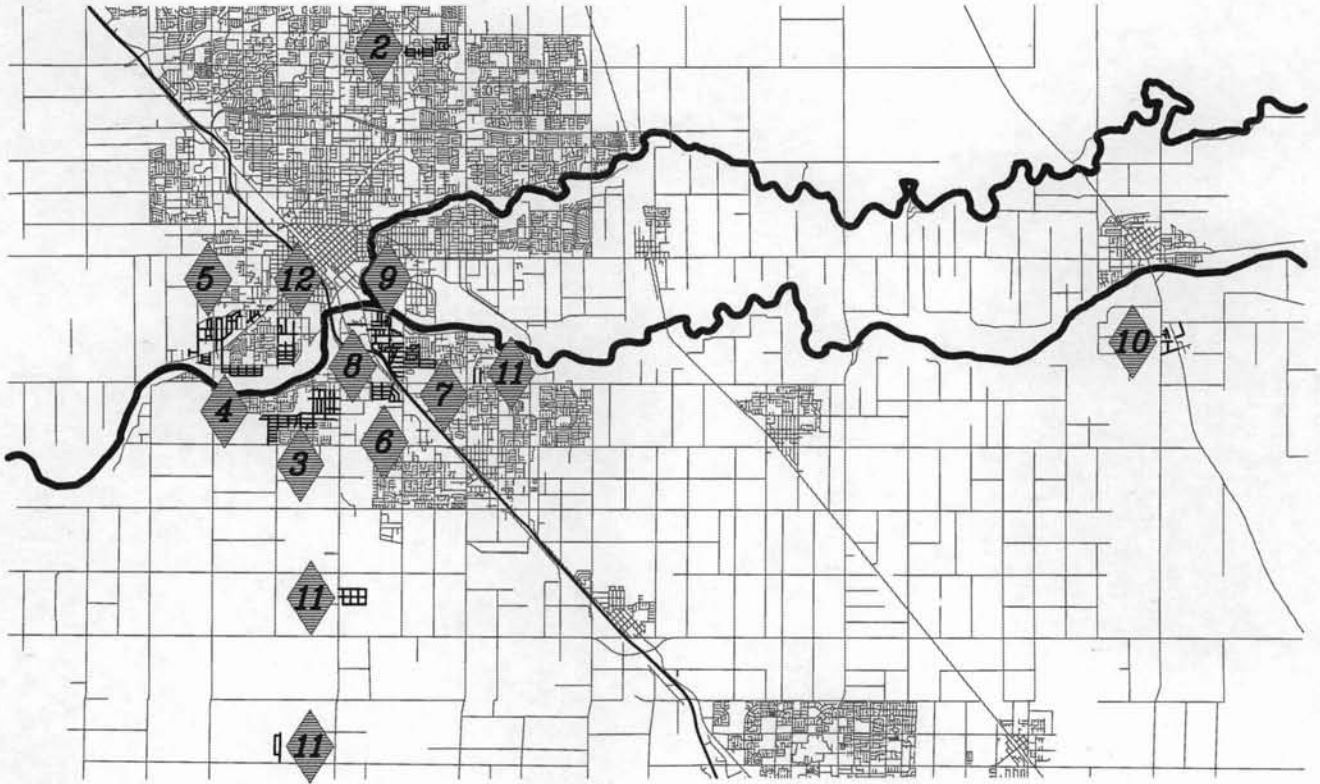



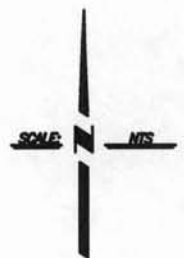

TABLE OF CONTENTS

1. COVER PAGE
2. SYLVAN AND COFFEE AREA
3. BRET HARTE AREA
4. ROBERTSON AREA
5. PARADISE AREA
6. PARKLAWN AREA
7. EAST HERNDON AREA
8. WEST HERNDON AREA
9. MANCINI AREA
10. HICKMAN AREA
11. MONTEREY AND COWAN TRACT
12. ROUSE AREA

LEGEND

- SLURRY AREA 
- PARCELS 
- CITY LIMIT LINE 



STANISLAUS COUNTY
DEPARTMENT OF PUBLIC WORKS
ENGINEERING AND OPERATIONS DIVISION
1716 MORGAN ROAD - MODESTO, CA 95358

**2009 SLURRY SEAL
COVER SHEET**

STANISLAUS COUNTY, CALIFORNIA

DRAWN BY: AJM
DATE: 04/19/10
SHEET: 01 OF 12
FILE: 01_COVER.DWG

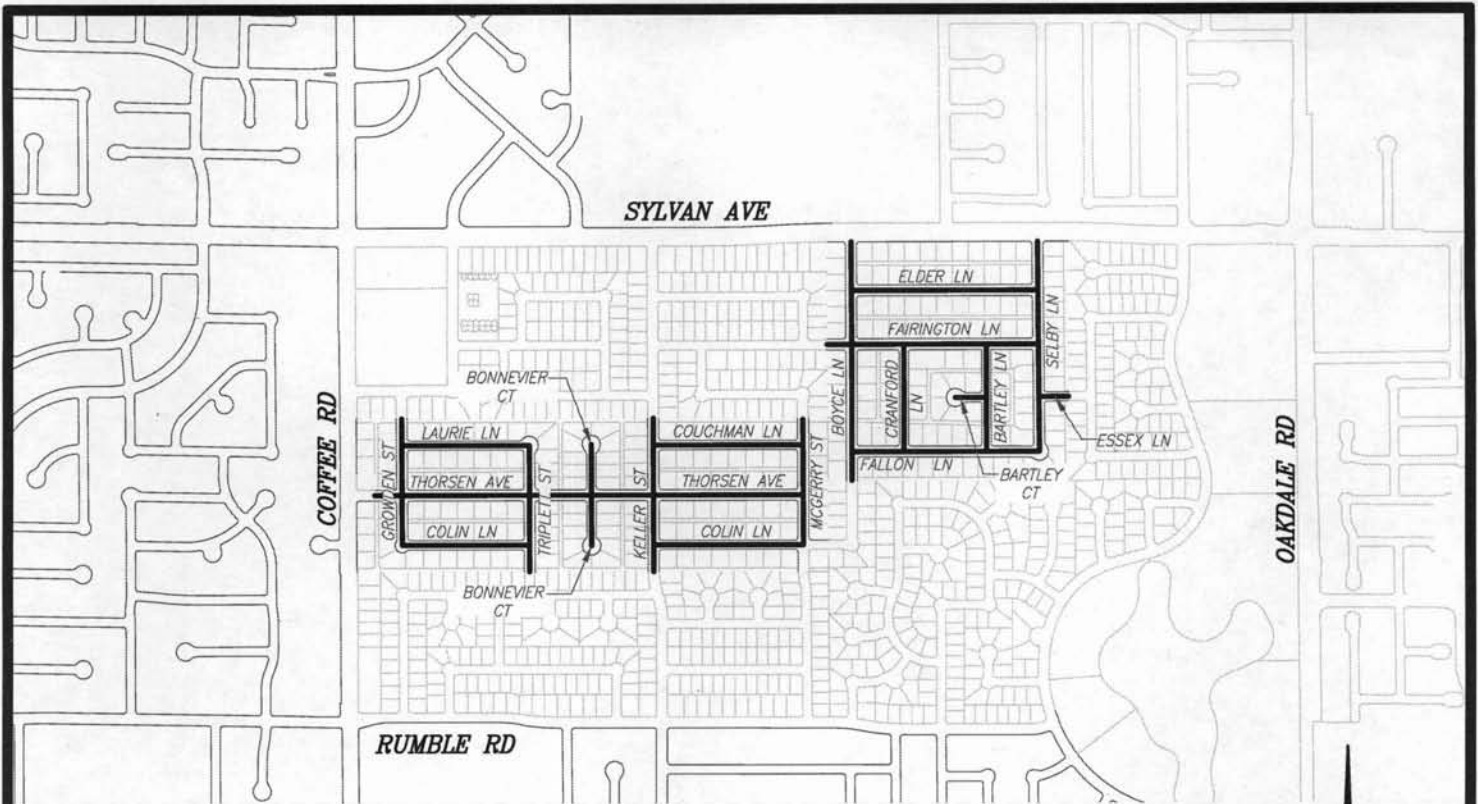

ROAD NAME	LIMITS	AREA	
THORSEN AVE	(140' E/O COFFEE TO MCGERRY)	90,000	SF
LAURIE LN	(GROWDON TO TRIPLETT)	25,984	SF
TRIPLETT ST	(LAURIE TO ALLEY S/O COLIN)	26,215	SF
GROWDEN ST	(ALLEY N/O LAURIE TO COLIN)	25,459	SF
BONNEVIER CT	(THORSEN TO NORTH END)	14,320	SF
BONNEVIER CT	(THORSEN TO SOUTH END)	14,320	SF
KELLER ST	(ALLEY N/O COUCHMAN TO ALLEY S/O COLIN)	30,600	SF
COLIN LN	(GROWDON TO TRIPLETT)	25,279	SF
COLIN LN	(KELLER TO MCGERRY)	29,520	SF
MCGERRY ST	(ALLEY N/O COUCHMAN TO COLIN)	24,300	SF
COUCHMAN LN	(KELLER TO MCGERRY)	29,520	SF
BOYCE LN	(SYLVAN TO ALLEY S/O FALLON)	46,440	SF
FALLON LN	(BOYCE TO SELBY)	37,335	SF
FAIRINGTON LN	(140' E/O BOYCE TO SELBY)	45,360	SF
ELDER LN	(BOYCE TO SELBY)	35,064	SF
SELBY LN	(SYLVAN TO FALLON)	41,914	SF
ESSEX LN	(SELBY TO 160' EAST)	5,760	SF
CRANFORD LN	(FALLON TO FAIRINGTON)	21,600	SF
BARTLEY CT	(BARTLEY TO END)	10,118	SF
BARTLEY LN	(FALLON TO FAIRINGTON)	20,880	SF
TOTAL		599,988	SF



STANISLAUS COUNTY
 DEPARTMENT OF PUBLIC WORKS
 ENGINEERING AND OPERATIONS DIVISION
 1716 MORGAN ROAD - MODESTO, CA 95358

2009 SLURRY SEAL
SYLVAN AV AT COFFEE RD

MODESTO, CALIFORNIA

DRAWN BY: AJM
 DATE: 04/19/10
 SHEET: 2 OF 12
 FILE: 02_SYLVAN.DWG



ROAD NAME	LIMITS	AREA	
GLENN AVE	(CROWS LANDING TO YUMA)	132,000	SF
IMPERIAL AVE	(CROWS LANDING TO YUMA)	130,000	SF
USTICK RD	(GLENN TO MARIN)	22,000	SF
TUCSON AVE	(GLENN TO PLUMAS)	48,000	SF
DALLAS ST	(LASSEN TO ALPINE)	66,600	SF
SEATTLE ST	(IMPERIAL TO AMADOR)	49,820	SF
MARIN AVE	(TUCSON TO USTICK)	15,000	SF
COLUSA AVE	(CROWS LANDING TO SEATTLE)	26,000	SF
SPOKANE ST	(GLENN TO AMADOR)	40,000	SF
EUREKA ST	(GLENN TO AMADOR)	40,000	SF
DENVER ST	(GLENN TO BUTTE)	26,000	SF
OLYMPIA ST	(GLENN TO BUTTE)	26,000	SF
BUTTE AVE	(CROWS LANDING TO LAS VEGAS)	53,000	SF
PORTLAND AVE	(BUTTE TO AMADOR)	15,000	SF
AMADOR AVE	(SEATTLE TO WEST END)	15,800	SF
INYO AVE	(TUCSON TO ALLEY E/O DALLAS)	80,000	SF
LASSEN AVE	(TUCSON TO RUTHERFORD)	34,000	SF
LASSEN AVE	(GUTHERIE TO ALLEY E/O DALLAS)	26,000	SF
GUTHERIE ST	(GLENN TO SOUTH END)	24,000	SF
FRAZIER ST	(GLENN TO LASSEN)	22,000	SF
TULSA ST	(INYO TO SOUTH END)	8,400	SF
PLUMAS AVE	(TUCSON TO USTICK)	14,000	SF
MARIN AVE	(TUCSON TO USTICK)	14,000	SF
PLACER AVE	(TUCSON TO USTICK)	14,000	SF
MODOC AVE	(TUCSON TO USTICK)	14,000	SF
RUTHERFORD ST	(GLENN TO LASSEN)	19,200	SF
TOTAL		974,820	SF

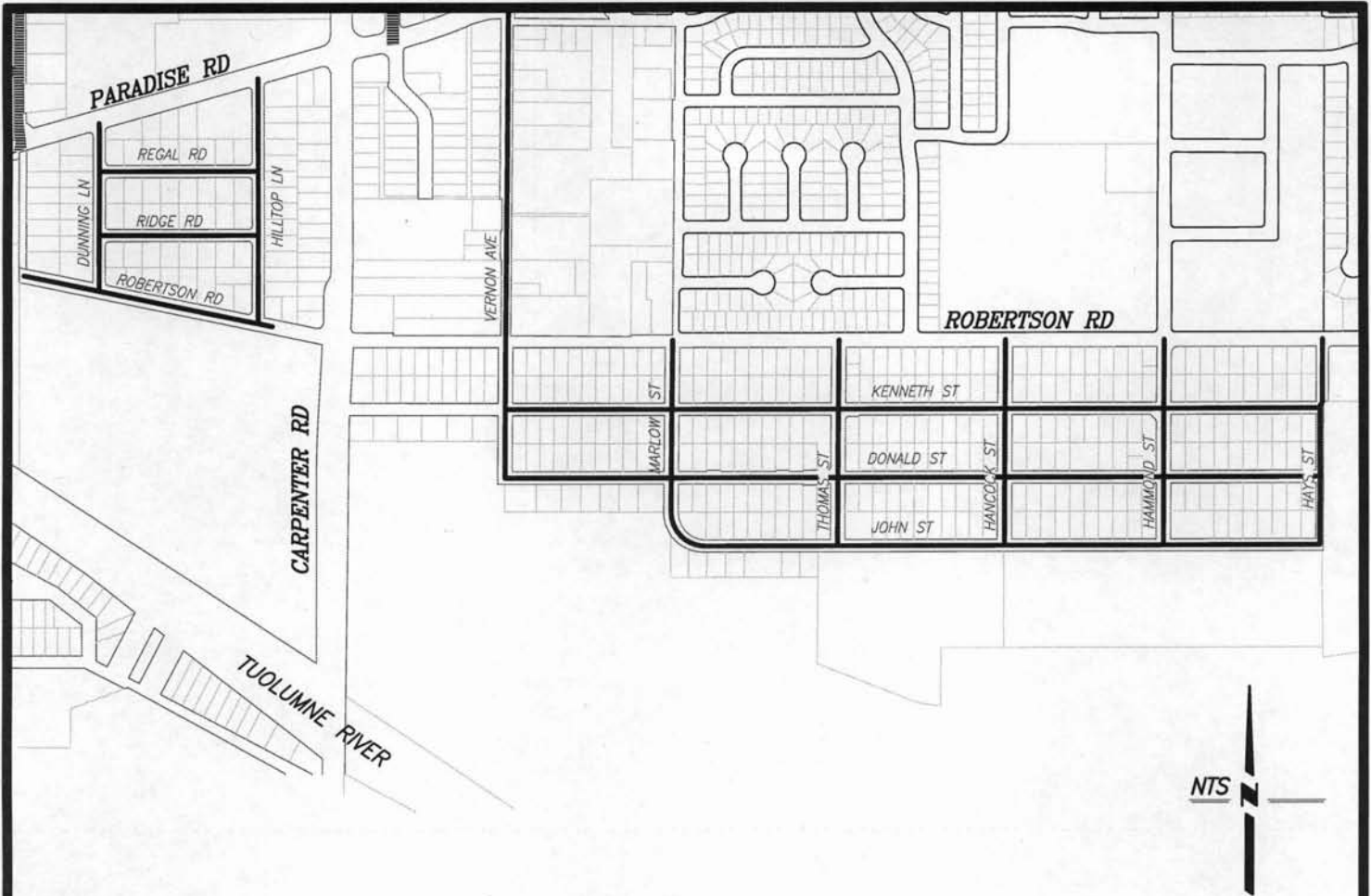

ROAD NAME	LIMITS	AREA	
RIDGE RD	(HILLTOP TO DUNNING)	15,840	SF
ROBERTSON RD	(60' E/O HILLTOP TO WEST END)	25,920	SF
REGAL RD	(HILLTOP TO DUNNING)	15,840	SF
DUNNING LN	(PARADISE TO ROBERTSON)	16,440	SF
HILLTOP LN	(PARADISE TO ROBERTSON)	24,480	SF
VERNON AVE	(ROBERTSON TO PARADISE)	39,400	SF
MARLOW ST	(ROBERTSON TO JOHN)	15,800	SF
JOHN ST	(MARLOW TO HAYS)	53,000	SF
DONALD ST	(VERNON TO HAYS)	67,600	SF
KENNETH ST	(HAYS TO WEST END)	80,000	SF
THOMAS ST	(ROBERTSON TO JOHN)	16,300	SF
HANCOCK ST	(ROBERTSON TO JOHN)	16,300	SF
HAMMOND ST	(ROBERTSON TO JOHN)	16,300	SF
HAYS ST	(ROBERTSON TO JOHN)	16,300	SF
TOTAL		419,520	SF



STANISLAUS COUNTY

DEPARTMENT OF PUBLIC WORKS
ENGINEERING AND OPERATIONS DIVISION
1716 MORGAN ROAD - MODESTO, CA 95358

2009 SLURRY SEAL ROBERTSON ROAD

MODESTO, CALIFORNIA

DRAWN BY: AJM

DATE: 04/19/10

SHEET: 04 OF 12

FILE: 04_ROBERTSON.DWG

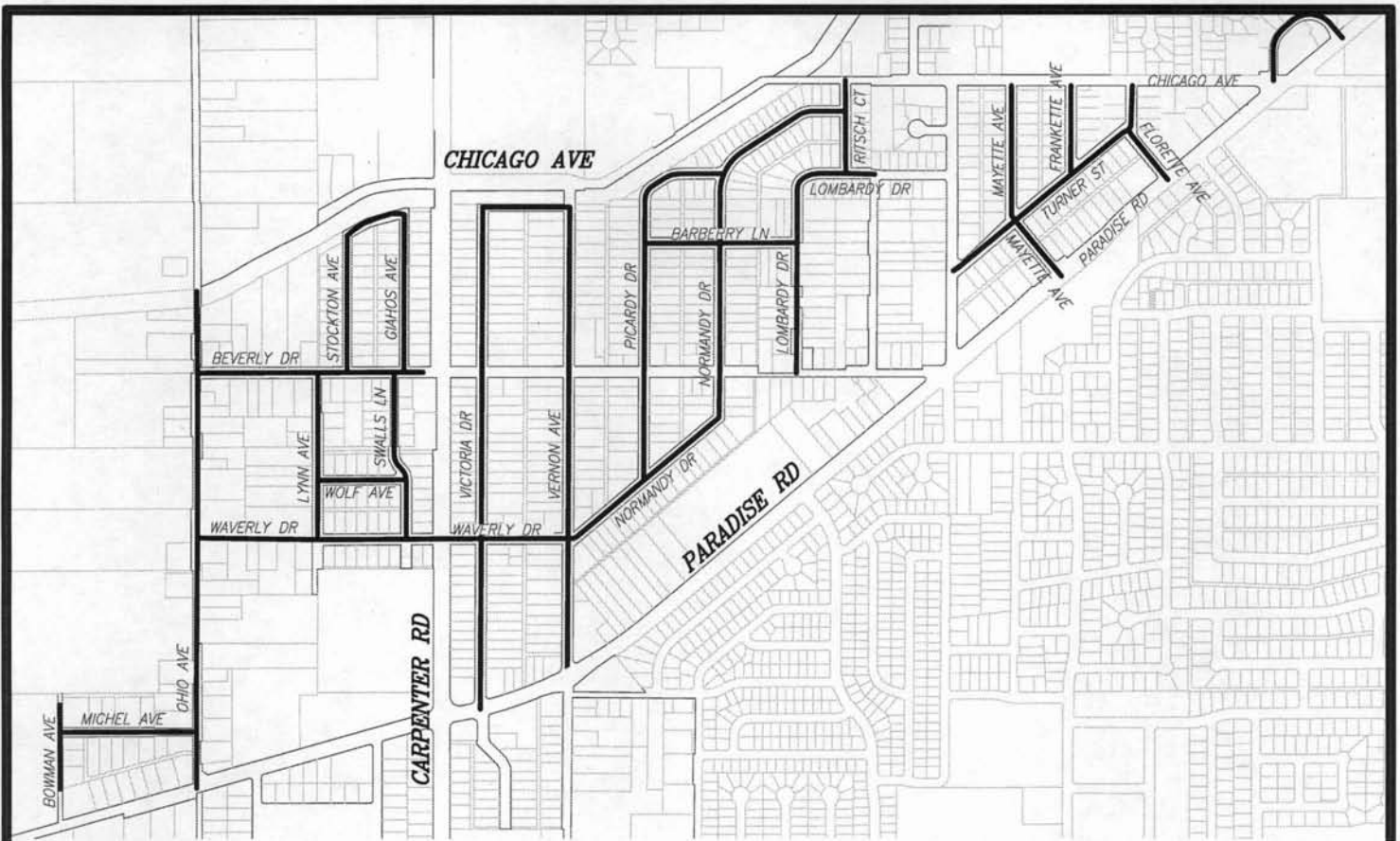

ROAD NAME	LIMITS	AREA	
BEVERLY DR	(OHIO TO 60' E/O GIAHOS)	23,400	SF
STOCKTON AVE	(BEVERLY TO GIAHOS)	21,500	SF
LYNN AVE	(BEVERLY TO WAVERLY)	18,200	SF
WOLF AVE	(LYNN TO SWALLS)	9,800	SF
WAVERLY DR	(OHIO TO VERNON)	40,400	SF
SWALLS LN	(BEVERLY TO WAVERLY)	18,600	SF
VICTORIA DR	(VERNON TO PARADISE)	62,800	SF
VERNON AVE	(PARADISE TO CHICAGO (CANAL))	51,800	SF
PICARDY DR	(NORMANDY (S) TO NORMANDY (N))	40,000	SF
BARBERRY LN	(PICARDY TO LOMBARDY)	16,300	SF
NORMANDY DR	(VERNON TO RITSCH)	63,000	SF
RITSCH CT	(CHICAGO TO LOMBARDY)	10,400	SF
LOMBARDY DR	(BEVERLY TO HARRIS)	37,200	SF
TURNER ST	(HARRIS TO FLORETTE)	24,000	SF
FLORETTE AVE	(PARADISE TO CHICAGO)	12,000	SF
MAYETTE AVE	(PARADISE TO TURNER)	7,000	SF
MAYETTE AVE	(TURNER TO CHICAGO)	15,400	SF
FRANKETTE AVE	(TURNER TO CHICAGO)	9,600	SF
ELLEN AVE	(CHICAGO TO PARADISE)	12,520	SF
MICHEL AVE	(BOWMAN TO OHIO)	17,856	SF
BOWMAN AVE	(150' N/O MICHEL TO 310' S/O MICHEL)	11,040	SF
OHIO AVE	(PARADISE TO CHICAGO)	64,272	SF
GIAHOS AVE	(CHICAGO TO BEVERLY)	16,900	SF
TOTAL		603,988	SF





NTS

ROAD NAME	LIMITS	AREA	
ATLANTIC DR	(PEARSON TO MIDWAY)	30,822	SF
DOVER AVE	(PEARSON TO MIDWAY)	36,984	SF
WATSON AVE	(PEARSON TO MIDWAY)	33,660	SF
PARKLAWN AVE	(PEARSON TO MIDWAY)	48,543	SF
PEARSON AVE	(HATCH TO PARKLAWN)	31,832	SF
CHURCH AVE	(HATCH TO PARKLAWN)	30,448	SF
MIDWAY AVE	(MORGAN TO NELSON)	38,961	SF
NELSON WAY	(MIDWAY TO MORGAN)	36,729	SF
ATLANTIC DR	(MIDWAY TO NELSON)	33,696	SF
DOVER AVE	(MIDWAY TO NELSON)	20,832	SF
TOTAL		342,507	SF



STANISLAUS COUNTY
 DEPARTMENT OF PUBLIC WORKS
 ENGINEERING AND OPERATIONS DIVISION
 1716 MORGAN ROAD - MODESTO, CA 95358

**2009 SLURRY SEAL
 PARKLAWN**
 MODESTO, CALIFORNIA

DRAWN BY: AJM
 DATE: 04/19/10
 SHEET: 06 OF 12
 FILE: 06_PARKLAWN.DWG

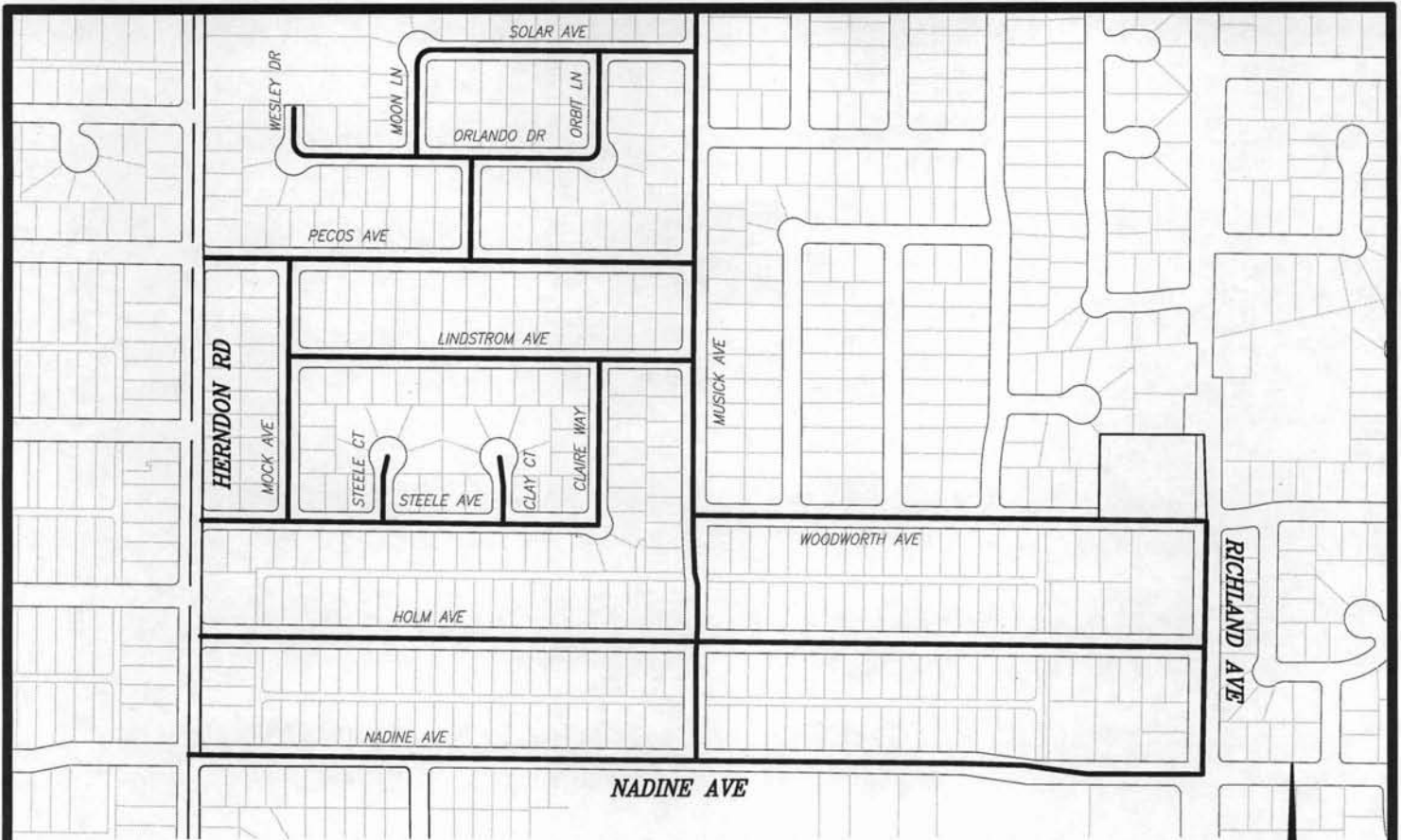

ROAD NAME	LIMITS	AREA		WIDTH
WESLEY DR	(ORLANDO TO END)	5,440	SF	33 FT
HOLM AVE	(RICHLAND TO HERNDON)	57,200	SF	22 FT
SOLAR AVE	(MUSICK TO MOON)	25,002	SF	33 FT
ORBIT LN	(SOLAR TO ORLANDO)	10,298	SF	37 FT
MOON LN	(SOLAR TO ORLANDO)	10,188	SF	33 FT
PECOS AVE	(MUSICK TO HERNDON)	48,100	SF	37 FT
LINDSTROM AVE	(MUSICK TO MOCK)	34,650	SF	33 FT
STEELE AVE	(HERNDON TO CLAIRE)	36,076	SF	33 FT
CLAIRE WAY	(LINDSTROM TO STEELE)	13,894	SF	33 FT
STEELE CT	(STEELE TO END)	9,585	SF	33 FT
CLAY CT	(STEELE TO END)	9,547	SF	33 FT
MOCK AVE	(PECOS TO STEELE)	22,275	SF	33 FT
WOODWORTH AVE (EB)	(MUSICK TO RICHLAND)	57,200	SF	44 FT
NADINE AVE (WB)	(HERNDON TO RICHLAND)	62,400	SF	24 FT
MUSICK AVE (SB)	(110' N/O SOLAR TO WOODWORTH)	48,470	SF	37 FT
RICHLAND AVE (SB)	(WOODWORTH TO NADINE)	26,650	SF	41 FT
ORLANDO DR	(WESLEY TO ORBIT)	29,022	SF	33 FT
TOTAL		505,997	SF	



STANISLAUS COUNTY
 DEPARTMENT OF PUBLIC WORKS
 ENGINEERING AND OPERATIONS DIVISION
 1716 MORGAN ROAD - MODESTO, CA 95358

2009 SLURRY SEAL
 NADINE AND RICHLAND

CERES, CALIFORNIA

DRAWN BY: AJM
 DATE: 04/19/10
 SHEET: 07 OF 12
 FILE: 07_HERNDONEAST.DWG

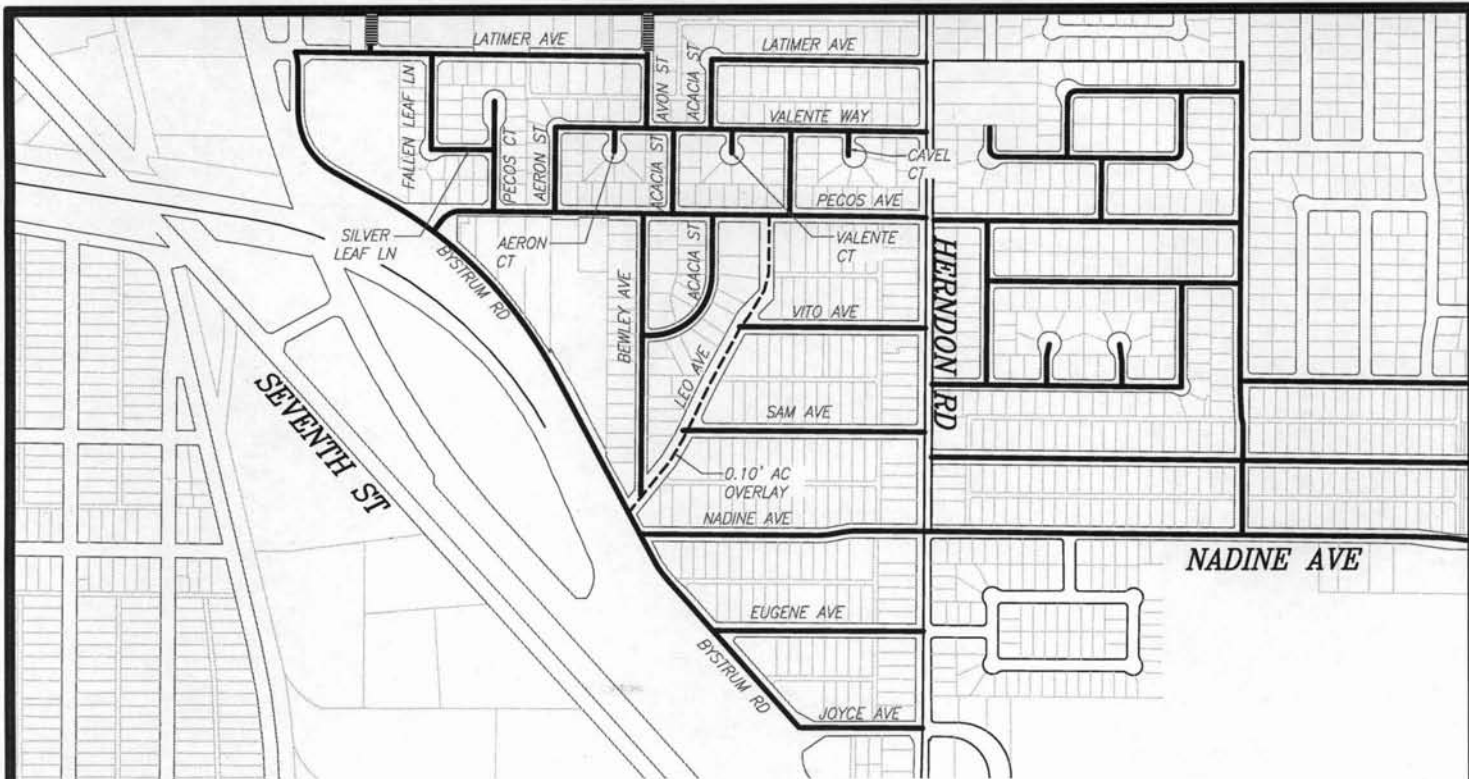

ROAD NAME	LIMITS	AREA	
AVON ST	(LATIMER TO VALENTE)	11,094	SF
VALENTE WAY	(AERON TO HERNDON)	51,213	SF
ACACIA ST	(VALENTE TO LATIMER)	10,656	SF
ACACIA ST	(VALENTE TO PECOS)	11,073	SF
LATIMER	(ACACIA TO HERNDON)	30,455	SF
LATIMER	(BYSTRUM TO AVON)	47,626	SF
CAVEL CT	(VALENTE TO END)	7,600	SF
VALENTE CT	(VALENTE TO END)	7,071	SF
AERON CT	(VALENTE TO END)	7,072	SF
FALLEN LEAF LN	(LATIMER TO SILVER LEAF)	14,419	SF
SILVER LEAF LN	(FALLEN LEAF TO PECOS CT)	9,976	SF
PECOS CT	(PECOS TO END)	22,024	SF
AERON ST	(VALENTE TO PECOS)	12,010	SF
JOYCE AVE	(HERNDON TO BYSTRUM)	14,356	SF
BYSTRUM RD	(JOYCE TO LATIMER)	102,628	SF
EUGENE AVE	(HERNDON TO BYSTRUM)	17,174	SF
NADINE AVE	(HERNDON TO BYSTRUM)	23,398	SF
LEO AVE	(BYSTRUM TO PECOS)	19,149	SF
VITO AVE	(LEO TO HERNDON)	13,832	SF
SAM AVE	(LEO TO HERNDON)	17,816	SF
BEWLEY AVE	(LEO TO PECOS)	20,560	SF
ACACIA ST	(BEWLEY TO PECOS)	14,549	SF
PECOS AVE	(HERNDON TO BYSTRUM)	49,775	SF
TOTAL		535,526	SF



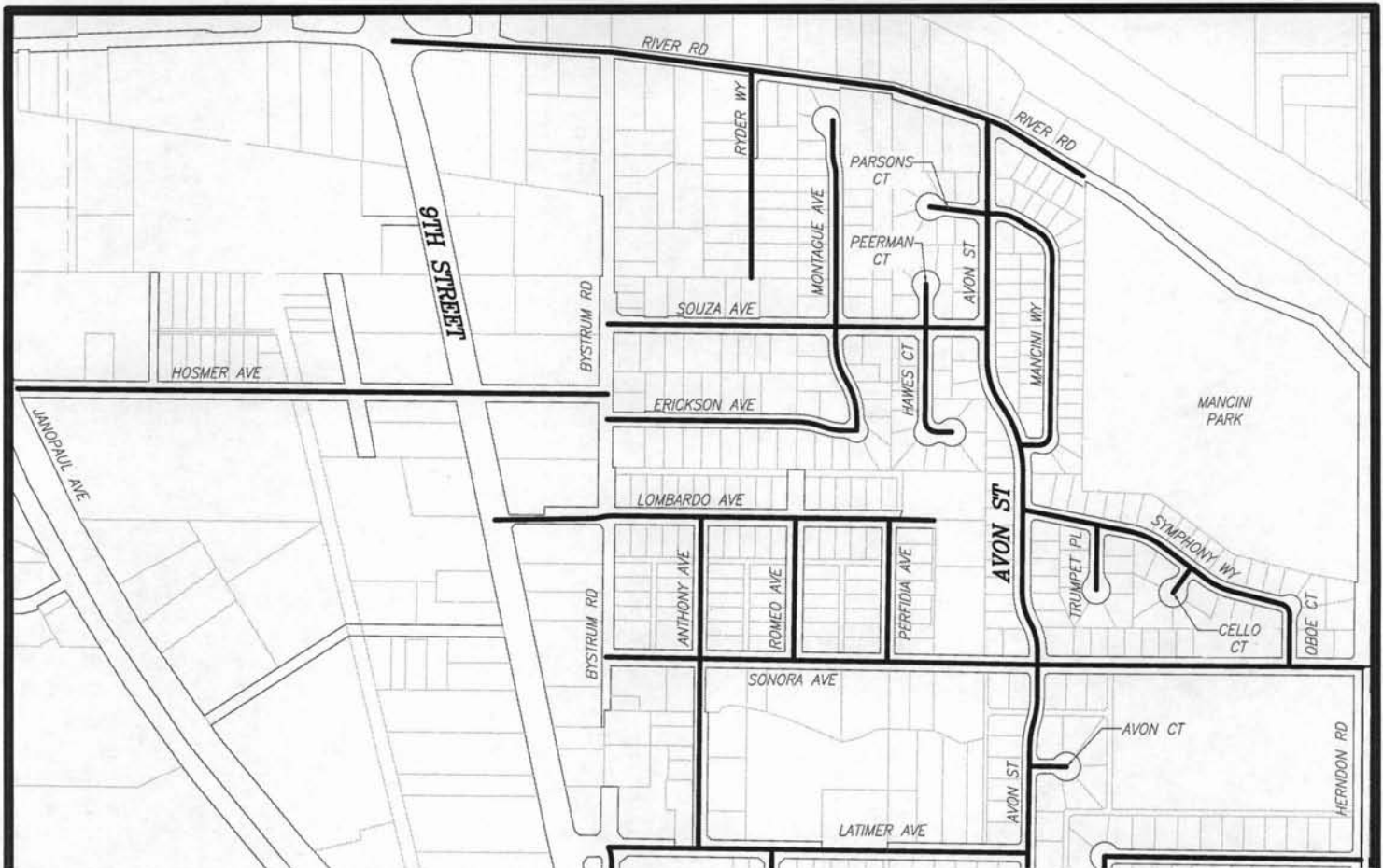

ROAD NAME	LIMITS	AREA		WIDTH
AVON ST	(LATIMER TO RIVER)	93,451	SF	37 FT
LOMBARDO AVE	(9TH TO EAST END)	41,376	SF	27 FT
RIVER RD	(9TH STREET TO MANCINI PARK)	79,689	SF	23 FT
HOSMER AVE	(JANOPAUL TO BYSTRUM)	47,435	SF	23 FT
SONORA AVE	(BYSTRUM TO HERNDON)	81,632	SF	23 FT
ANTHONY AVE	(LOMBARDO TO LATIMER)	25,370	SF	23 FT
ROMEO AVE	(LOMBARDO TO SONORA)	12,206	SF	26 FT
PERFIDIA AVE	(LOMBARDO TO SONORA)	12,247	SF	26 FT
ERICKSON AVE	(BYSTRUM TO MONTAGUE)	20,986	SF	20 FT
MONTAGUE AVE	(ERICKSON TO END)	41,089	SF	33 FT
MANCINI WY	(AVON (N) TO AVON (S))	34,258	SF	33 FT
PARSONS CT	(AVON TO END)	10,142	SF	33 FT
SOUZA AVE	(BYSTRUM TO AVON)	42,356	SF	37 FT
RYDER WY	(RIVER RD TO END)	14,156	SF	20 FT
HAWES CT	(SOUZA TO END)	20,632	SF	33 FT
PEERMAN CT	(SOUZA TO END)	8,428	SF	33 FT
TRUMPET PL	(SYMPHONY TO END)	12,505	SF	37 FT
SYMPHONY WY	(AVON TO OBOE)	33,563	SF	33 FT
CELLO CT	(SYMPHONY TO END)	7,494	SF	33 FT
OBOE CT	(SYMPHONY TO SONORA)	7,164	SF	33 FT
AVON CT	(AVON TO END)	7,984	SF	33 FT
TOTAL		654,163	SF	



STANISLAUS COUNTY
 DEPARTMENT OF PUBLIC WORKS
 ENGINEERING AND OPERATIONS DIVISION
 1716 MORGAN ROAD - MODESTO, CA 95358

**2009 SLURRY SEAL
 MANCINI PARK**

CERES, CALIFORNIA

DRAWN BY: A/JM
 DATE: 04/19/10
 SHEET: 09 OF 12
 FILE: 09_MANCINI.DWG

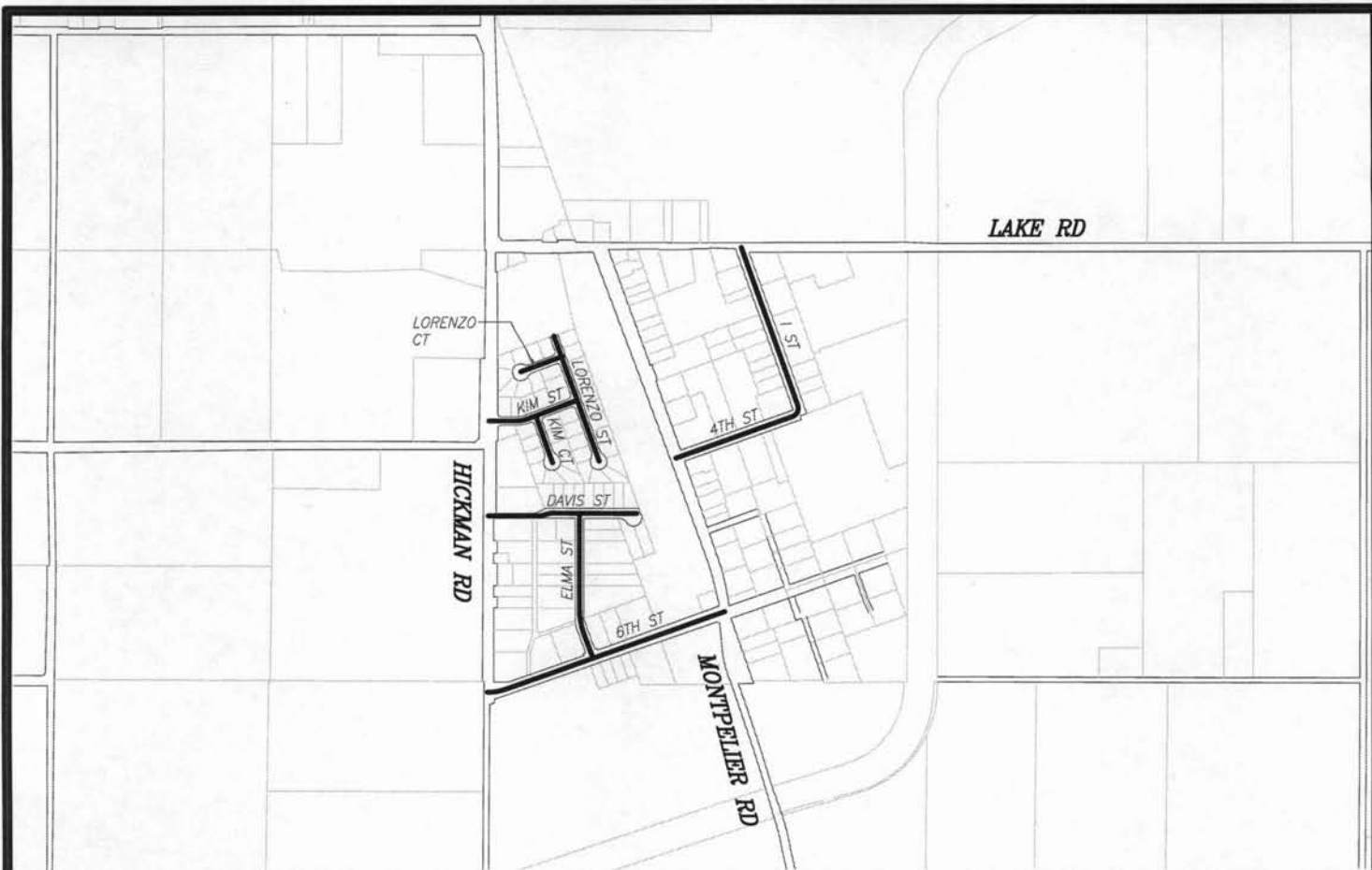

ROAD NAME	LIMITS	AREA		WIDTH
LORENZO CT	(LORENZO ST TO WEST END)	12,623	SF	33 FT
LORENZO ST	(NORTH END TO SOUTH END)	30,821	SF	33 FT
KIM CT	(KIM ST TO SOUTH END)	14,108	SF	33 FT
KIM ST	(HICKMAN RD TO LORENZO ST)	16,805	SF	33 FT
DAVIS ST	(HICKMAN RD TO WEST END)	32,266	SF	30 FT
ELMA ST	(DAVIS TO 6TH ST)	17,306	SF	20 FT
6TH ST	(HICKMAN RD TO MONTEPELIER)	36,459	SF	23 FT
4TH ST	(MONTEPELIER TO 1 ST)	22,937	SF	30 FT
1 ST	(LAKE ROAD TO 4TH ST)	25,077	SF	24 FT
TOTAL		208,402	SF	



STANISLAUS COUNTY
 DEPARTMENT OF PUBLIC WORKS
 ENGINEERING AND OPERATIONS DIVISION
 1716 MORGAN ROAD - MODESTO, CA 95358

2009 SLURRY SEAL
 HICKMAN
 HICKMAN, CALIFORNIA

DRAWN BY: AJM
 DATE: 04/19/10
 SHEET: 10 OF 12
 FILE: 10_HICKMAN.DWG

ROAD NAME	LIMITS	AREA	
LA SIESTA AVE	(MONTEREY TO FOY)	8,737	SF
DURANGO AVE	(MONTEREY TO FOY)	8,600	SF
MONTEREY AVE	(LA SIESTA TO DURANGO)	31,354	SF
FOY AVE	(DURANGO TO MONTE VISTA)	49,218	SF
TOTAL		97,909	SF



ROAD NAME	LIMITS	AREA	
PAYNE AVE	(HATCH TO LEHI)	45,638	SF
WALLIN WAY	(HATCH TO LEHI)	45,398	SF
WALTER DR	(WALLIN TO END (E))	5,605	SF
TOTAL		96,641	SF

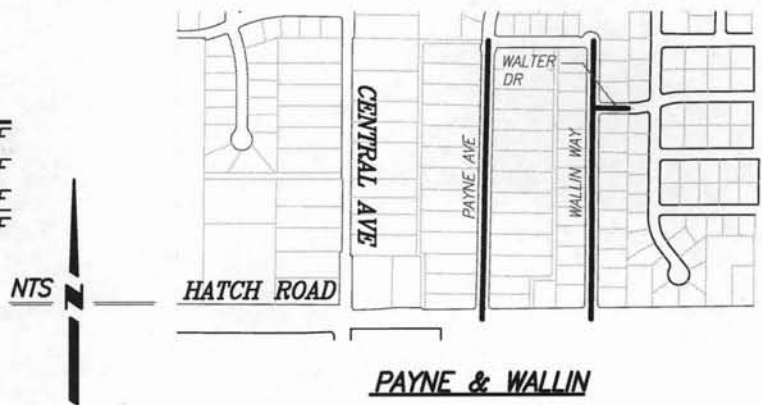

ROAD NAME	LIMITS	AREA	
SAN JOAQUIN ST	(CROWS LANDING TO AVE D)	45,267	SF
LATHROP ST	(AVE A TO AVE D)	37,847	SF
COWAN ST	(CROWS LANDING AVE D)	45,563	SF
AVE A	(SAN JOAQUIN TO LATHROP)	25,897	SF
AVE B	(SAN JOAQUIN TO LATHROP)	26,300	SF
AVE C	(SAN JOAQUIN TO LATHROP)	26,347	SF
AVE D	(SAN JOAQUIN TO LATHROP)	25,306	SF
TOTAL		232,527	SF

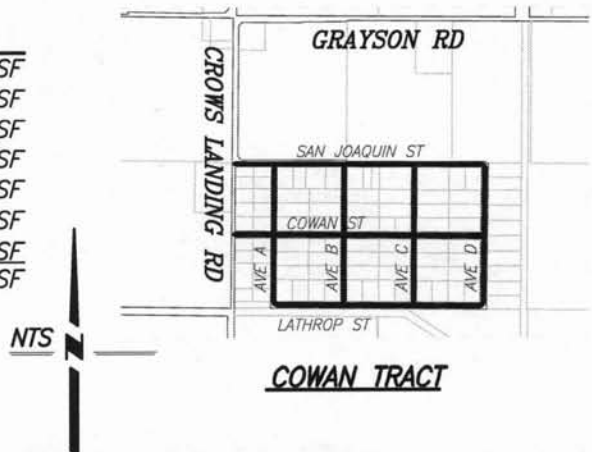

STANISLAUS COUNTY
 DEPARTMENT OF PUBLIC WORKS
 ENGINEERING AND OPERATIONS DIVISION
 1716 MORGAN ROAD - MODESTO, CA 95358

2009 SLURRY SEAL
 MONTEREY, COWAN, EAST CERES
 STANISLAUS COUNTY, CALIFORNIA

DRAWN BY: AJM
 DATE: 04/19/10
 SHEET: 11 OF 12
 FILE: 11_MONTEREY.DWG



ROAD NAME	LIMITS	AREA
COLORADO AVE	(330' S/O SOUTH AV TO SOUTH END)	87,395 SF
ROUSE AVE	(SUTTER TO 250' E/O COLORADO)	31,544 SF
GARDEN AVE	(COLORADO TO SUTTER)	26,224 SF
LEON AVE	(SOUTH AV TO ROUSE)	26,643 SF
LEON AVE	(NORTH END TO AVALON)	28,077 SF
AVALON AVE	(COLORADO TO SUTTER)	26,233 SF
FAUSTINA AVE	(COLORADO TO SUTTER)	26,187 SF
PELTON AVE	(COLORADO TO SUTTER)	26,195 SF
FIGARO AVE	(COLORADO TO 260' E/O SUTTER)	20,957 SF
SUTTER AVE (NB)	(ROBERTSON TO 260' S/O FIGARO)	28,615 SF
SUTTER AVE (NB)	(260' N/O FIGARO TO SOUTH AVE)	41,257 SF
S ALTURAS AVE	(ROUSE TO ELSIE)	13,502 SF
ELSIE ST	(SUTTER TO ALTURAS)	5,894 SF
TOTAL		388,723 SF



STANISLAUS COUNTY
 DEPARTMENT OF PUBLIC WORKS
 ENGINEERING AND OPERATIONS DIVISION
 1716 MORGAN ROAD - MODESTO, CA 95358

2009 SLURRY SEAL
 ROUSE ROAD
 MODESTO, CALIFORNIA

DRAWN BY: AJM
 DATE: 04/19/10
 SHEET: 12 OF 12
 FILE: 12_ROUSE.DWG

**DECLARATION OF PUBLICATION
(C.C.P. S2015.5)**

**COUNTY OF STANISLAUS
STATE OF CALIFORNIA**

I am a citizen of the United States and a resident Of the County aforesaid; I am over the age of Eighteen years, and not a party to or interested In the above entitle matter. I am a printer and Principal clerk of the publisher of **THE MODESTO BEE**, printed in the City of **MODESTO**, County of **STANISLAUS**, State of California, daily, for which said newspaper has been adjudged a newspaper of general circulation by the Superior Court of the County of **STANISLAUS**, State of California, Under the date of **February 25, 1951, Action No. 46453**; that the notice of which the annexed is a printed copy, has been published in each issue there of on the following dates, to wit:

Jun 25, 2010, Jul 02, 2010, Jul 09, 2010

INVITATION TO CONTRACTORS

2009 Slurry Seal Project
Owner is Stanislaus County, Modesto CA; estimated construction cost for this project is \$853,264 and \$1,047,490; sealed bids are due before 2:00 P.M., April 21, 2010, to the Clerk of the Board of Supervisors, 1010 10th Street, Ste. 6709, Modesto, CA 95354; Project contact is Denis Bazyuk at bazyukd@stancounty.com or Fax No. (209) 525-4188. Work to be accomplished includes Slurry Seal Roads in Various Urban County areas and other such items not mentioned herein that are required by the plans and specifications. Plans and specifications are available for purchase from Valley Reprographics, Modesto CA, (209) 338-0801 and can be viewed at www.valleyreproplanroom.com under "Public Jobs".
Pub Dates June 25, July 2, 9, 2010

I certify (or declare) under penalty of perjury That the foregoing is true and correct and that This declaration was executed at

MODESTO, California on

July 9th, 2010

(By Electronic Facsimile Signature)

Marie Dieckmann