

THE BOARD OF SUPERVISORS OF THE COUNTY OF STANISLAUS  
ACTION AGENDA SUMMARY

DEPT: PARKS AND RECREATION *KMW*

BOARD AGENDA # \*B-17

Urgent        Routine X

AGENDA DATE July 10, 2001

CEO Concurs with Recommendation YES *mt* NO         
(Information Attached)

4/5 Vote Required YES        NO X

SUBJECT: **APPROVAL OF THE CONSTRUCTION OF A RESTROOM AT THE KIWANIS YOUTH CAMP AT LA GRANGE REGIONAL PARK**

STAFF  
RECOMMEN-  
DATIONS:

1. APPROVE THE FILING OF THE NEGATIVE DECLARATION FOR THE "KIWANIS YOUTH CAMP RESTROOM PROJECT" AND FIND THE PROJECT TO BE "DE MINIMIS" FOR PURPOSES OF THE FISH AND GAME CODES (ATTACHMENT A).
2. APPROVE THE CONSTRUCTION OF A NEW RESTROOM FOR THE KIWANIS YOUTH CAMP IN LA GRANGE REGIONAL PARK, WHICH IS CONSISTENT WITH THE GENERAL CONDITIONS SET FORTH IN RESOLUTIONS 83-26 AND 90-833 (ATTACHMENT B).

FISCAL  
IMPACT:

The Kiwanis Club of Greater Modesto will provide all funds, materials and volunteer labor to design and construct the new restroom facility. It is estimated that the materials for the project will cost approximately \$12,000. There will be no impact to the general fund.

-----  
BOARD ACTION

No. 2001-516

On motion of Supervisor Caruso , Seconded by Supervisor Blom  
and approved by the following vote,

Ayes: Supervisors: Mayfield, Blom, Simon, Caruso, and Chair Paul

Noes: Supervisors: None

Excused or Absent: Supervisors: None

Abstaining: Supervisor: None

1) X Approved as recommended

2)        Denied

3)        Approved as amended

Motion:

ATTEST: CHRISTINE FERRARO TALLMAN, Clerk

By: *Christine Ferraro* Deputy

File No.

APPROVAL OF THE CONSTRUCTION OF A RESTROOM AT THE KIWANIS YOUTH CAMP AT LA GRANGE REGIONAL PARK

Page 2

**DISCUSSION:** On January 4, 1983 the Board of Supervisors approved the establishment and initial development of the Kiwanis Youth Camp at La Grange Regional Park. On January 4, 1990 the Board of Supervisors approved a plan for the further development of the youth camp (attached Resolutions 83-26 and 90-833). Due to the great success of the youth camp, the Kiwanis of Greater Modesto would like to expand camping opportunities by developing a second group camping area. This additional camping area will enable two youth groups to independently camp on site, at the same time. Presently, the Kiwanis Youth Camp can accommodate one group at a time. The camp is available on a reservation basis to any organized youth group at no fee. The camping facility is used approximately thirty weekends per year, with an average occupancy of 38 users per day.

As per Board Resolution, the Kiwanis of Greater Modesto are responsible for all improvements and general maintenance of the camp. They are proposing to use a small area on the upper level of the site. A new 10'x15' wooden restroom and an upgraded water delivery system is proposed. The Kiwanis would furnish all necessary funds, materials, and volunteer labor to complete the project.

The construction of a restroom is considered to be a project under the California Environmental Quality Act (CEQA). Staff prepared an Initial Study with the conclusion that a Negative Declaration was appropriate for the project. The Initial Study was distributed to associated agencies, as per CEQA guidelines. The Department complied with the State Clearinghouse Review requirements for draft environmental documents. The Department of Public Works has reviewed the construction plans for the restroom. Upon Board approval of the project, a building permit will be secured.

Staff is recommending that the Board approve the filing of the Negative Declaration for the Kiwanis Youth Camp Restroom project, and find the project to be "De Minimis" for the purposes of the Fish and Game codes. Staff is also recommending that the Board approve the construction of a new restroom at the Kiwanis Camp at La Grange Regional Park.

**POLICY  
ISSUE:**

The Board should decide if it will approve the findings of the Initial Study Negative Declaration and approve the construction of the restroom. This project supports the Board's priority of providing a safe and healthy community.

APPROVAL OF THE CONSTRUCTION OF A RESTROOM AT THE KIWANIS YOUTH  
CAMP AT LA GRANGE REGIONAL PARK

Page 3

STAFFING

IMPACT:                   The existing park staff will operate and maintain the new restroom.

# Stanislaus County

## Parks and Recreation Department

3800 Cornucopia Way, Ste C  
Modesto, CA 95358

Phone: (209) 525-6750  
Fax: 525-6774

---

### CEQA INITIAL STUDY

Adapted from CEQA Guidelines APPENDIX G Environmental Checklist Form, Final Text, October 26, 1998

- 1. Project title:** Kiwanis Youth Camp Restroom
- 2. Lead agency name and address:** Stanislaus County Parks and Recreation  
3800 Cornucopia way, Ste C  
Modesto, CA 95358
- 3. Contact person and phone number:** Steve Brodie  
(209)525-6768
- 4. Project location:** La Grange Gold Dredge Camp  
Highway 132 and Lake Road, LaGrange, Ca.
- 5. Project sponsor's name and address:** Stanislaus County Parks and Recreation  
3800 Cornucopia Way, Ste C  
Modesto, Ca. 95358
- 6. General plan designation:** Stanislaus County General Plan  
Historic Site
- 7. Zoning:** Stanislaus County HS
- 8. Description of project:** The specific project evaluated herein is the construction of a new restroom to service small youth groups at the upper level of the Kiwanis Youth Camp.
- 9. Surrounding land uses and setting:** The land is currently used for a youth camp as well as for grazing purposes. The surrounding area is identical to the Park site in features and soils. The surrounding area is also used for grazing.
- 10. Other public agencies whose approval is required** (e.g., permits, financing approval, or participation agreement.)

Stanislaus County Planning Department  
Stanislaus County Department of Environmental Resources  
California State Office of Historic Preservation

**ENVIRONMENTAL FACTORS POTENTIALLY AFFECTED:**

The environmental factors checked below would be potentially affected by this project, involving at least one impact that is a "Potentially Significant Impact" as indicated by the checklist on the following pages.

- Aesthetics
- Agriculture Resources
- Air Quality
- Biological Resources
- Cultural Resources
- Geology /Soils
- Hazards & Hazardous Materials
- Hydrology / Water Quality
- Land Use / Planning
- Mineral Resources
- Noise
- Population / Housing
- Public Services
- Recreation
- Transportation/Traffic
- Utilities / Service Systems
- Mandatory Findings of Significance

**DETERMINATION:** (To be completed by the Lead Agency

On the basis of this initial evaluation:

- I find that the proposed project COULD NOT have a significant effect on the environment, and a NEGATIVE DECLARATION will be prepared.
- I find that although the proposed project could have a significant effect on the environment, there will not be a significant effect in this case because revisions in the project have been made by or agreed to by the project proponent. A MITIGATED NEGATIVE DECLARATION will be prepared.
- I find that the proposed project MAY have a significant effect on the environment, and an ENVIRONMENTAL IMPACT REPORT is required.
- I find that the proposed project MAY have a "potentially significant impact" or "potentially significant unless mitigated" impact on the environment, but at least one effect 1) has been adequately analyzed in an earlier document pursuant to applicable legal standards, and 2) has been addressed by mitigation measures based on the earlier analysis as described on attached sheets. An ENVIRONMENTAL IMPACT REPORT is required, but it must analyze only the effects that remain to be addressed.
- I find that although the proposed project could have a significant effect on the environment, because all potentially significant effects (a) have been analyzed adequately in an earlier EIR or NEGATIVE DECLARATION pursuant to applicable standards, and (b) have been avoided or mitigated pursuant to that earlier EIR or NEGATIVE DECLARATION, including revisions or mitigation measures that are imposed upon the proposed project, nothing further is required.

Steve Brodie \_\_\_\_\_ 1-16-01 \_\_\_\_\_  
 Signature Date

Steve Brodie \_\_\_\_\_  
 Printed name

**ISSUES**

**I. AESTHETICS -- Would the project:**

	Potentially Significant Impact	Less Than Significant With Mitigation Included	Less Than Significant Impact	No Impact
a) Have a substantial adverse effect on a scenic vista?	<input type="checkbox"/>	<input type="checkbox"/>	<input type="checkbox"/>	<input checked="" type="checkbox"/>
b) Substantially damage scenic resources, including, but not limited to, trees, rock outcroppings, and historic buildings within a state scenic highway?	<input type="checkbox"/>	<input type="checkbox"/>	<input type="checkbox"/>	<input checked="" type="checkbox"/>
c) Substantially degrade the existing visual character or quality of the site and its surroundings?	<input type="checkbox"/>	<input type="checkbox"/>	<input type="checkbox"/>	<input checked="" type="checkbox"/>
d) Create a new source of substantial light or glare which would adversely affect day or nighttime views in the area?	<input type="checkbox"/>	<input type="checkbox"/>	<input type="checkbox"/>	<input checked="" type="checkbox"/>

**Discussion:**

This project would not result in any direct impact to aesthetic resources. Ultimate development of the subject site should not effect aesthetics by obstructing any scenic views or creating offensive public views. Neither will the proposed project have a demonstrable negative aesthetic effect. The project's location will not interfere with the vistas of future development in the area.

**Mitigation:**

None required

**II. AGRICULTURE RESOURCES:** In determining whether impacts to agricultural resources are significant environmental effects, lead agencies may refer to the California Agricultural Land Evaluation and Site Assessment Model (1997) prepared by the California Dept. of Conservation as an optional model to use in assessing impacts on agriculture and farmland. Would the project:

	Potentially Significant Impact	Less Than Significant With Mitigation Included	Less Than Significant Impact	No Impact
a) Convert Prime Farmland, Unique Farmland, or Farmland of Statewide Importance (Farmland), as shown on the maps prepared pursuant to the Farmland Mapping and Monitoring Program of the California Resources Agency, to non-agricultural use?	<input type="checkbox"/>	<input type="checkbox"/>	<input type="checkbox"/>	<input checked="" type="checkbox"/>
b) Conflict with existing zoning for agricultural use, or a Williamson Act contract?	<input type="checkbox"/>	<input type="checkbox"/>	<input type="checkbox"/>	<input checked="" type="checkbox"/>
c) Involve other changes in the existing environment which, due to their location or nature, could result in conversion of Farmland, to non-agricultural use?	<input type="checkbox"/>	<input type="checkbox"/>	<input type="checkbox"/>	<input checked="" type="checkbox"/>

**Discussion:**

This project in itself, would not result in any direct changes to the existing land uses, nor the conversion of any farmland to non-agricultural uses.

**Mitigation:**

None required

	Potentially Significant Impact	Less Than Significant With Mitigation Included	Less Than Significant Impact	No Impact
--	--------------------------------	--	------------------------------	-----------

III. AIR QUALITY -- Where available, the significance criteria established by the applicable air quality management or air pollution control district may be relied upon to make the following determinations. Would the project:

- |   |                          |                          |                          |                                     |
|---|--------------------------|--------------------------|--------------------------|-------------------------------------|
| a) Conflict with or obstruct implementation of the applicable air quality plan?   | <input type="checkbox"/> | <input type="checkbox"/> | <input type="checkbox"/> | <input checked="" type="checkbox"/> |
| b) Violate any air quality standard or contribute substantially to an existing or projected air quality violation?  | <input type="checkbox"/> | <input type="checkbox"/> | <input type="checkbox"/> | <input checked="" type="checkbox"/> |
| c) Result in a cumulatively considerable net increase of any criteria pollutant for which the project region is non-attainment under an applicable federal or state ambient air quality standard (including releasing emissions which exceed quantitative thresholds for ozone precursors)? | <input type="checkbox"/> | <input type="checkbox"/> | <input type="checkbox"/> | <input checked="" type="checkbox"/> |
| d) Expose sensitive receptors to substantial pollutant concentrations?  | <input type="checkbox"/> | <input type="checkbox"/> | <input type="checkbox"/> | <input checked="" type="checkbox"/> |
| e) Create objectionable odors affecting a substantial number of people?   | <input type="checkbox"/> | <input type="checkbox"/> | <input type="checkbox"/> | <input checked="" type="checkbox"/> |

**DISCUSSION:**

This project will not result in any direct impacts to Air Quality.

**MITIGATION:**

None required.



	Potentially Significant Impact	Less Than Significant With Mitigation Included	Less Than Significant Impact	No Impact
<b>IV. BIOLOGICAL RESOURCES -- Would the project:</b>				
a) Have a substantial adverse effect, either directly or through habitat modifications, on any species identified as a candidate, sensitive, or special status species in local or regional plans, policies, or regulations, or by the California Department of Fish and Game or U.S. Fish and Wildlife Service?	<input type="checkbox"/>	<input type="checkbox"/>	<input type="checkbox"/>	<input checked="" type="checkbox"/>
b) Have a substantial adverse effect on any riparian habitat or other sensitive natural community identified in local or regional plans, policies, regulations or by the California Department of Fish and Game or US Fish and Wildlife Service?	<input type="checkbox"/>	<input type="checkbox"/>	<input type="checkbox"/>	<input checked="" type="checkbox"/>
c) Have a substantial adverse effect on federally protected wetlands as defined by Section 404 of the Clean Water Act (including, but not limited to, marsh, vernal pool, coastal, etc.) through direct removal, filling, hydrological interruption, or other means?	<input type="checkbox"/>	<input type="checkbox"/>	<input type="checkbox"/>	<input checked="" type="checkbox"/>
d) Interfere substantially with the movement of any native resident or migratory fish or wildlife species or with established native resident or migratory wildlife corridors, or impede the use of native wildlife nursery sites?	<input type="checkbox"/>	<input type="checkbox"/>	<input type="checkbox"/>	<input checked="" type="checkbox"/>
e) Conflict with any local policies or ordinances protecting biological resources, such as a tree preservation policy or ordinance?	<input type="checkbox"/>	<input type="checkbox"/>	<input type="checkbox"/>	<input checked="" type="checkbox"/>
f) Conflict with the provisions of an adopted Habitat Conservation Plan, Natural Community Conservation Plan, or other approved local, regional, or state habitat conservation plan?	<input type="checkbox"/>	<input type="checkbox"/>	<input type="checkbox"/>	<input checked="" type="checkbox"/>

**Discussion:**

This area is currently an active youth camp surrounded by agriculture, and due to the nature of its' activity, no known biological habitat is adversely affected.

**Mitigation:**

None required.

	Potentially Significant Impact	Less Than Significant With Mitigation Included	Less Than Significant Impact	No Impact
<b>V. CULTURAL RESOURCES --</b> Would the project:				
a) Cause a substantial adverse change in the significance of a historical resource as defined in $\alpha$ 15064.5?	<input type="checkbox"/>	<input type="checkbox"/>	<input type="checkbox"/>	<input checked="" type="checkbox"/>
b) Cause a substantial adverse change in the significance of an archaeological resource pursuant to $\alpha$ 15064.5?	<input type="checkbox"/>	<input type="checkbox"/>	<input type="checkbox"/>	<input checked="" type="checkbox"/>
c) Directly or indirectly destroy a unique paleontological resource or site or unique geologic feature?	<input type="checkbox"/>	<input type="checkbox"/>	<input type="checkbox"/>	<input checked="" type="checkbox"/>
d) Disturb any human remains, including those interred outside of formal cemeteries?	<input type="checkbox"/>	<input type="checkbox"/>	<input type="checkbox"/>	<input checked="" type="checkbox"/>

**DISCUSSION:**

Construction of a new restroom at this site would not, in itself, alter or destroy any known prehistoric or historic archaeological site, building, structure or object, affect unique ethnic cultural values or restrict religious or sacred uses. The design of this structure will be such that it will blend in with the other structures.

Existing historical structures in close proximity ( portions of the Historic Gold Dredge Camp ) will be fenced off at this time for their protection, until proper disposition and determination can be made for the feasibility of restoration or replication

**MITIGATION:**

None required,

Potentially Significant Impact	Less Than Significant With Mitigation Included	Less Than Significant Impact	No Impact
--------------------------------------	--	------------------------------------	--------------

**VI. GEOLOGY AND SOILS -- Would the project:**

a) Expose people or structures to potential substantial adverse effects, including the risk of loss, injury, or death involving:

i) Rupture of a known earthquake fault, as delineated on the most recent Alquist-Priolo Earthquake Fault Zoning Map issued by the State Geologist for the area or based on other substantial evidence of a known fault? Refer to Division of Mines and Geology Special Publication 42.

<input type="checkbox"/>	<input type="checkbox"/>	<input type="checkbox"/>	<input checked="" type="checkbox"/>
--------------------------	--------------------------	--------------------------	-------------------------------------

ii) Strong seismic ground shaking?

<input type="checkbox"/>	<input type="checkbox"/>	<input type="checkbox"/>	<input checked="" type="checkbox"/>
--------------------------	--------------------------	--------------------------	-------------------------------------

iii) Seismic-related ground failure, including liquefaction?

<input type="checkbox"/>	<input type="checkbox"/>	<input type="checkbox"/>	<input checked="" type="checkbox"/>
--------------------------	--------------------------	--------------------------	-------------------------------------

iv) Landslides?

<input type="checkbox"/>	<input type="checkbox"/>	<input type="checkbox"/>	<input checked="" type="checkbox"/>
--------------------------	--------------------------	--------------------------	-------------------------------------

b) Result in substantial soil erosion or the loss of topsoil?

<input type="checkbox"/>	<input type="checkbox"/>	<input type="checkbox"/>	<input checked="" type="checkbox"/>
--------------------------	--------------------------	--------------------------	-------------------------------------

c) Be located on a geologic unit or soil that is unstable, or that would become unstable as a result of the project, and potentially result in on- or off-site landslide, lateral spreading, subsidence, liquefaction or collapse?

<input type="checkbox"/>	<input type="checkbox"/>	<input type="checkbox"/>	<input checked="" type="checkbox"/>
--------------------------	--------------------------	--------------------------	-------------------------------------

d) Be located on expansive soil, as defined in Table 18-1-B of the Uniform Building Code (1994), creating substantial risks to life or property?

<input type="checkbox"/>	<input type="checkbox"/>	<input type="checkbox"/>	<input checked="" type="checkbox"/>
--------------------------	--------------------------	--------------------------	-------------------------------------

e) Have soils incapable of adequately supporting the use of septic tanks or alternative waste water disposal systems where sewers are not available for the disposal of waste water?

<input type="checkbox"/>	<input type="checkbox"/>	<input type="checkbox"/>	<input checked="" type="checkbox"/>
--------------------------	--------------------------	--------------------------	-------------------------------------

**DISCUSSION:**

This project will not result in any direct impacts to geology and soils. There will be no modification to any water course, which could result in changes in siltation, deposition or erosion. Unstable geologic conditions, changes in geologic substructures, changes to unique geologic or physical features will not occur as a result of this project.

**MITIGATION:**

None Required

	Potentially Significant Impact	Less Than Significant With Mitigation Included	Less Than Significant Impact	No Impact
<b>VII. HAZARDS AND HAZARDOUS MATERIALS -- Would the project:</b>				
a) Create a significant hazard to the public or the environment through the routine transport, use, or disposal of hazardous materials?	<input type="checkbox"/>	<input type="checkbox"/>	<input type="checkbox"/>	<input checked="" type="checkbox"/>
b) Create a significant hazard to the public or the environment through reasonably foreseeable upset and accident conditions involving the release of hazardous materials into the environment?	<input type="checkbox"/>	<input type="checkbox"/>	<input type="checkbox"/>	<input checked="" type="checkbox"/>
c) Emit hazardous emissions or handle hazardous or acutely hazardous materials, substances, or waste within one-quarter mile of an existing or proposed school?	<input type="checkbox"/>	<input type="checkbox"/>	<input type="checkbox"/>	<input checked="" type="checkbox"/>
d) Be located on a site which is included on a list of hazardous materials sites compiled pursuant to Government Code Section 65962.5 and, as a result, would it create a significant hazard to the public or the environment?	<input type="checkbox"/>	<input type="checkbox"/>	<input type="checkbox"/>	<input checked="" type="checkbox"/>
e) For a project located within an airport land use plan or, where such a plan has not been adopted, within two miles of a public airport or public use airport, would the project result in a safety hazard for people residing or working in the project area?	<input type="checkbox"/>	<input type="checkbox"/>	<input type="checkbox"/>	<input checked="" type="checkbox"/>
f) For a project within the vicinity of a private airstrip, would the project result in a safety hazard for people residing or working in the project area?	<input type="checkbox"/>	<input type="checkbox"/>	<input type="checkbox"/>	<input checked="" type="checkbox"/>
g) Impair implementation of or physically interfere with an adopted emergency response plan or emergency evacuation plan?	<input type="checkbox"/>	<input type="checkbox"/>	<input type="checkbox"/>	<input checked="" type="checkbox"/>
h) Expose people or structures to a significant risk of loss, injury or death involving wildland fires, including where wildlands are adjacent to urbanized areas or where residences are intermixed with wildlands?	<input type="checkbox"/>	<input type="checkbox"/>	<input type="checkbox"/>	<input checked="" type="checkbox"/>

**DISCUSSION:**

Development of the project site will not substantially increase any risk to the public or interfere with an emergency response plan.

**MITIGATION:**

None Required

	Potentially Significant Impact	Less Than Significant With Mitigation Included	Less Than Significant Impact	No Impact
<b>VIII. HYDROLOGY AND WATER QUALITY -- Would the project:</b>				
a) Violate any water quality standards or waste discharge requirements?	<input type="checkbox"/>	<input type="checkbox"/>	<input type="checkbox"/>	<input checked="" type="checkbox"/>
b) Substantially deplete groundwater supplies or interfere substantially with groundwater recharge such that there would be a net deficit in aquifer volume or a lowering of the local groundwater table level (e.g., the production rate of pre-existing nearby wells would drop to a level which would not support existing land uses or planned uses for which permits have been granted)?	<input type="checkbox"/>	<input type="checkbox"/>	<input type="checkbox"/>	<input checked="" type="checkbox"/>
c) Substantially alter the existing drainage pattern of the site or area, including through the alteration of the course of a stream or river, in a manner which would result in substantial erosion or siltation on- or off-site?	<input type="checkbox"/>	<input type="checkbox"/>	<input type="checkbox"/>	<input checked="" type="checkbox"/>
d) Substantially alter the existing drainage pattern of the site or area, including through the alteration of the course of a stream or river, or substantially increase the rate or amount of surface runoff in a manner which would result in flooding on- or off-site?	<input type="checkbox"/>	<input type="checkbox"/>	<input type="checkbox"/>	<input checked="" type="checkbox"/>
e) Create or contribute runoff water which would exceed the capacity of existing or planned storm water drainage systems or provide substantial additional sources of polluted runoff?	<input type="checkbox"/>	<input type="checkbox"/>	<input type="checkbox"/>	<input checked="" type="checkbox"/>
f) Otherwise substantially degrade water quality?	<input type="checkbox"/>	<input type="checkbox"/>	<input type="checkbox"/>	<input checked="" type="checkbox"/>
g) Place housing within a 100-year flood hazard area as mapped on a federal Flood Hazard Boundary or Flood Insurance Rate Map or other flood hazard delineation map?	<input type="checkbox"/>	<input type="checkbox"/>	<input type="checkbox"/>	<input checked="" type="checkbox"/>
h) Place within a 100-year flood hazard area structures which would impede or redirect flood flows?	<input type="checkbox"/>	<input type="checkbox"/>	<input type="checkbox"/>	<input checked="" type="checkbox"/>
i) Expose people or structures to a significant risk of loss, injury or death involving flooding, including flooding as a result of the failure of a levee or dam?	<input type="checkbox"/>	<input type="checkbox"/>	<input type="checkbox"/>	<input checked="" type="checkbox"/>
j) Inundation by seiche, tsunami, or mudflow?	<input type="checkbox"/>	<input type="checkbox"/>	<input type="checkbox"/>	<input checked="" type="checkbox"/>

**DISCUSSION:**

This project will not result in changes in the amount of surface water in any water body, changes in currents or the course or direction of water movements, alterations in the direction or flow of groundwater. Furthermore the proposed project will not result in a change in the quality of groundwater, or the amount of groundwater available for public water supplies.

Potentially Significant Impact	Less Than Significant With Mitigation Included	Less Than Significant Impact	No Impact
--------------------------------------	--	------------------------------------	--------------

**MITIGATION:**  
None Required.

**IX. LAND USE AND PLANNING - Would the project:**

- |   |                          |                          |                          |                                     |
|---|--------------------------|--------------------------|--------------------------|-------------------------------------|
| a) Physically divide an established community?  | <input type="checkbox"/> | <input type="checkbox"/> | <input type="checkbox"/> | <input checked="" type="checkbox"/> |
| b) Conflict with any applicable land use plan, policy, or regulation of an agency with jurisdiction over the project (including, but not limited to the general plan, specific plan, local coastal program, or zoning ordinance) adopted for the purpose of avoiding or mitigating an environmental effect? | <input type="checkbox"/> | <input type="checkbox"/> | <input type="checkbox"/> | <input checked="" type="checkbox"/> |
| c) Conflict with any applicable habitat conservation plan or natural community conservation plan?   | <input type="checkbox"/> | <input type="checkbox"/> | <input type="checkbox"/> | <input checked="" type="checkbox"/> |

**Discussion:**  
This project will not result in any direct land use changes..

The project site is currently zoned Historic, and this zoning will remain in effect. Recreational uses and adjacent agricultural uses have been compatible in the past. This proposal will not impact any established community or prevent housing construction activity due to its' physical arrangement.

**Mitigation:**  
None required

	Potentially Significant Impact	Less Than Significant With Mitigation Included	Less Than Significant Impact	No Impact
<b>X. MINERAL RESOURCES --</b> Would the project:				
a) Result in the loss of availability of a known mineral resource that would be of value to the region and the residents of the state?	<input type="checkbox"/>	<input type="checkbox"/>	<input type="checkbox"/>	<input checked="" type="checkbox"/>
b) Result in the loss of availability of a locally-important mineral resource recovery site delineated on a local general plan, specific plan or other land use plan?	<input type="checkbox"/>	<input type="checkbox"/>	<input type="checkbox"/>	<input checked="" type="checkbox"/>

**Discussion:**

Development of the subject site will not result in the loss of any known mineral resource.

**Mitigation:**

None required

	Potentially Significant Impact	Less Than Significant With Mitigation Included	Less Than Significant Impact	No Impact
<b>XI. NOISE --</b> Would the project result in:				
a) Exposure of persons to or generation of noise levels in excess of standards established in the local general plan or noise ordinance, or applicable standards of other agencies?	<input type="checkbox"/>	<input type="checkbox"/>	<input type="checkbox"/>	<input checked="" type="checkbox"/>
b) Exposure of persons to or generation of excessive ground borne vibration or ground borne noise levels?	<input type="checkbox"/>	<input type="checkbox"/>	<input type="checkbox"/>	<input checked="" type="checkbox"/>
c) A substantial permanent increase in ambient noise levels in the project vicinity above levels existing without the project?	<input type="checkbox"/>	<input type="checkbox"/>	<input type="checkbox"/>	<input checked="" type="checkbox"/>
d) A substantial temporary or periodic increase in ambient noise levels in the project vicinity above levels existing without the project?	<input type="checkbox"/>	<input type="checkbox"/>	<input type="checkbox"/>	<input checked="" type="checkbox"/>
e) For a project located within an airport land use plan or, where such a plan has not been adopted, within two miles of a public airport or public use airport, would the project expose people residing or working in the project area to excessive noise levels?	<input type="checkbox"/>	<input type="checkbox"/>	<input type="checkbox"/>	<input checked="" type="checkbox"/>
f) For a project within the vicinity of a private airstrip, would the project expose people residing or working in the project area to excessive noise levels?	<input type="checkbox"/>	<input type="checkbox"/>	<input type="checkbox"/>	<input checked="" type="checkbox"/>

**DISCUSSION:**

This project will not result in any direct impacts to ambient noise levels.

**MITIGATION:**

None required



	Potentially Significant Impact	Less Than Significant With Mitigation Included	Less Than Significant Impact	No Impact
<b>XII. POPULATION AND HOUSING -- Would the project:</b>				
a) Induce substantial population growth in an area, either directly (for example, by proposing new homes and businesses) or indirectly (for example, through extension of roads or other infrastructure)?	<input type="checkbox"/>	<input type="checkbox"/>	<input type="checkbox"/>	<input checked="" type="checkbox"/>
b) Displace substantial numbers of existing housing, necessitating the construction of replacement housing elsewhere?	<input type="checkbox"/>	<input type="checkbox"/>	<input type="checkbox"/>	<input checked="" type="checkbox"/>
c) Displace substantial numbers of people, necessitating the construction of replacement housing elsewhere?	<input type="checkbox"/>	<input type="checkbox"/>	<input type="checkbox"/>	<input checked="" type="checkbox"/>

**Discussion:**

This project will not generate the need for new housing or induce growth directly, or indirectly, in Stanislaus County.

**Mitigation:**

None required

	Potentially Significant Impact	Less Than Significant With Mitigation Included	Less Than Significant Impact	No Impact
<b>XIII. PUBLIC SERVICES</b>				
a) Would the project result in substantial adverse physical impacts associated with the provision of new or physically altered governmental facilities, need for new or physically altered governmental facilities, the construction of which could cause significant environmental impacts, in order to maintain acceptable service ratios, response times or other performance objectives for any of the public services:				
Fire protection?	<input type="checkbox"/>	<input type="checkbox"/>	<input checked="" type="checkbox"/>	<input type="checkbox"/>
Police protection?	<input type="checkbox"/>	<input type="checkbox"/>	<input type="checkbox"/>	<input checked="" type="checkbox"/>
Schools?	<input type="checkbox"/>	<input type="checkbox"/>	<input type="checkbox"/>	<input checked="" type="checkbox"/>
Parks?	<input type="checkbox"/>	<input type="checkbox"/>	<input type="checkbox"/>	<input checked="" type="checkbox"/>
Other public facilities?	<input type="checkbox"/>	<input type="checkbox"/>	<input type="checkbox"/>	<input checked="" type="checkbox"/>

**DISCUSSION:**

This project will not result in any direct impacts to public services. Once the site is developed the following services could be affected:

**Fire Protection:**

There could be an increased potential for fire with this project.

**Police Protection:**

The Sheriff's Department currently is responsible for law enforcement in the County Parks, and corresponding calls are anticipated to have a less than significant impact.

**MITIGATION:**

None required

	Potentially Significant Impact	Less Than Significant With Mitigation Included	Less Than Significant Impact	No Impact
<b>XIV. RECREATION --</b>				
a) Would the project increase the use of existing neighborhood and regional parks or other recreational facilities such that substantial physical deterioration of the facility would occur or be accelerated?	<input type="checkbox"/>	<input type="checkbox"/>	<input type="checkbox"/>	<input checked="" type="checkbox"/>
b) Does the project include recreational facilities or require the construction or expansion of recreational facilities which might have an adverse physical effect on the environment?	<input type="checkbox"/>	<input type="checkbox"/>	<input type="checkbox"/>	<input checked="" type="checkbox"/>

**DISCUSSION:**

This project has no known adverse impact on the quality or quantity of existing recreational opportunities. In fact, the building of the restroom will have a positive affect on the quality and quantity of recreation opportunities

**MITIGATION:**

None required

	Potentially Significant Impact	Less Than Significant With Mitigation Included	Less Than Significant Impact	No Impact
<b>XV. TRANSPORTATION/TRAFFIC -- Would the project:</b>				
a) Cause an increase in traffic which is substantial in relation to the existing traffic load and capacity of the street system (i.e., result in a substantial increase in either the number of vehicle trips, the volume to capacity ratio on roads, or congestion at intersections)?	<input type="checkbox"/>	<input type="checkbox"/>	<input type="checkbox"/>	<input checked="" type="checkbox"/>
b) Exceed, either individually or cumulatively, a level of service standard established by the county congestion management agency for designated roads or highways?	<input type="checkbox"/>	<input type="checkbox"/>	<input type="checkbox"/>	<input checked="" type="checkbox"/>
c) Result in a change in air traffic patterns, including either an increase in traffic levels or a change in location that results in substantial safety risks?	<input type="checkbox"/>	<input type="checkbox"/>	<input type="checkbox"/>	<input checked="" type="checkbox"/>
d) Substantially increase hazards due to a design feature (e.g., sharp curves or dangerous intersections) or incompatible uses (e.g., farm equipment)?	<input type="checkbox"/>	<input type="checkbox"/>	<input type="checkbox"/>	<input checked="" type="checkbox"/>
e) Result in inadequate emergency access ?	<input type="checkbox"/>	<input type="checkbox"/>	<input type="checkbox"/>	<input checked="" type="checkbox"/>
f) Result in inadequate parking capacity ?	<input type="checkbox"/>	<input type="checkbox"/>	<input type="checkbox"/>	<input checked="" type="checkbox"/>
g) Conflict with adopted policies, plans, or programs supporting alternative transportation (e.g., bus turnouts, bicycle racks)?	<input type="checkbox"/>	<input type="checkbox"/>	<input type="checkbox"/>	<input checked="" type="checkbox"/>

**DISCUSSION:**

This project will not result in any direct traffic impacts. Eventual operation as a park amenity will increase visitation to the site.

There will be no alteration to waterborne, rail, or air traffic.

**MITIGATION:**

None Required

	Potentially Significant Impact	Less Than Significant With Mitigation Included	Less Than Significant Impact	No Impact
<b>XVI. UTILITIES AND SERVICE SYSTEMS --</b>				
Would the project:				
a) Exceed wastewater treatment requirements of the applicable Regional Water Quality Control Board?	<input type="checkbox"/>	<input type="checkbox"/>	<input type="checkbox"/>	<input checked="" type="checkbox"/>
b) Require or result in the construction of new water or wastewater treatment facilities or expansion of existing facilities, the construction of which could cause significant environmental effects?	<input type="checkbox"/>	<input type="checkbox"/>	<input type="checkbox"/>	<input checked="" type="checkbox"/>
c) Require or result in the construction of new storm water drainage facilities or expansion of existing facilities, the construction of which could cause significant environmental effects?	<input type="checkbox"/>	<input type="checkbox"/>	<input type="checkbox"/>	<input checked="" type="checkbox"/>
d) Have sufficient water supplies available to serve the project from existing entitlements and resources, or are new or expanded entitlements needed?	<input type="checkbox"/>	<input type="checkbox"/>	<input type="checkbox"/>	<input checked="" type="checkbox"/>
e) Result in a determination by the wastewater treatment provider which serves or may serve the project that it has adequate capacity to serve the project's projected demand in addition to the provider's existing commitments?	<input type="checkbox"/>	<input type="checkbox"/>	<input type="checkbox"/>	<input checked="" type="checkbox"/>
f) Be served by a landfill with sufficient permitted capacity to accommodate the project's solid waste disposal needs?	<input type="checkbox"/>	<input type="checkbox"/>	<input type="checkbox"/>	<input checked="" type="checkbox"/>
g) Comply with federal, state, and local statutes and regulations related to solid waste?	<input type="checkbox"/>	<input type="checkbox"/>	<input checked="" type="checkbox"/>	<input type="checkbox"/>

**DISCUSSION:**

This project will not result in direct impacts to utility & service systems.

**MITIGATION:**

None required

	Potentially Significant Impact	Less Than Significant With Mitigation Included	Less Than Significant Impact	No Impact
<b>XVII. MANDATORY FINDINGS OF SIGNIFICANCE --</b>				
a) Does the project have the potential to degrade the quality of the environment, substantially reduce the habitat of a fish or wildlife species, cause a fish or wildlife population to drop below self-sustaining levels, threaten to eliminate a plant or animal community, reduce the number or restrict the range of a rare or endangered plant or animal or eliminate important examples of the major periods of California history or prehistory?	<input type="checkbox"/>	<input type="checkbox"/>	<input checked="" type="checkbox"/>	<input type="checkbox"/>
b) Does the project have impacts that are individually limited, but cumulatively considerable? ("Cumulatively considerable" means that the incremental effects of a project are considerable when viewed in connection with the effects of past projects, the effects of other current projects, and the effects of probable future projects)?	<input type="checkbox"/>	<input type="checkbox"/>	<input type="checkbox"/>	<input checked="" type="checkbox"/>
c) Does the project have environmental effects which will cause substantial adverse effects on human beings, either directly or indirectly?	<input type="checkbox"/>	<input type="checkbox"/>	<input type="checkbox"/>	<input checked="" type="checkbox"/>

# KIWANIS YOUTH CAMP

- 1 Main Entrance
- 2 Kiwanis Youth Camp Sign
- 3 Flag Pole
- 4 Drinking Fountain
- 5 Ball Field
- 6 Rest Rooms
- 7 Pit Toilets
- 8 Pump
- 9 Water Well
- 10 Picnic Barn
- 11 Barbeque
- 12 Parking Area
- 13 Amphitheater
- 14 Walk through Gate
- 15 Main Power Switch
- 16 Switch Control Panel

☒ HISTORIC BLDGS

## SITE PLAN

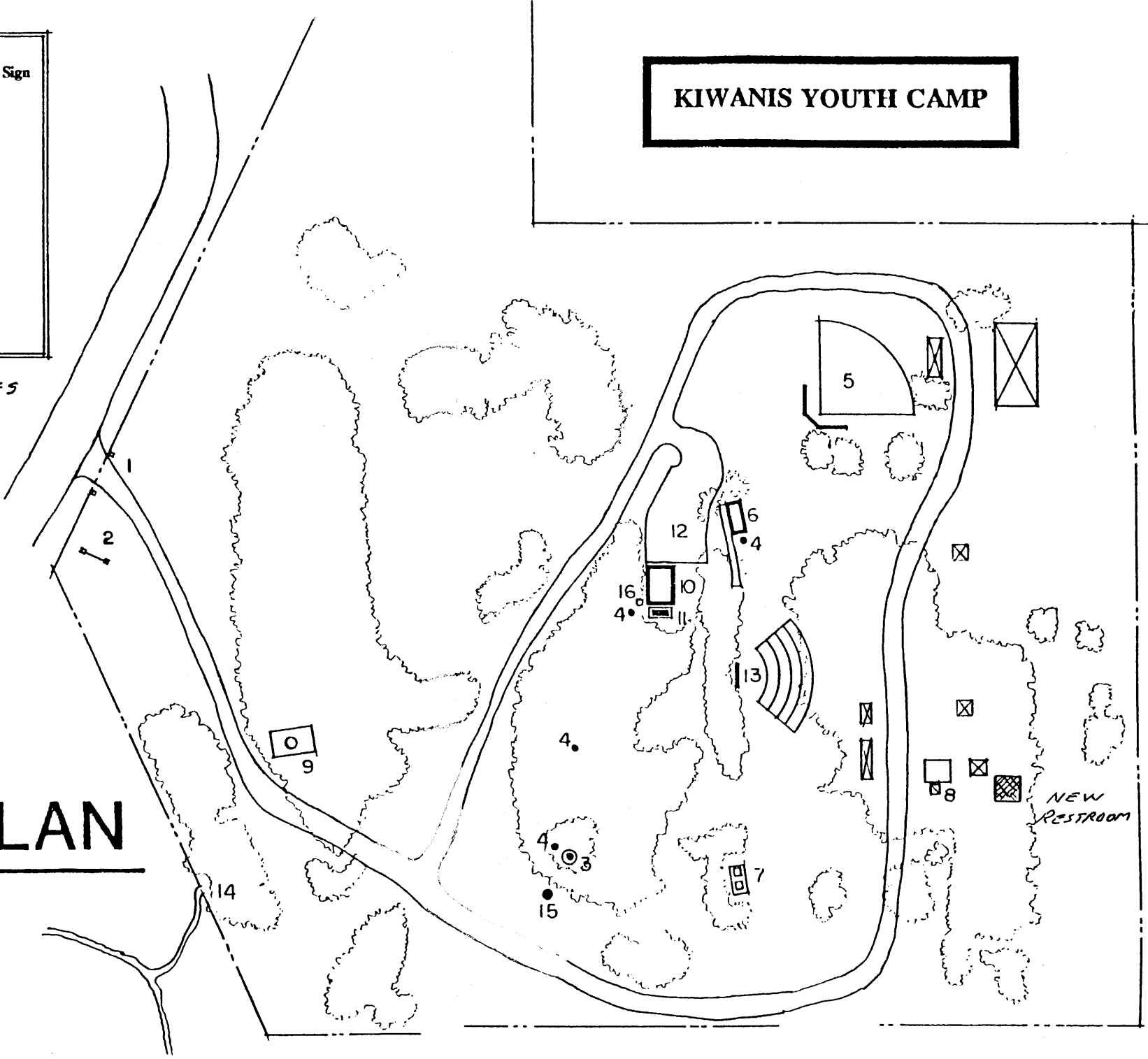

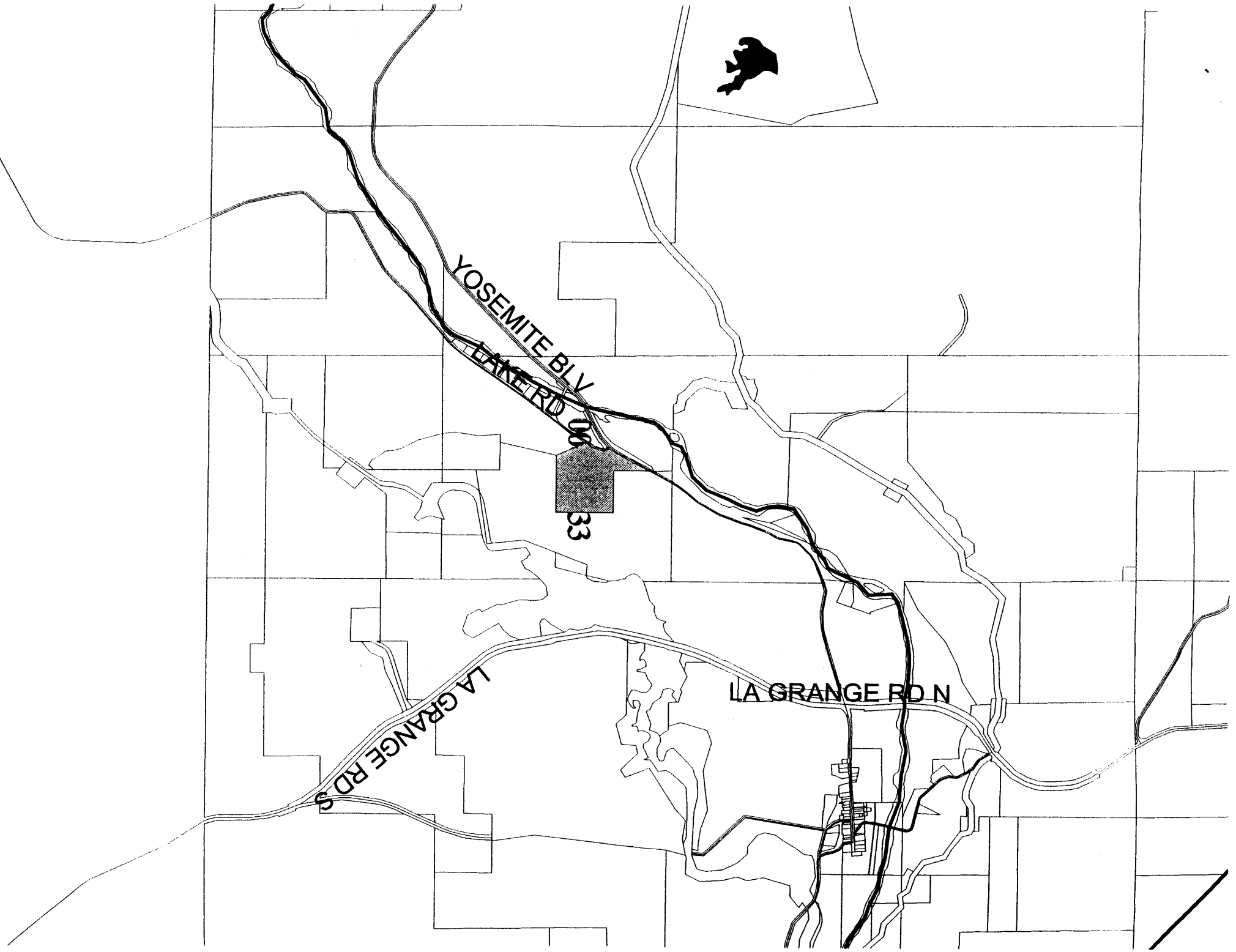

YOSEMITE BLV  
LAKERD

33

LA GRANGE RD S

LA GRANGE RD N



## **NEGATIVE DECLARATION**

**NAME OF PROJECT:**                    **KIWANIS YOUTH CAMP RESTROOM**

**LOCATION OF PROJECT:**            **STANISLAUS COUNTY, CALIFORNIA**

**PROJECT DEVELOPER:**            **STANISLAUS COUNTY PARKS AND RECREATION  
DEPARTMENT**

**DESCRIPTION OF PROJECT:**

To construct a new restroom to service small youth groups at the upper level of the Kiwanis Youth Camp.

Based upon the Initial Study, dated January. 16, 2001, the Environmental Coordinator finds as follows:

1.     This project does not have the potential to degrade the quality of the environment, nor to curtail the diversity of the environment.
2.     This project will not have a detrimental effect upon either short-term or long-term environmental goals.
3.     This project will not have impacts which are individually limited but cumulatively considerable.
4.     This project will not have environmental impacts which will cause substantial adverse effects upon human beings, either directly or indirectly.

The Initial Study and other environmental documents are available for public review at the Department of Parks and Recreation, 3800 Cornucopia Way, Modesto, California , and Planning and Community Development, 1010 10th Street, Modesto, California.

Initial Study prepared by: Marty Johnson

Submit comments to:     Steve Brodie  
   Stanislaus County Parks Department  
   3800 Cornucopia Way, Suite C  
   Modesto, California 95358  
   (209) 525-6768

**Parcel Information Report --- Custom Option**

✓ K2262 UNMI

APN: 008-18-33

OWNERS NAME: STANISLAUS COUNTY OF

SITE or STREET ADDRESS: Yosemite Blvd  
La Grange, CA

MAILING ADDRESS: Yosemite Blvd  
La Grange, CA

ASSEMBLY DISTRICT: 25

BUILDING INSPECTION AREA: 5

CDF-SRA AREAS: INSIDE SRA

CENSUS BLOCK GROUP 1990: 1

CENSUS TRACT 1990: 29.01

COMMUNITY SERVICE DISTRICT: Not Within

DISPOSAL DISTRICT: MODESTO DISPOSAL

ELEMENTARY SCHOOL DISTRICT: LA GRANGE ELEMENTARY

FEMA ZONE: IN 100 YEAR ZONE

FEMA PANAL: 0603840400A

FIRE DISTRICT: STANISLAUS CONSOLIDATED FIRE

HIGH SCHOOL DISTRICT: HUGHSON UNIFIED

HOSPITAL DISTRICT: NONE

JURISDICTION: COUNTY

LIGHTING DISTRICT: NOT WITHIN

MOSQUITO ABATEMENT DISTRICT: TURLOCK MOSQUITO

MUNICIPAL ADVISORY COUNCIL: NOT WITHIN

NEWMAN DRAINAGE DISTRICT: NOT WITHIN

ORESTIMBA FLOOD CONTROL DISTRICT: NOT WITHIN

REDEVELOPMENT SUB-AREAS: NOT WITHIN

ROAD MAINTENACE AREA: 2 - Bob Fairbank

SANITARY DISTRICT: NOT WITHIN

SPHERE OF INFLUENCE: NONE

STORM DRAINAGE DISTRICT: NOT WITHIN

SUPERVISORIAL DISTRICT: DISTRICT 2

SUPERVISOR: THOMAS MAYFIELD

WATERLINE IMPROVEMENT AREA: NOT WITHIN

YOSEMITE COMMUNITY COLEGE DISTRICT: AREA 3

ZONING DESIGNATION (County): H-S

*\* Ownership and mailing address information subject to verification until further notice.  
\* For questions/comments please contact the Public Works GIS Division.  
Parcel Information as Per Metroscan 3/11/99 12:17:24 AM*

## NOTICE OF NEGATIVE DECLARATION

**MEMO TO:** Stanislaus County Clerk/Recorder  
**FROM:** Stanislaus County Parks and Recreation Dept.  
**SUBJECT:** Filing of Notice of Negative Declaration  
**NAME OF PROJECT:** KIWANIS YOUTH CAMP RESTROOM  
**LOCATION OF PROJECT:** Kiwanis Youth Camp, La Grange, Ca.  
**APPROVING AGENCY:** Stanislaus County Parks and Recreation Dept.

**DESCRIPTION OF PROJECT:**

We propose to construct a new restroom to service small youth groups at the upper level of the Kiwanis Youth Camp.

Based upon the Initial Study, dated January. 16, 2001, the Environmental Coordinator finds as follows:

1. This project does not have the potential to degrade the quality of the environment, nor to curtail the diversity of the environment.
2. This project will not have a detrimental effect upon either short-term or long-term environmental goals.
3. This project will not have impacts which are individually limited but cumulatively considerable.
4. This project will not have environmental impacts which will cause substantial adverse effects upon human beings, either directly or indirectly.

The Initial Study and other environmental documents are available for public review at the Department of Parks and Recreation, 3800 Cornucopia Way, Modesto, California , and Planning and Community Development, 1010 10th Street, Modesto, California.

Lead Agency Contact Person: Steve Brodie Steve Brodie (209) 525-6768

Date Received for Filing: \_\_\_\_\_

Title: \_\_\_\_\_

THE BOARD OF SUPERVISORS OF THE COUNTY OF STANISLAUS  
STATE OF CALIFORNIA

Date January 4, 1981

No. 83-26

On motion of Supervisor Starn . Seconded by Supervisor Cannella  
 and approved by the following vote.  
 Ayes: Supervisors Starn, Blom, Cannella and Chairman Terry  
 Noes: Supervisors None  
 Excused or Abser.. Supervisors: Simon  
 Abstaining Supervisor: None

THE FOLLOWING RESOLUTION WAS ADOPTED:

IN RE: APPROVING PROPOSED PLAN FOR KIWANIS YOUTH CAMP -  
LA GRANGE PARK

WHEREAS, a proposal has been brought before this Board for development of a Kiwanis Youth Camp Area at the La Grange Park to be located on a parcel of park land near the dredge camp at Lake Road and Highway 132; and

WHEREAS, the Kiwanis Club of Greater Modesto plan to finance the project 100%, provide the manpower for construction, and be responsible for on going maintenance of the facilities; and

WHEREAS, any organized youth group may use the camp on a reservation basis, limiting usage to one group at a time and this Board finds that many youth groups are already interested in using said camp; and

WHEREAS, this proposed plan has been brought before the Parks Commission and they are supporting the proposed plan,

NOW, THEREFORE, BE IT RESOLVED that the proposed plan for the Kiwanis Youth Camp Area at the La Grange Park be, and hereby is, approved.

ATTEST LLOYD R BROUILLARD Clerk,  
Stanislaus County Board of Supervisors,  
State of California.

*Kathleen Simon*



# PARKS & FACILITIES

A-9  
28

1716 MICHIGAN ROAD

MODesto, CALIFORNIA 95351

Phone (209) 575-6339 Parks & Grounds Division  
575-6340 Building Maintenance Division  
575-6413 Custodian Division

December 27, 1982

To: Gardner Hutchins, CAO  
From: Bill Tiernan, Parks & Facilities Director  
Subject: Kiwanis Club representatives request  
permission to appear before the Board of Supervisors

Mr Paul Korte came before the Parks Commission on August 19, 1982 to propose a youth camp area at La Grange Park. The Parks Commissions' action and a copy of the proposed plan is attached.

Mr. Korte, Mr. Jones and Mr. Kumbler from the Kiwanis Club would like to be placed on the agenda to present the proposal to the Board of Supervisors on January 4, 1983.

When you determine a time for this item on the agenda, if you will let me know I will notify the Kiwanis Club's representatives.

If you need additional information about this project, I will be glad to make it available to you.

Attachments



# PARKS & FACILITIES

THE MORGAN ROAD

MODESTO, CALIFORNIA 95301

Phone (209) 525-6339 Parks & Grounds Division  
525-6340 Building Maintenance Division  
525-6413 Custodian Division

28

September 3, 1982

To: Board of Supervisors  
From: Parks Commission  
Subject: Support for the Kiwanis Club Youth Camp at La Grange Park

Mr. Paul Korte, President of Kiwanis Club of Greater Modesto, appeared before the Parks Commission on August 19, 1982 with a proposal to develop a kiwanis Youth Camp Area at the La Grange Park. The development would be located on a parcel of park land near the dredge camp at Lake Road and Highway 132.

After listening to Mr. Korte on their plan to 100% finance the project, provide the manpower for construction, and be responsible for on going maintenance of the facilities, the Parks Commission took the following action:

Moved by Commissioner Ruddy, the Commission supported the proposed plan and forwarded that action on to the Board of Supervisors, seconded by Commissioner Speckens, unanimously approved.

28

PROPOSED PLAN  
FOR  
KIWANIS YOUTH CAMP  
OF  
STANISLAUS COUNTY

FINANCING - The Kiwanis Club of Greater Modesto (KCGM) plan to finance the cost of all improvements and provide the manpower for installation.

\$5,000.00 has been appropriated from the 1981-82 budget and \$5,000.00 will be available in 1982-83 and each subsequent year until complete.

All maintenance will be provided by KCGM.

MANPOWER - KCGM has 60 members and sponsors a high school boys club with 20 members.

The Boy Scouts have volunteered additional man/boy power.

We will also request work crews from the youth authority and the adult honor farm.

USAGE - We propose to let any organized youth group use the camp on a reservation basis, limiting usage to one group at a time. Youth groups already interested in using the camp include:

- Boy Scouts
- Girl Scouts
- YMCA Indian Guides
- YMCA Indian Princesses
- Church Youth Groups
- Red Shield Center

Reservations would be made through the county parks office.

A responsible member of the group would pick up the key to gate and an instruction sheet including a map depicting areas not to trespass.

PLANNED FACILITIES:

Phase 1 - Clear grass from tent and cooking area  
Install Sign  
Install Pit toilets  
Install Flag Pole

Phase 2 - Construct Storage Shed

Phase 3 - Construct Covered Craft and Eating Area

Phase 4 - Level and plant Play Field

Phase 5 - Install Well



# KIWANIS YOUTH CAMP

28

PLAY  
FIELD

EXISTING  
BUILDINGS

PIT  
TOILETS

STORAGE  
SHED  
TENT SITES  
COVERED CRAFT  
AREA  
FLAG  
POLE

STEEL  
GATE

SIGN

TO  
CAMP

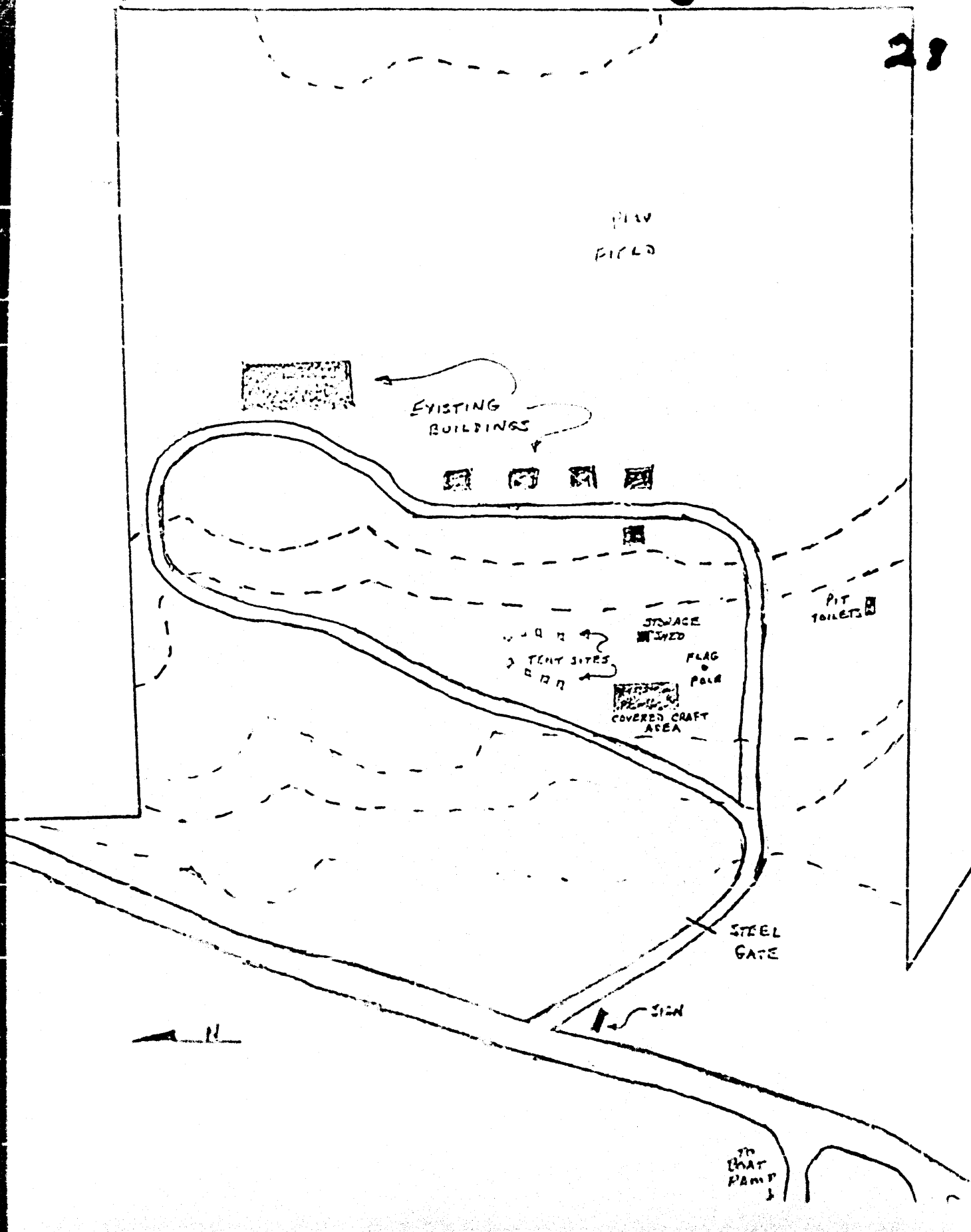

THE BOARD OF SUPERVISORS OF THE COUNTY OF STANISLAUS  
STATE OF CALIFORNIA

27

Date: June 5, 1990 No. 90-833

On motion of Supervisor Simon, Seconded by Supervisor Paul  
and approved by the following vote,  
Ayes: Supervisors: Paul, Starn, Simon, Mattos and Chairman Blom  
Noes: Supervisors: None  
Excused or Absent: Supervisors: None  
Abstaining: Supervisor: None

\*B-10

THE FOLLOWING RESOLUTION WAS ADOPTED:

IN RE: KIWANIS YOUTH CAMP IMPROVEMENTS - PARKS

WHEREAS, January 4, 1983, this Board approved the development of a youth camp on County park property near La Grange and the Stanislaus County Park Commission unanimously supported the development of said youth camp and the Kiwanis Club have at their own expense made improvements to the camp to benefit the youth of Stanislaus County; and

WHEREAS, the youth camp has been in existence for six years, during which time, thousands of young people have enjoyed the camp; and

WHEREAS, the Kiwanis Club has submitted a new five year development plan as shown in Exhibit A as attached hereto and by reference made a part hereof which includes, among other improvements, the construction of permanent restrooms; and

WHEREAS, the Kiwanis Club will construct and maintain the improvements at their own expense,

NOW, THEREFORE, BE IT RESOLVED that the Kiwanis Club be, and hereby is, approved to make additional improvements at the Kiwanis Youth Camp, located on County park property near La Grange.

ATTEST: CLAUDIA LEONG, Clerk  
Stanislaus County Board of Supervisors,  
State of California.

*Patricia A. Minton*  
By: PATRICIA A. MINTON, Assistant Clerk

EXHIBIT A.



*Kiwanis Club of Greater Modesto*

Meets Tuesday, 12:10, Carmen's  
MODESTO, CALIFORNIA

May 24, 1990

Stanislaus County  
Board of Supervisors

In June 1983 the Kiwanis Club of Greater Modesto embarked on a major project to develop an outdoor camping facility for the benefit of the youth of Stanislaus County. Our project is located on the 94 acres known as the La Grange Dredge Camp near the Basso Bridge. The Board of Supervisors in 1983 including Mr. Roland Starn and Mr. Ray Simon endorsed and encouraged our project by resolution.

We are proud to report to you that we are nearing the completion of the improvements listed on our original master plan. These improvements include the installation of the following:

- Installation of electrical and water service.
- Flag pole.
- Kiwanis Youth Camp sign at main gate.
- Drinking fountains.
- 8' Movie screen.
- Camp fire pits.
- Pit toilets.
- 3,264 sq. ft. Covered Pole Barn for craft and picnic area.
- 16 picnic tables.
- level and cover parking area with gravel.
- 8' large group bar-b-que.
- leveled ball field.

While these improvements have made the camp operational, we feel it is time to expand the original master plan. Our new five year plan includes the following improvements:

- Install emergency telephone service.
- Construct permanent rest room facilities. The existing pit toilets are difficult to maintain and do not provide for handicapped access. Plans for the proposed rest rooms accompany this letter for your review.
- Construction of Back-stop for ball field.
- Plant 40 - 50 new eucalyptus trees.
- Install new Kiwanis Youth Camp sign on hill side visible from the highway.
- Installation of Wildlife habitats and nature trails on the camp site and in the Domique wilderness area adjacent to the camp.
- Installation of vehicle control barriers.
- Continue to promote use of the camp through awareness programs with youth group leaders through out the County.
- Continued maintenance of existing improvements.

Kiwanis club is very proud of this project which has received national recognition. We are especially gratified by the appreciation express by youth group leaders from through the County. Thousands of young people have enjoyed the camp over the past six years.

We beseech you to embrace our project by resolution and authorize the necessary building permits for the new construction.

Yours Very Truly,



Michael Kumler  
Kiwanis Youth Camp Chairman 1989-90  
Kiwanis Club of Greater Modesto



Paul E. Korte  
Lt. Governor Elect 1991-92  
Kiwanis Division 46  
Member, Kiwanis Club of  
Greater Modesto

cc: Robert Gregory  
Director, Parks and Recreation

\*B-10  
Board 6/5/90

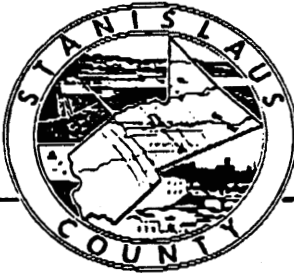

# PARKS & FACILITIES

1716 MORGAN ROAD

MODESTO, CALIFORNIA 95351

Phone (209) 525-4107 Parks & Grounds Division  
525-4108 Building Maintenance  
525-6413 Custodian Division

May 30, 1990

MEMO TO: Lamar Bartholomew  
Chief Administrative Officer

FROM: *W.R.G.*  
William R. Gregory  
Acting Director of Parks

SUBJECT: **KIWANIS YOUTH CAMP IMPROVEMENTS**

### RECOMMENDATIONS:

I recommend the Board of Supervisors approve the Kiwanis Club request to make additional improvement at the Kiwanis Youth Camp, located on County park property near La Grange.

### BACKGROUND:

The Board of Supervisors on January 4, 1983 by resolution approved the development of a youth camp on County park property near La Grange.

The Stanislaus County Park Commission, by letter to the Board of Supervisors, unanimously supported the development of this youth camp. The Kiwanis Club have at their own expense made improvements to the camp to benefit the youth of our County.

### DISCUSSION:

The youth camp has been in existence for six years, during which time, thousands of young people have enjoyed the camp. The Kiwanis Club has submitted a new five year development plan (see attached) which includes, among other improvements, the construction of permanent restrooms. The existing pit toilets are difficult to maintain and they do not provide handicap access.

### FISCAL IMPACT:

The Kiwanis Club will construct and maintain the improvements at their expense.

Memo to C.A.O.  
May 30, 1990  
Page 2

STAFFING IMPACT:

There will be no staff impact.

Attachments